



RCJO30-XL

Flanged housing unit

Schaeffler ID:
0009467020000

Housing units RCJO, four-bolt flanged housing units, cast iron, eccentric locking collar, series 63, R seals

X-life

Technical information

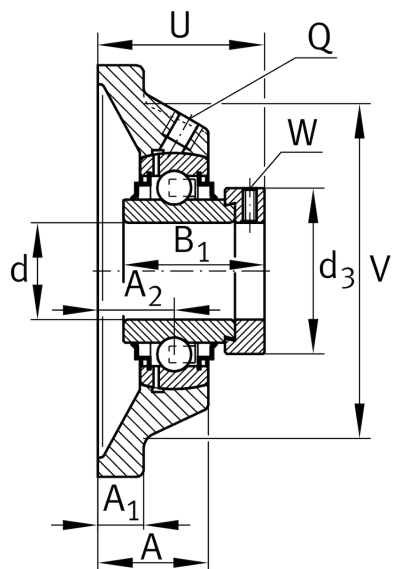
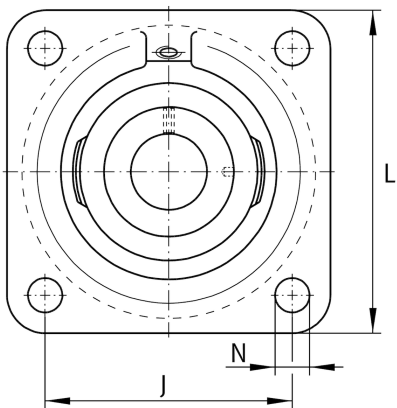

Main Dimensions & Performance Data

d	30 mm	Bore diameter
L	125 mm	Flange width
U	53.1 mm	Total height unit
C _r	29,500 N	Basic dynamic load rating, radial
C _{0r}	16,700 N	Basic static load rating, radial
C _{ur}	870 N	Fatigue load limit, radial
	1.7 kg	Weight

Mounting dimensions

J	95 mm	Distance fixing bore
N	14.5 mm	Fixing bore
n	4	Number of screwing holes

Dimensions

A	30.6 mm	Height housing
A ₁	15 mm	Thickness of flange
A ₂	20.6 mm	Distance raceway
V	98 mm	Shoulder diameter housing
Q	M6	Connection thread lubrication
d ₃	51 mm	Outside diameter eccentric locking collar

Additional information		
d	30 mm	Inner diameter bearing
d	30 mm	Inner diameter bearing
d	1.18 in	Inner diameter bearing
d	1 3/16 in	Inner diameter bearing
D	72 mm	Outer diameter bearing
D	72 mm	Outer diameter bearing
D	2.83 in	Outer diameter bearing
H	125 mm	Housing height
H	125 mm	Housing height
H	4.92 in	Housing height
L	125 mm	Housing length
L	125 mm	Housing length
L	4.92 in	Housing length
B	53.1 mm	Housing width
B	53.1 mm	Housing width
B	2.09 in	Housing width
h	62.5 mm	Height bearing seat
h	62.5 mm	Height bearing seat
h	2.46 in	Height bearing seat
m	134.35 mm	distance between mounting bolt centerlines (length)
m	134.35 mm	distance between mounting bolt centerlines (length)
m	5.29 in	distance between mounting bolt centerlines (length)
C _r	31,500 N	Basic dynamic load rating
C _r	7,081.83 lbf	Basic dynamic load rating
C _r	31,500 N	Basic dynamic load rating
C _{0r}	16,700 N	Basic static load rating
C _{0r}	3,754.5 lbf	Basic static load rating
C _{0r}	16,700 N	Basic static load rating
	RCJO30-XL	Housing in kit
	GNE30-XL-KRR-B	Bearing in kit

Additional information		
	1	Number of housings
	CJO06	Housing
	GNE30-XL-KRR-B	Bearing designation

Temperature range		
T _{min}	-20 °C	Operating temperature min.
T _{max}	120 °C	Operating temperature max.