

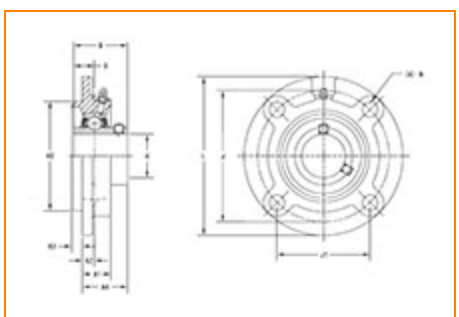

**The Timken Company**  
 4500 Mt Pleasant St. NW  
 N. Canton, OH 44720  
**Phone:** (234) 262-3000  
**E-Mail:** [CustomerCAD@timken.com](mailto:CustomerCAD@timken.com) • **Web site:** [www.timken.com](http://www.timken.com)

# Part Number UCFC215, UCFC 200 Piloted Round Flanged Mounted Bearings - Set Screw Locking



[Specifications](#) | [Dimensions](#) | [Basic Load Ratings](#)

## Specifications

|                      |                   |
|----------------------|-------------------|
| Bearing Number       | UC215             |
| Shaft Size d         | 75 mm             |
| UPC Code             | 087796076129      |
| Locking Style        | Set Screw Locking |
| Housing Construction | Round Flange      |

## Dimensions

|  |                    |
|--|--------------------|
| Total Height L   | 220 mm<br>8.661 in |
|  Pilot Outside Diameter H3 | 160 mm             |

|  |                      |
|--|----------------------|
| <b>Bolt Circle Diameter J</b>                | 184 mm<br>7.244 in   |
| <b>Bolt Hole Spacing J1</b>                  | 130.1 mm<br>5.122 in |
| <b>Bolt Hole Size N</b>                      | 19 mm<br>0.748 in    |
| <b>Flange Width A1</b>                       | 40 mm<br>1.575 in    |
| <b>Center of Bearing from Housing End A2</b> | 18 mm<br>0.709 in    |
| <b>Pilot Width A3</b>                        | 16 mm                |
| <b>Inner Ring Width B</b>                    | 77.8 mm<br>3.063 in  |
| <b>Center of Bearing from Bearing End S</b>  | 33.3 mm<br>1.311 in  |
| <b>Dimension A4</b>                          | 62.5 mm<br>2.469 in  |

## Basic Load Ratings

|                            |                      |
|----------------------------|----------------------|
| <b>Static Load Rating</b>  | 48300 N<br>10858 lbf |
| <b>Dynamic Load Rating</b> | 67400 N<br>15152 lbf |

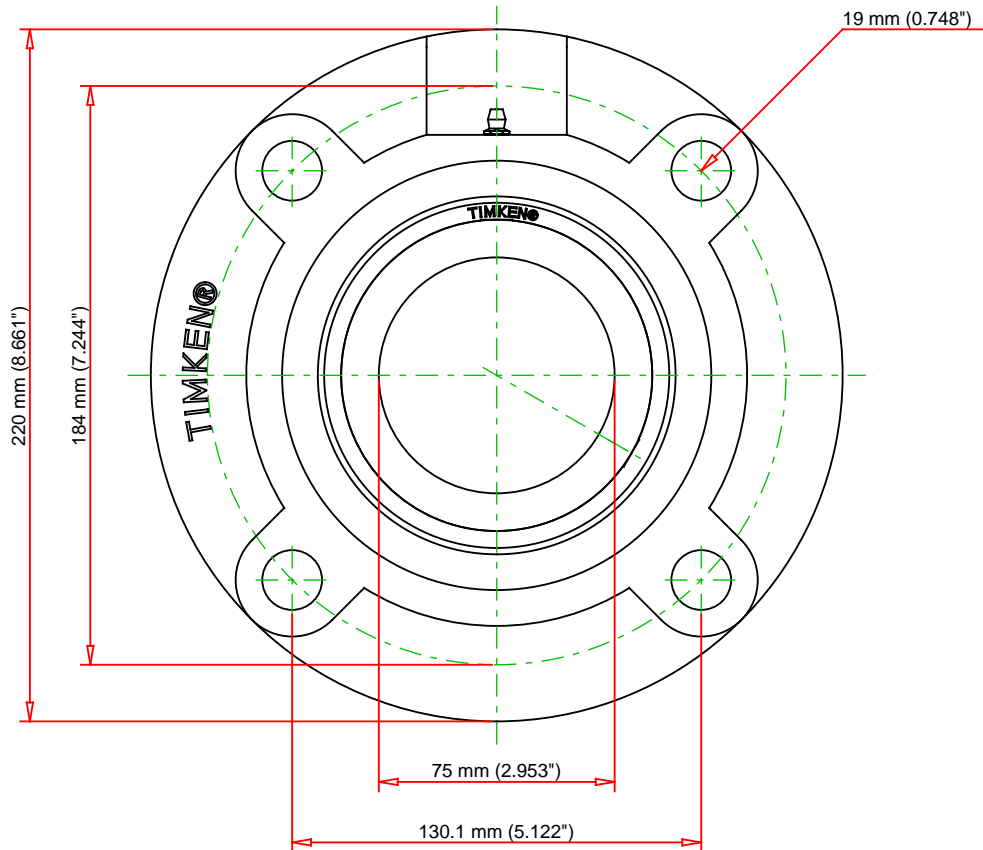
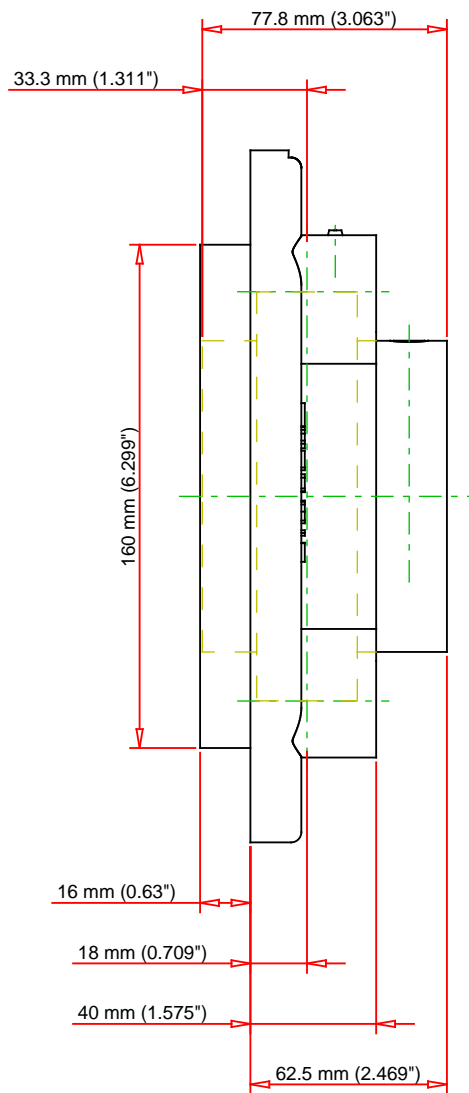

|                                |       |     |       |    |
|--------------------------------|-------|-----|-------|----|
| Bearing Number                 | UC215 |     |       |    |
| Load Ratings - C <sub>r</sub>  | 15152 | lbf | 67400 | N  |
| Load Ratings - C <sub>0r</sub> | 10858 | lbf | 48300 | N  |
| Weight                         | 15.9  | lb  | 7.2   | kg |
| Bolt Size                      | M16   |     |       |    |

**TIMKEN**

THE TIMKEN COMPANY  
NORTH CANTON, OHIO USA

**UCFC215**

UCFC 200 Piloted Round Flanged Mounted  
Bearings - Set Screw Locking

Every reasonable effort has been made to ensure the accuracy of the information contained in this writing, but no liability is accepted for errors, omissions or for any other reason.

**FOR DISCUSSION ONLY**