



PCJTY60-XL-N

Flanged housing unit

Schaeffler ID:  
0009492560000

Housing units PCJTY, two-bolt flanged housing units, cast iron, grub screws in inner ring, P seals

X-life

Technical information

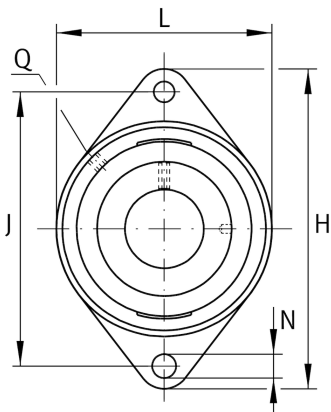

Main Dimensions & Performance Data

d	60 mm	Bore diameter
L	138 mm	Flange width
H	238 mm	Height flange
U	68 mm	Total height unit
C <sub>r</sub>	56,000 N	Basic dynamic load rating, radial
C <sub>0r</sub>	36,000 N	Basic static load rating, radial
C <sub>ur</sub>	1,870 N	Fatigue load limit, radial
	3.16 kg	Weight

Mounting dimensions

J	202 mm	Distance fixing bore
N	18 mm	Fixing bore
n	2	Number of screwing holes

Dimensions

A	46 mm	Height housing
A <sub>1</sub>	16 mm	Thickness of flange
A <sub>2</sub>	34 mm	Distance raceway
B	47 mm	Width
V	138 mm	Shoulder diameter housing
Q	Rp1/8	Connection thread lubrication

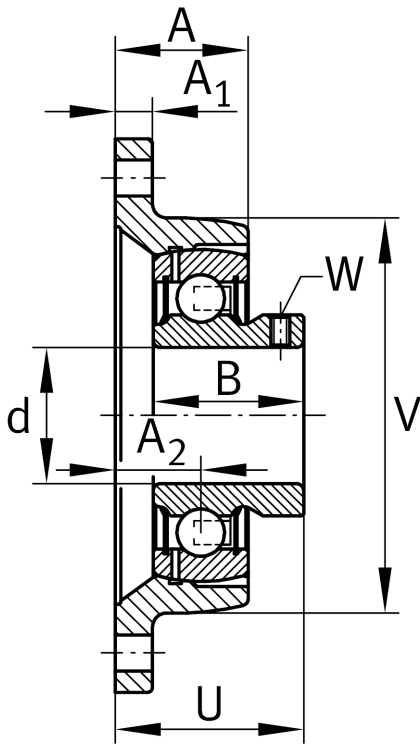

Additional information

d	60 mm	Inner diameter bearing
d	60 mm	Inner diameter bearing
d	2.36 in	Inner diameter bearing
d	2 3/8 in	Inner diameter bearing
D	110 mm	Outer diameter bearing
D	110 mm	Outer diameter bearing
D	4.33 in	Outer diameter bearing
H	238 mm	Housing height
H	238 mm	Housing height
H	9.37 in	Housing height
L	138 mm	Housing length
L	138 mm	Housing length
L	5.43 in	Housing length
B	68 mm	Housing width
B	68 mm	Housing width
B	2.68 in	Housing width
h	119 mm	Height bearing seat
h	119 mm	Height bearing seat
h	4.69 in	Height bearing seat
m	202 mm	distance between mounting bolt centerlines (length)
m	202 mm	distance between mounting bolt centerlines (length)
m	7.95 in	distance between mounting bolt centerlines (length)
C <sub>r</sub>	56,000 N	Basic dynamic load rating
C <sub>r</sub>	12,589.93 lbf	Basic dynamic load rating
C <sub>r</sub>	56,000 N	Basic dynamic load rating
C <sub>0r</sub>	36,000 N	Basic static load rating
C <sub>0r</sub>	8,093.53 lbf	Basic static load rating
C <sub>0r</sub>	36,000 N	Basic static load rating
PCJTY60-XL-N-I		Housing in kit

Additional information

1	Number of housings
CJT12	Housing
GAY60-XL-NPP-B	Bearing designation
KASK12	Protecting cap

Temperature range		
T <sub>min</sub>	-20 °C	Operating temperature min.
T <sub>max</sub>	120 °C	Operating temperature max.