



**LOCKNUT-SOCKET-KM20** [🔗](#)

Locknut socket wrench

for locknuts and precision locknuts

Technical information

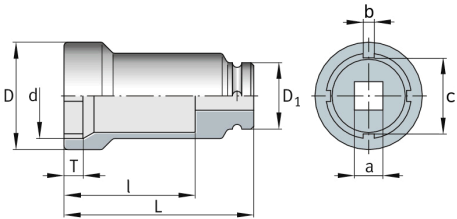

Dimensions

d	130.8 mm	
D	143 mm	
D <sub>1</sub>	62 mm	
L	110 mm	
l	80 mm	
T	18 mm	
a	1"	Square (inch)
b	9.5 mm	
c	123 mm	
≈m	3.3 kg	Weight

Additional information

KM20	suitable for locknuts
ZMA90/130, ZM100	suitable for precision locknuts
1 pc. socket wrench with locking pin and rubber washer	included in delivery