

Exploded View of Base Mounted Type Manifold

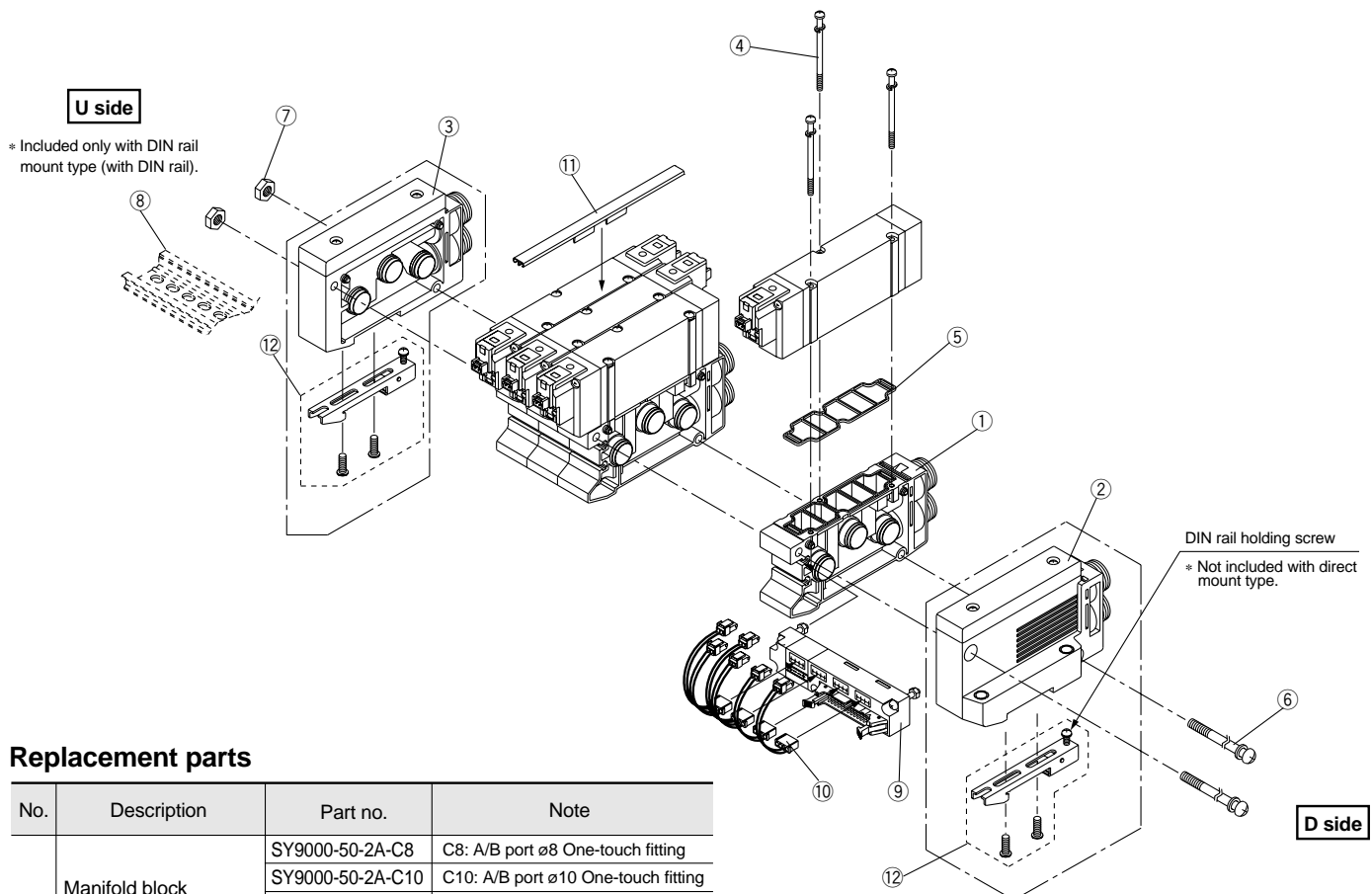

Replacement parts

No.	Description	Part no.	Note
1	Manifold block assembly	SY9000-50-2A-C8	C8: A/B port ø8 One-touch fitting
		SY9000-50-2A-C10	C10: A/B port ø10 One-touch fitting
		SY9000-50-2A-C12	C12: A/B port ø12 One-touch fitting
		SY9000-50-2A-02	02: A/B port Rc 1/4
		SY9000-50-2A-03	03: A/B port Rc 3/8
4	Round head combination screw	SY9000-18-2	M3 x 42 (Flat nickel plated)
5	Gasket	SY9000-11-2	
6	Tension bolt	SY9000-23-□	Specify the number of stations inside □ in the part number.
7	Hexagon nut	SY9000-25-1	
8	DIN rail	VZ1000-11-4-□	Refer to page 1.2-99.
9	Wiring unit assembly	SY9000-36-□A	Specify the number of stations (4 to 12) inside □ in the part number.
10	Connector assembly	SY9000-37-□□	Refer to page 1.2-93.
11	Lead wire cover	SY9000-41-1	
12	Clamp bracket sub-assembly	SY9000-30-1A	Included with the DIN rail mount type.

How to install lead wire cover

Lead wire cover is only used for double solenoid valves. As shown in the expanded view below, insert lead wires inside the lead wire cover and push until the cover is tightly in contact with the valve body.

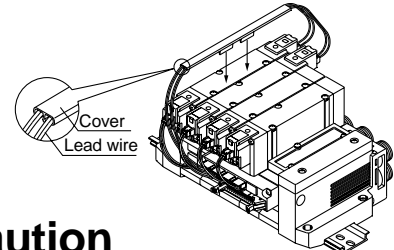

Caution

For 43P type (flat ribbon cable manifold) of series SY9000, lead wire cover to bundle lead wire of each solenoid is available. When double solenoid valves are added, order lead wire covers separately.

SUP/EXH Block Assembly ② Part Nos. (D Side Mount Type)

Direct mount type: SY9000-70-□A-□

DIN rail mount type: SY9000-72-□A-□

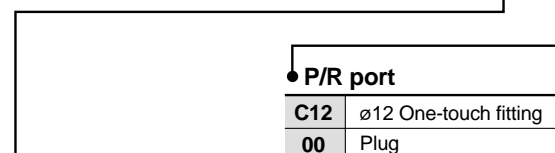

Specification

1	Internal pilot type
3	External pilot type
4	Internal pilot with built-in silencer type
5	External pilot with built-in silencer type

SUP/EXH Block Assembly ③ Part Nos. (U Side Mount Type)

Direct mount type: SY9000-71-□A-□

DIN rail mount type: SY9000-73-□A-□

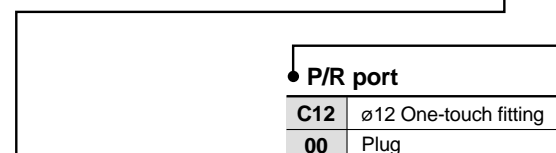

Specification

1	Internal pilot type
3	External pilot type
4	Internal pilot with built-in silencer type
5	External pilot with built-in silencer type

SV

SY

SYJ

SX

VK

VZ

VF

VFR

VP7

VQC

SQ

VQ

VQ4

VQ5

VQZ

VQD

VFS

VS

VS7

VQ7