



LOCKNUT-SOCKET-KM19 [🔗](#)

Locknut socket wrench

for locknuts and precision locknuts

Technical information

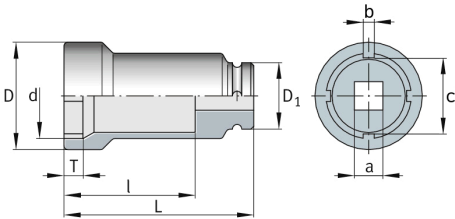

Dimensions

d	125.8 mm	
D	137 mm	
D ₁	62 mm	
L	110 mm	
l	80 mm	
T	17 mm	
a	1"	Square (inch)
b	9.5 mm	
c	118 mm	
≈m	3.01 kg	Weight

Additional information

KM19	suitable for locknuts
1 pc. socket wrench with locking pin and rubber washer	included in delivery