

ISO Cylinder: Standard/Non-rotating Type Double Acting, Single/Double Rod

Series C85

ø8, ø10, ø12, ø16, ø20, ø25

How to Order

Double acting Single rod	C	D	85	K	N	16	40	C	J	A	R2
Double acting Double rod	C	D	85 W	E	16	40	C	JJ	B		

Built-in magnet	
Nil	None
D	Built-in magnet

Type	
Nil	Standard
K	Non-rotating rod (Rubber cushion only)

Mounting style	
Symbol	Mounting
N	Basic integrated clevis
E**	Double end
F**	Front nose
Y**	Front nose in line port

* Double acting, Double rod:
Only double end style (E).
** Except air cushion type.

Auto switch mounting type	
A	Rail mounting
B	Band mounting

Applicable auto switches and bands are shown on page 6-11-44. Please order auto switches and bands separately.

Option	
R	Stainless steel piston rod, rod end nut and mounting nut
R2	Stainless steel piston rod and rod end nut

Note) Please refer to page 6-11-47 for additional options. Only one option can be selected.

Rod boot (Only ø20, ø25)	
Nil	Without rod boot
J	Nylon tarpaulin one side
K	Heat resistant tarpaulin one side
JJ*	Nylon tarpaulin both sides
KK*	Heat resistant tarpaulin both sides

* In the case of double acting/double rod.

Cushion	
Nil	Rubber cushion (Standard)
C	Air cushion (Only "N" execution, bores 10 to 25 mm)

Bore size (mm)	Standard stroke (mm)**	Max. stroke (mm)		
		Standard	Non-rotating	Double rod
8*	10, 25, 40, 50, 80, 100	400	100	100
10				
12				
16	10, 25, 40, 50, 80, 100, 125, 160, 200	1000	1000	500
20	10, 25, 40, 50, 80, 100, 125, 160, 200, 250, 300			
25				

* Not available with air cushion.
** Other strokes available on request.

Mounting Bracket Part No.

Bore size (mm)		8	10	12	16	20	25
Mounting bracket	Foot (1 pc.)	C85L10A	C85L16A	C85L25A			
	Foot (2 pcs. with mounting nut 1 pc.)	C85L10B	C85L16B	C85L25B			
	Flange	C85F10	C85F16	C85F25			
	Trunnion	C85T10	C85T16	C85T25			
	Clevis	C85C10	C85C16	C85C25			
Accessory	Single knuckle joint	KJ4D	KJ6D	KJ8D	KJ10D		
	Double knuckle joint	GKM4-8	GKM6-10	GKM8-16	GKM10-20		
	Floating joint	JA10-4-070	JA15-6-100	JA20-8-125	JA30-10-125		

Replacement Parts For Standard Cylinders

Bore size (mm)	Part no.	Note
20	C85-20PS	Every set includes: n°1 rod seal n°1 seal retaining washer n°1 retaining ring
25	C85-25PS	

For Non-rotating Cylinders ("K")

Bore size (mm)	Part no.	Note
20	C85K-20PS	Every set includes: n°1 rod seal n°1 seal retaining washer n°1 retaining ring
25	C85K-25PS	

ISO Cylinder: Standard/Non-rotating Type Double Acting, Single/Rod Series C85

Construction

[First angle projection]

Double acting, Single rod

C□85□8 to 16 Rubber cushion (Disassembly is not possible.)

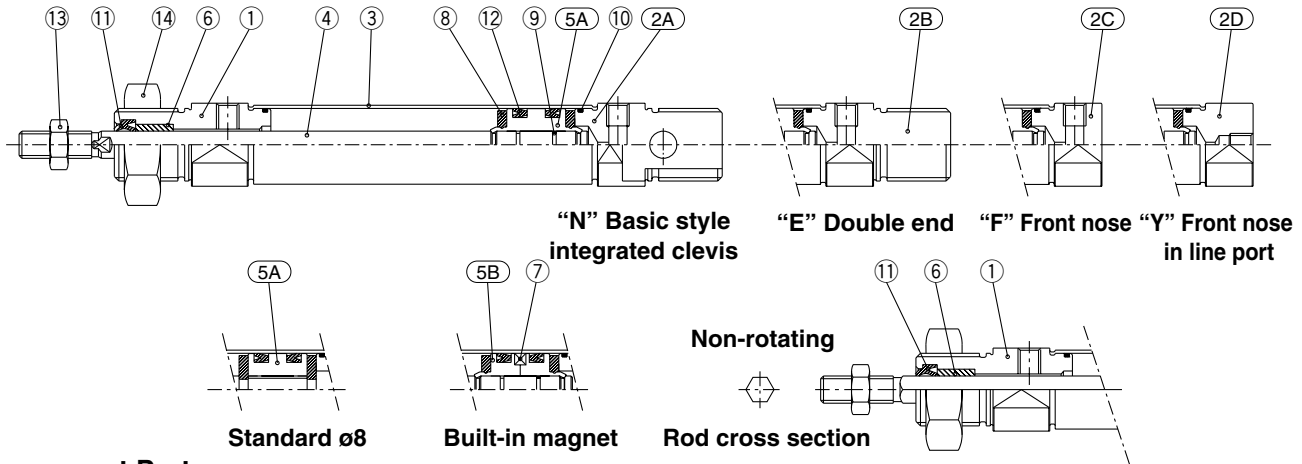

Component Parts

No.	Description	Material	Qty.	Note
①	Rod cover	Aluminum alloy	1	White anodized
②A	Head cover N	Aluminum alloy	1	White anodized
②B	Head cover E	Aluminum alloy	1	White anodized
②C	Head cover F	Aluminum alloy	1	White anodized
②D	Head cover Y	Aluminum alloy	1	White anodized
③	Cylinder tube	Stainless steel	1	
④	Piston rod	Stainless steel	1	
⑤A	Piston A	Brass	1	
⑤B	Piston B	Brass	2	(Switch type piston)

No.	Description	Material	Qty.	Note
⑥	Bush	Sintered bronze	1	
⑦	Magnet	Magnet	1	(Switch type only)
⑧	Bumper	Urethane	2	
⑨	Piston gasket	NBR	1	(2 for switch type)
⑩	Tube gasket	NBR	2	
⑪	Rod seal	NBR	1	
⑫	Piston seal	NBR	2	
⑬	Rod end nut	Carbon steel	1	Nickel plating
⑭	Mounting nut	Carbon steel	1	Nickel plating

C□85□20/25 Rubber cushion

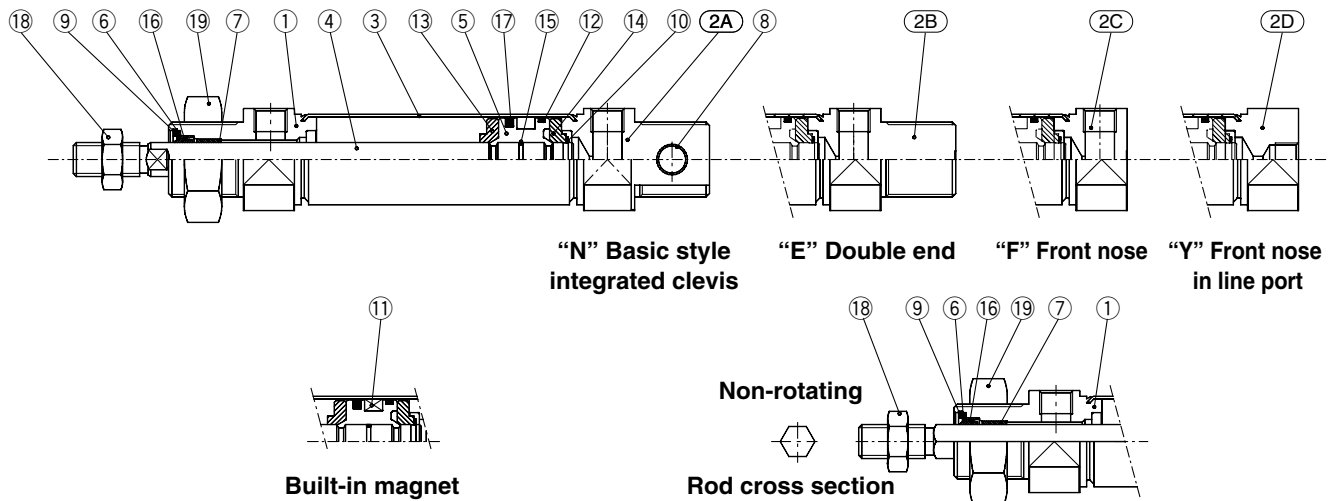

Component Parts

No.	Description	Material	Qty.	Note
①	Rod cover	Aluminum alloy	1	White anodized
②A	Head cover N	Aluminum alloy	1	White anodized
②B	Head cover E	Aluminum alloy	1	White anodized
②C	Head cover F	Aluminum alloy	1	White anodized
②D	Head cover Y	Aluminum alloy	1	White anodized
③	Cylinder tube	Stainless steel	1	
④	Piston rod	Carbon steel	1	Hard chrome plated
⑤	Piston	Aluminum alloy	1	Chromate
⑥	Plain washer	Stainless steel	1	
⑦	Bush	Sintered bronze	1	
⑧	Bush	Sintered bronze	2	

No.	Description	Material	Qty.	Note
⑨	Retaining ring	Carbon steel	1	Nickel plating
⑩	Retaining ring	Stainless steel	1	
⑪	Magnet	Magnet	1	(Switch type only)
⑫	Wear ring	Resin	1	
⑬	Bumper A	Urethane	1	
⑭	Bumper B	Urethane	1	
⑮	Piston gasket	NBR	1	
⑯	Rod seal	NBR	1	
⑰	Piston seal	NBR	1	
⑱	Rod end nut	Carbon steel	1	Nickel plating
⑲	Mounting nut	Carbon steel	1	Nickel plating

Series C85

Construction

[First angle projection]

Double acting, Single rod

C□85□10 to 16 Air cushion (Disassembly is not possible.)

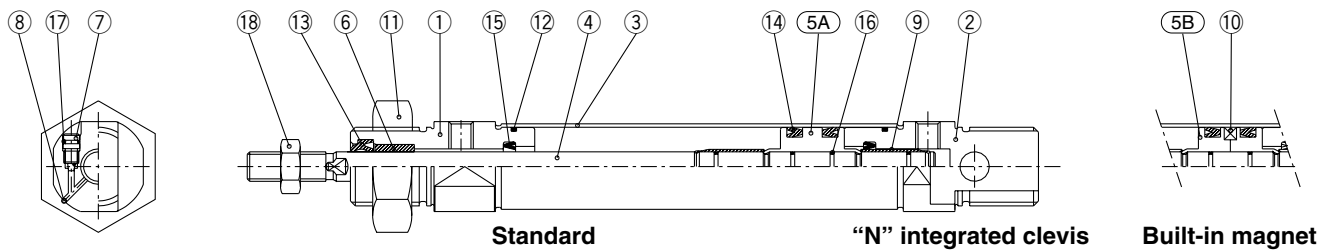

Component Parts

No.	Description	Material	Qty.	Note
①	Rod cover	Aluminum alloy	1	White anodized
②	Head cover N	Aluminum alloy	1	White anodized
③	Cylinder tube	Stainless steel	1	
④	Piston rod	Stainless steel	1	
⑤A	Piston A	Brass	1	
⑤B	Piston B	Brass	2	(Switch type piston)
⑥	Bush	Sintered bronze	1	
⑦	Cushion needle	Stainless steel	2	
⑧	Steel ball	Bearing steel	2	

No.	Description	Material	Qty.	Note
⑨	Cushion ring	Brass	2	
⑩	Magnet	Magnet	1	(Switch type only)
⑪	Mounting nut	Carbon steel	1	Nickel plating
⑫	Tube gasket	NBR	2	
⑬	Rod seal	NBR	1	
⑭	Piston seal	NBR	2	
⑮	Check seal	NBR	2	
⑯	Piston gasket and cushion ring gasket	NBR	3	(4 for switch type)
⑰	Needle seal	NBR	2	
⑱	Rod end nut	Carbon steel	1	Nickel plating

C□85□20/25 Air cushion

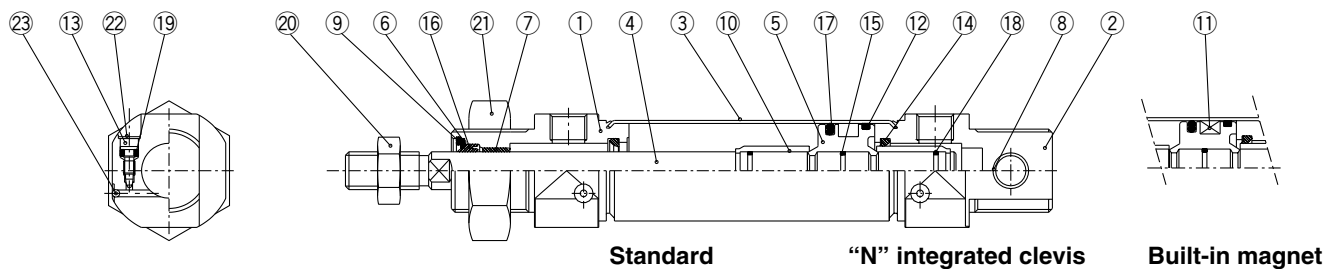

Component Parts

No.	Description	Material	Qty.	Note
①	Rod cover	Aluminum alloy	1	White anodized
②	Head cover N	Aluminum alloy	1	White anodized
③	Cylinder tube	Stainless steel	1	
④	Piston rod	Carbon steel	1	Hard chrome plated
⑤	Piston	Aluminum alloy	1	Chromate
⑥	Plain washer	Stainless steel	1	
⑦	Bush	Sintered bronze	1	
⑧	Bush	Sintered bronze	1	
⑨	Retaining ring	Carbon steel	1	Nickel plating
⑩	Cushion ring	Brass	2	
⑪	Magnet	Magnet	1	(Switch type only)
⑫	Wear ring	Resin	1	

No.	Description	Material	Qty.	Note
⑬	Cushion needle	Alloy steel	2	Electroless nickel plating
⑭	Cushion seal	Urethane	2	
⑮	Piston gasket	NBR	1	
⑯	Rod seal	NBR	1	
⑰	Piston seal	NBR	1	
⑱	Cushion ring gasket	NBR	2	
⑲	Cushion needle seal	NBR	2	
⑳	Rod end nut	Carbon steel	1	Nickel plating
㉑	Mounting nut	Carbon steel	1	Nickel plating
㉒	Self locking ring	Stainless steel	2	
㉓	Steel ball	Stainless steel	2	