



LOCKNUT-SOCKET-KM18 [🔗](#)

Locknut socket wrench

for locknuts and precision locknuts

Technical information

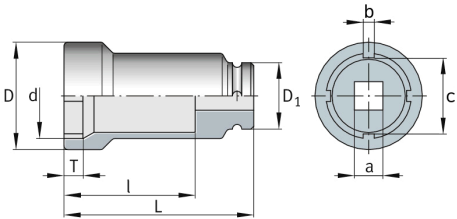

Dimensions

d	120.8 mm	
D	131 mm	
D ₁	62 mm	
L	110 mm	
l	80 mm	
T	16 mm	
a	1"	Square (inch)
b	9.5 mm	
c	113 mm	
≈m	2.9 kg	Weight

Additional information

KM18	suitable for locknuts
ZM90	suitable for precision locknuts
1 pc. socket wrench	included in delivery
with locking pin and	
rubber washer	