



The Timken Company

4500 Mt Pleasant St. NW

N. Canton, OH 44720

Phone: (234) 262-3000

E-Mail: CustomerCAD@timken.com • **Web site:** www.timken.com

Part Number 19268, Tapered Roller Bearings - Single Cups - Imperial

This is the most basic and most widely used type of tapered roller bearing. It consists of two main separable parts: the cone (inner ring) assembly and the cup (outer ring). It is typically mounted in opposing pairs on a shaft.

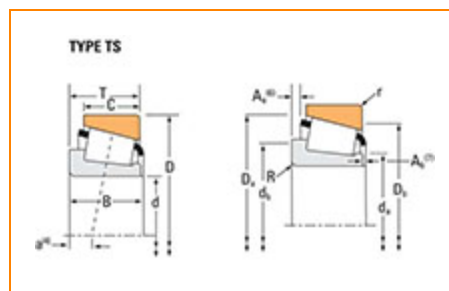

[Specifications](#) | [Dimensions](#) | [Abutment and Fillet Dimensions](#) | [Factors](#)

Specifications

Series	19000
Cup Part Number	19268
Design Units	Imperial

Dimensions

D - Cup Outer Diameter	2.6875 in 68.263 mm
C - Cup Width	0.4688 in 11.908 mm

Abutment and Fillet Dimensions

r - Cup Backface "To Clear" Radius¹	0.06 in 1.52 mm
Da - Cup Frontface Backing Diameter	2.60 in 66.00 mm
Db - Cup Backface Backing Diameter	2.40 in 60.96 mm

Factors

e - ISO Factor²	0.44
Y - ISO Factor³	1.35
Cg - Geometry Factor⁴	0.0694

¹ These maximum fillet radii will be cleared by the bearing corners.

² These factors apply for both inch and metric calculations. Consult your Timken representative for instruction on use.

³ These factors apply for both inch and metric calculations. Consult your Timken representative for instruction on use.

⁴ Geometry constant for Lubrication Life Adjustment Factor a3l.

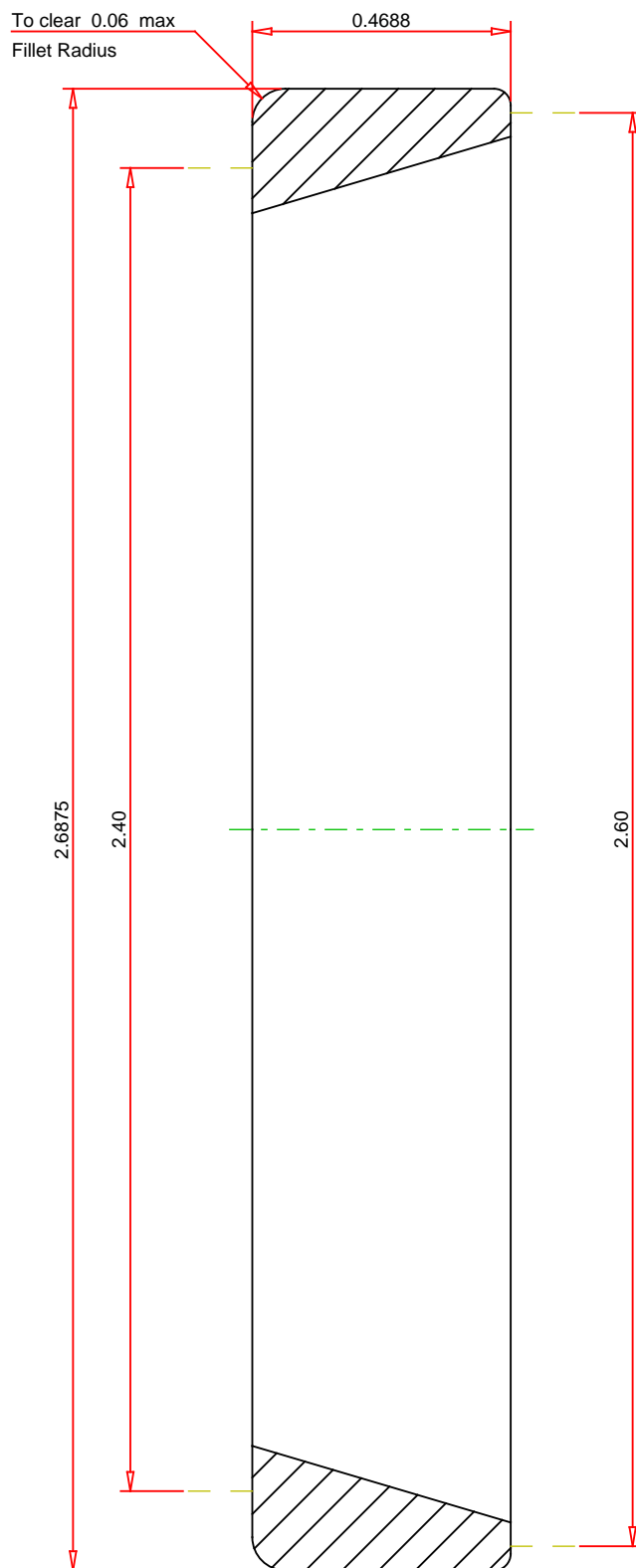

IMPERIAL UNITS

TIMKEN®

THE TIMKEN COMPANY
NORTH CANTON, OHIO USA

19268
SINGLE TAPERED CUP