

# Clamp Cylinder with Magnetic Field Resistant Auto Switch (Rod Mounting Style)

## Series **CKG1/CKP1** ø40, ø50, ø63

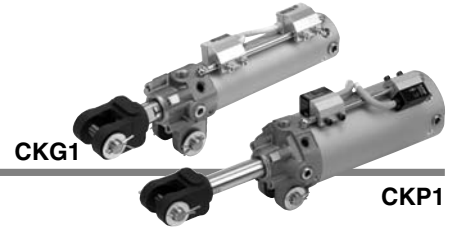

### How to Order

Built-in standard magnet type  
with magnetic field resistant  
auto switch

Built-in strong magnet type  
with magnetic field resistant  
auto switch

**CKG1** **A** **50** **-** **100** **Y** **-** **P4DWSC**

**CKP1** **A** **50** **-** **100** **Y** **-** **P79WSE**

Clevis width

<b>A</b>	16.5 mm
<b>B</b>	19.5 mm

Thread type

<b>Nil</b>	Rc1/4
<b>TN</b>	NPT1/4

Bore size

<b>40</b>	40 mm
<b>50</b>	50 mm
<b>63</b>	63 mm

Cylinder stroke (mm)

<b>40</b>	50, 75, 100, 125, 150
<b>50</b>	50, 75, 100, 125, 150
<b>63</b>	50, 75, 100, 125, 150

Number of auto switches

<b>Nil</b>	2 pcs.
<b>S</b>	1 pc.
<b>n</b>	"n" pcs.

Auto switch

<b>Nil</b>	Without auto switch (built-in magnet) Without switch mounting rod
<b>P</b>	Without auto switch (built-in magnet) With switch mounting rod

\* Select applicable auto switch models from the table below.

#### End bracket

<b>Nil</b>	None
<b>I</b>	Single knuckle joint (M6 without tap)
<b>IA</b>	Single knuckle joint (M6 with tap)
<b>Y</b>	<del>Double knuckle joint (M6 without tap)</del>
<b>YA</b>	Double knuckle joint (M6 with tap)

Note 1) IA and YA are equivalent to the conventional models.  
Note 2) Knuckle pin, cotter pin and flat washer are provided as a standard for **Y** and **YA**.

#### Option

<b>Nil</b>	None
<b>B</b>	Limit switch mounting base
<b>D</b>	Dog fitting <sup>Note 1)</sup>
<b>L</b>	Foot
<b>K</b> <sup>Note 2)</sup>	Pedestal (for 75, 100, 150 strokes only)

Note 1) When the dog bracket is selected, choose the rod end bracket IA or YA (M6 with tap).

Note 2) Clevis width B (19.5 mm) is not available with mounting base K.

### Built-in Standard (Strong) Magnet Cylinder Part No.

- 1) Built-in standard (strong) magnet type without auto switch and switch mounting rod  
Symbol for the auto switch type is "Nil" as shown below.  
CKG1: (Example) CKG1A50-50Y  
CKP1: (Example) CKP1A50-50Y
- 2) Built-in standard (strong) magnet type without auto switch, with switch mounting rod  
Symbol for the auto switch type is "P" as shown below.  
CKG1: (Example) CKG1A50-50Y-P  
CKP1: (Example) CKP1A50-50Y-P

### Applicable Magnetic Field Resistant Auto Switches (Refer to pages 1719 to 1827 for detailed auto switch specifications.)

Applicable cylinder series	Type	Auto switch model	Applicable magnetic field	Electrical entry	Indicator light	Wiring (Pin no in use)	Load voltage	Lead wire length	Applicable load
Series CKG1	Solid state auto switch	P4DWSC	AC magnetic field (Single-phase AC welding magnetic field)	Pre-wired connector	2-color display	2-wire (3-4)	24 VDC	0.3 m	Relay, PLC <small>Note 1)</small>
		Grommet		2-wire (1-4)		3 m			
				2-wire		5 m			
						P4DWZ			
Series CKP1	Reed auto switch	P79WSE	DC / AC magnetic field	Pre-wired connector	2-color display	2-wire (1-4)	24 VDC	0.3 m	
		Grommet		1-color display	2-wire	24 VDC 100 VAC	3 m		
							P74Z	5 m	

Note 1) PLC: Programmable Logic Controller

Note 2) There are other applicable auto switches other than the listed above. For details, refer to page 1329.

Note 3) Refer to page 1330 when ordering the auto switch mounting bracket assembly or switch mounting rod assembly.