



LOCKNUT-SOCKET-KM15 [🔗](#)

Locknut socket wrench

for locknuts and precision locknuts

Technical information

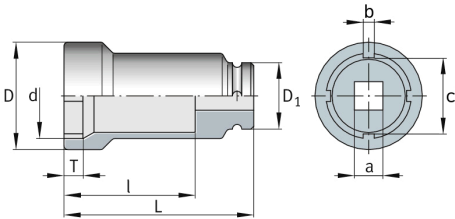

Dimensions

d	98.6 mm	
D	109 mm	
D ₁	62 mm	
L	110 mm	
l	80 mm	
T	13 mm	
a	1"	Square (inch)
b	7.6 mm	
c	91.9 mm	
≈m	2.3 kg	Weight

Additional information

KM15	suitable for locknuts
ZMA55/98, ZMA60/98, ZM75	suitable for precision locknuts
1 pc. socket wrench with locking pin and rubber washer	included in delivery