

81228-M

Axial cylindrical roller bearing

Schaeffler ID:  
0504450570000

Axial cylindrical roller bearing 812...-M,  
single row

Technical information

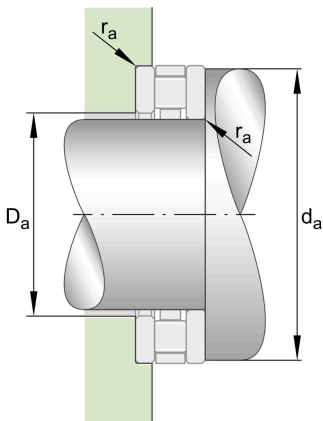
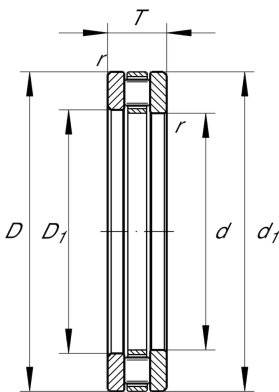

Main Dimensions & Performance Data

d	[140] mm	Bore diameter
D	[200] mm	Outside diameter
T	[46] mm	Height
C <sub>a</sub>	[455,000] N	Basic dynamic load rating, axial
C <sub>0a</sub>	[1,450,000] N	Basic static load rating, axial
C <sub>ua</sub>	[143,000] N	Fatigue load limit, axial
n <sub>G</sub>	[1,690] 1/min	Limiting speed
n <sub>gr</sub>	[730] 1/min	Reference speed
	[4.95] kg	Weight

Mounting dimensions

d <sub>a min</sub>	[191] mm	Minimum diameter shaft shoulder
D <sub>a max</sub>	[147] mm	Maximum diameter of housing shoulder
r <sub>a max</sub>	[1.5] mm	Maximum recess radius

Dimensions

D <sub>1</sub>	[143] mm	Bore diameter housing washer
d <sub>1</sub>	[197] mm	Rip diameter shaft washer
r <sub>min</sub>	[1.5] mm	Minimum chamfer dimension

Temperature range

T <sub>min</sub>	[-30] °C	Operating temperature min.
T <sub>max</sub>	[120] °C	Operating temperature max.

Additional information

[K81228-M]	Axial roller and cage assembly
[GS81228]	Housing Washer
[WS81228]	Shaft washer