

CODING EXAMPLE

3	3	8	-	94	5
3	SERIES: 1 3				
3	FUNCTION: 3 = 3/2 ways NC 4 = 3/2 ways NO (only Series 1) 5 = 5/2 ways				
8	PORTS: 8 = G1/8 4 = G1/4 (only Series 1)				
94	ACTUATION: 94 = plunger 95 = lever/roller 96 = unidirectional roller				
5	RESETTING: 5 = spring return				

Valve Mod. 338-945

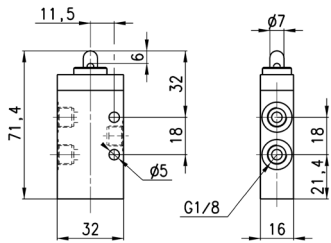
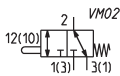

Mod.	Operating pressure (bar)	Flow (Nl/min)	Actuating force (N)
338-945	-0.9 ÷ 10	700	32