



**The Timken Company**

4500 Mt Pleasant St. NW

N. Canton, OH 44720

**Phone:** (234) 262-3000

**E-Mail:** [CustomerCAD@timken.com](mailto:CustomerCAD@timken.com) • **Web site:** [www.timken.com](http://www.timken.com)

## Part Number UCFL324, UCFL 300 Two-Bolt Flanged Mounted Bearings - Set Screw Locking

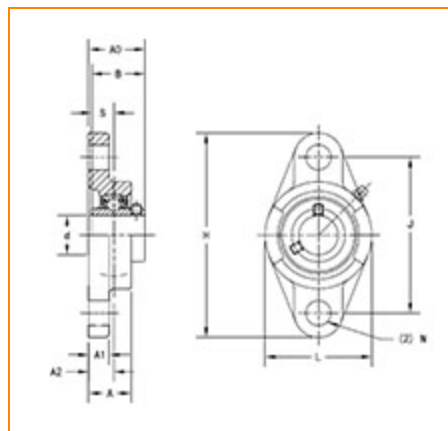

[Specifications](#) | [Dimensions](#) | [Basic Load Ratings](#)

### Specifications

<b>Bearing Number</b>	UC324
<b>Shaft Size d</b>	120 mm
<b>Locking Style</b>	Set Screw Locking
<b>Housing Construction</b>	Two-Bolt Flange

### Dimensions

<b>Total Length H</b>	520 mm
<b>Total Height L</b>	330 mm
<b>Housing Width A</b>	110 mm
<b>Bolt Hole Spacing J</b>	430 mm
<b>Bolt Hole Size N</b>	47 mm



Flange Thickness A1	48 mm
Center of Bearing from Housing End A2	65 mm
Inner Ring Width B	126 mm
Center of Bearing from Bearing End S	51 mm
Dimension A0	140 mm
Bolt Size	M42

## Basic Load Ratings

Static Load Rating	185000 N
Dynamic Load Rating	207000 N

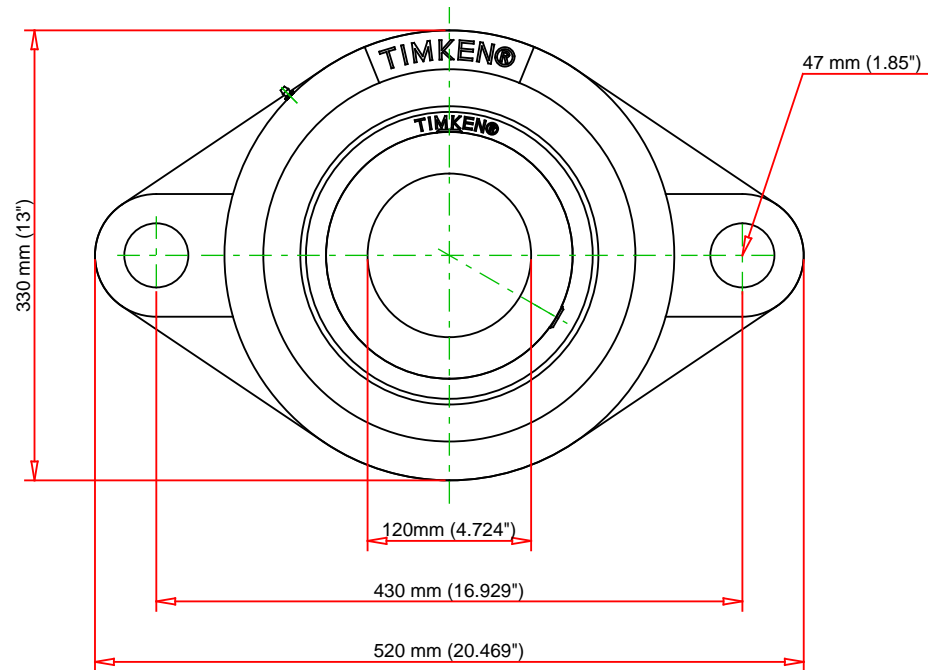

FOR DISCUSSION ONLY