

Product Data Sheet



Product Code: EF20TN esw	Issue No.	Issue Date:	Issue by:
	B	28/10/2019	T. Tombs

Description

20A 3 pole switch disconnecter fuse with neutral clamp. BS88 part 6 clip in fuses.

General Characteristics

Standards.	BSEN 60947-1 and 3.
Current rating.	20A.
Voltage rating.	230 / 400V ac.
Fault current rating. Icc	10kA, 40A maximum backup fuse.
Enclosure.	0.9mm mild steel case. 1.2mm mild steel riveted end plates. Paint finish electrostatically applied.
Handle.	ON, OFF and LOCK. Lock position prevents door opening.
IP Rating.	3X
Pollution degree.	3
No of poles.	3 switched. Bolted neutral.
Switch terminal capacity (tunnel).	10 mm.sq.
Switch terminal tightening torque.	1.2Nm. Cross head screw.
Fuse base terminal capacity (tunnel).	16 mm.sq.
Fuse base terminal torque.	3.5Nm
Cable entry facility.	Fixed plate with dual knockouts. 1 x 20/25mm, 1 x 25/32mm each end.
Door.	Left hand hinged door. Screw fixed.
No of Outgoing TP ways.	1
Equipment type.	Fixed stationary
Weight.	3.23 kg



Switchgear Fitted

Device	Rating
Contact block	20A

Fuse base and carrier. BS88 pt 6 20A. (IEC 60269-2).

General Device Specification.

Switching duty.	AC21A, AC22A, AC23A – 20A.
Fuse type.	BS88 part 6, type F1 fuses. Clip in mounting. Watts loss: 2W. Type NSD.

Product Data Sheet



Product Code: **EF20TN** esw

Issue No.

Issue Date:

Issue by:

B

28/10/2019

T. Tombs

Description

20A 3 pole switch disconnecter fuse with neutral clamp. BS88 part 6 clip in fuses.

Key Dimensions

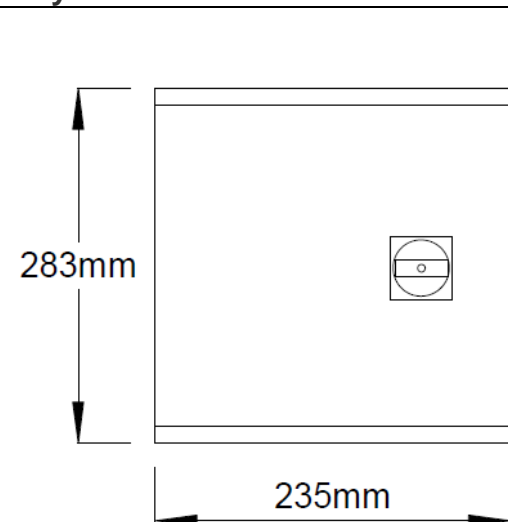

Enclosure depth 125mm + 35mm handle

Mounting hole positions

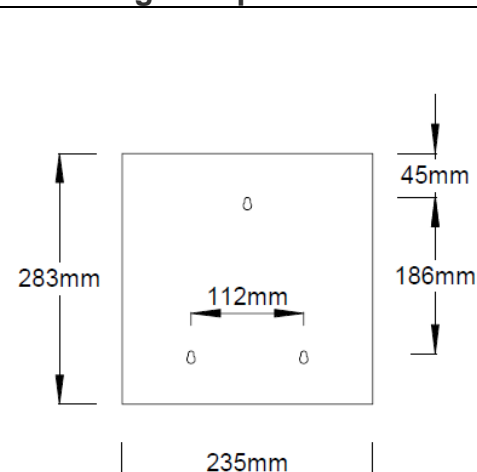

Fixing foot detail

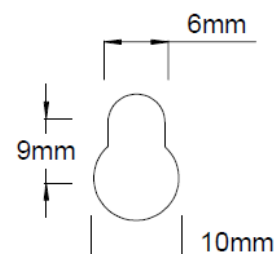

Additional information.

Usage

Intended for use by skilled persons or instructed persons.

Electrical

Earth bolt in case M6 & Neutral terminal.

Rated frequency: 50Hz.

Rated operational voltage: 230 / 400V ac.

Rated insulation voltage: 690V.

Impulse voltage (U_{imp}): 8 kV.

EMC environment: Environment type A.

Accessories:

Switched neutral pole – Pt. no. EN20/32.

Auxiliary contact 1NO, 1NC – Pt. no. M2A11

Physical

Ambient operating temperature -5 to 40 °C

(Not exceeding average of 35 °C in any 24 hour period).

Maximum altitude 2000m.

Enclosure: Mild steel, folded construction.

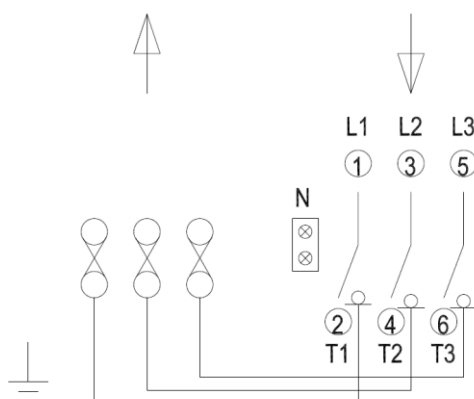

Installation

Service conditions: Wiring of this product must comply with current IEE regulations. Units are intended for indoor use and dry conditions and **NOT** where high levels of humidity and temperature are experienced.

Note: IP rating of enclosures can be compromised if correct use of glands is not followed when installing unit.

Iss B – Switch block changed to esw.

Proteus Switchgear – Industrial Division: Stafford Park 12, Telford, Shropshire, TF3 3BJ

Tel: 01952 292001 Fax: 01952 292837 W: www.proteusswitchgear.co.uk E: ind@proteusswitchgear.co.uk