

# Series 4 valves and solenoid valves

3/2, 5/2 and 5/3-way CC, CO  
Ports: G1/8, G1/4, G3/8, G1/2



Series 4 solenoid valves have been designed in the 3/2, 5/2, 5/3 versions and with the following two devices of actuation:

- electropneumatically actuated with mechanical spring return
- electropneumatically actuated and return with external and internal air pressure supply

Series 4 valves are equipped with a manual override which allows a stable operation and they are particularly suitable for mounting in arduous conditions.

All these valves can be operated by solenoids Series U, G A8 and H8. Moreover, valves with ports G1/2 only can be supplied with solenoids Series A6 (32x32).

Pneumatically actuated valves 3/2 NC become NO when the supply is on connection 3.

- » The different ports allow flows from 650 to 4000 NL/min
- » New models available: with G3/8 ports and 1800 NL/min flow

## GENERAL DATA

<b>Construction</b>	balanced spool type
<b>Valve functions</b>	3/2 - 5/2 - 5/3-way CC, CO
<b>Materials</b>	AL body and subbases stainless steel spool technopolymer end cover NBR PU seals
<b>Ports</b>	G1/8 - G1/4 - G3/8 - G1/2
<b>Installation</b>	in any position
<b>Operating temperature</b>	0 ÷ 60°C (with dry air at -20°C)
<b>Operating pressure</b>	see table
<b>Medium</b>	filtered air, without lubrication. If lubricated air is used, it is recommended to use ISOVG32 oil. Once applied the lubrication should never be interrupted.

CODING EXAMPLE

4	5	4	-	015	-	22	IL	-	U7	7
4	SERIES									
5	NUMBER OF WAYS - POSITIONS: 3 = 3/2 NC 4 = 3/2 NO 5 = 5/2 6 = 5/3 CC 7 = 5/3 CO									
4	PORTS: 2C = G1/2 2N = G1/2 (high flow) 3 = G3/8 4 = G1/4 8 = G1/8									
015	ACTUATION: 011 = double solenoid (horizontal solenoids) V11 = double solenoid (vertical solenoids) for G1/4 port only E11 = double solenoid external servo-command E15 = single solenoid external servo-command 015 = single solenoid, spring return (horizontal solenoids) V15 = single solenoid, spring return (vertical solenoid) for G1/4 port only 016 = single solenoid, pneumatic spring return (horizontal solenoid) V16 = single solenoid, pneumatic spring return (vertical solenoid) for G1/4 port only 33 = pneumatic pneumatic 34 = pneumatic differential 35 = pneumatic spring									
22	SOLENOID INTERFACE:: 22 = mech. sol. 22 x 22 50 = mech. sol. 32 x 32 (G1/2 only)									
IL	TYPE OF MANUAL OVERRIDE: = bistable, standard IL = bistable, lever type (available on demand) IM = monostable (available on demand)									
U7	ENCAPSULATING MATERIAL / SOLENOID DIMENSIONS: A6 = PPS / 32 x 32 (G1/2 only) A8 = PPS / 30 x 30 G7 = PA / 22 x 22 G8 = PA / 30 x 30 (24 V DC only) G9 = PA / 22 x 58 H8 = PA 6 V0 / 30 x 30 U7 = PET / 22 x 22									
7	SOLENOID VOLTAGE (see the dedicated section 2.35)									

TYPES OF MANUAL OVERRIDE

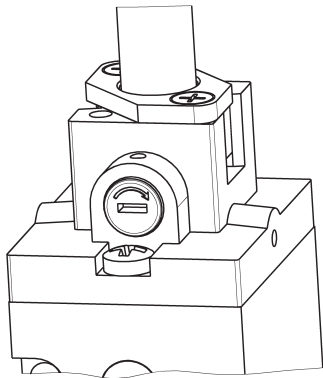

Example of solenoid valve with a bistable standard manual override.

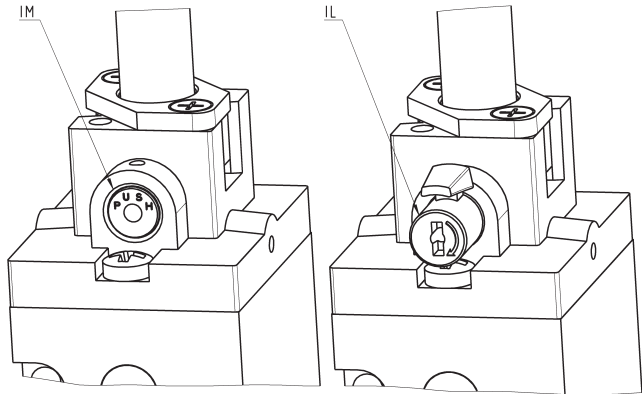

Example of solenoid monostable valve (IM) and bistable valve with a lever type manual override (IL).

**3/2-way solenoid valve, G1/4, bistable - Mod. 434-011...**



These solenoid valves, which have electropneumatic actuation and return, assume the NC (closed) or NO (open) position depending on the last pulse received.

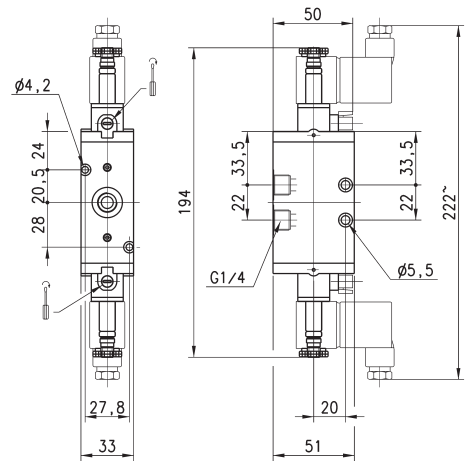
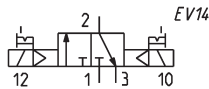

Mod.	Function	Flow rate Qn (l/min)	Operating pressure (bar)
434-011-22	3/2	1250	2 ÷ 10

**5/2-way solenoid valve, G1/4, monostable - Mod. 454...**



These solenoid valves, which have electropneumatic actuation and spring return, are suitable for operating double-acting cylinders.

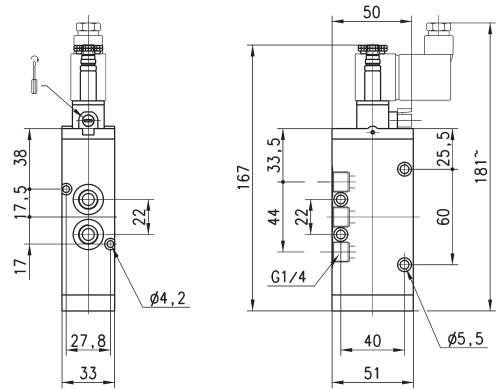
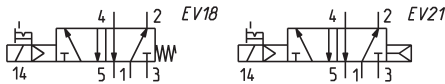

Mod.	Function	Flow rate Qn (l/min)	Operating pressure (bar)	Symbol
454-015-22	5/2	1250	2.5 ÷ 10	EV18
454-016-22	5/2	1250	2.5 ÷ 10	EV21