



**The Timken Company**

4500 Mt Pleasant St. NW

N. Canton, OH 44720

**Phone:** (234) 262-3000

**E-Mail:** [CustomerCAD@timken.com](mailto:CustomerCAD@timken.com) • **Web site:** [www.timken.com](http://www.timken.com)

## Part Number UCFL322, UCFL 300 Two-Bolt Flanged Mounted Bearings - Set Screw Locking

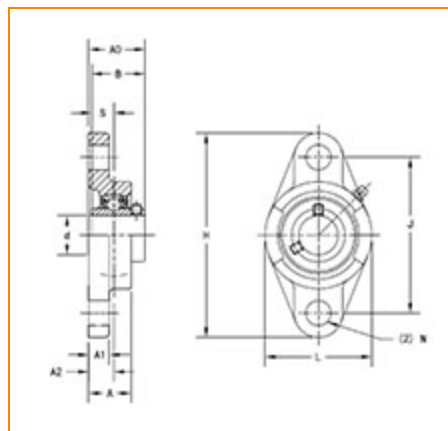

[Specifications](#) | [Dimensions](#) | [Basic Load Ratings](#)

### Specifications

<b>Bearing Number</b>	UC322
<b>Shaft Size d</b>	110 mm
<b>Locking Style</b>	Set Screw Locking
<b>Housing Construction</b>	Two-Bolt Flange

### Dimensions

<b>Total Length H</b>	470 mm 18.5 in
<b>Total Height L</b>	300 mm 11.813 in



**Housing Width A** 96 mm  
3.781 in

**Bolt Hole Spacing J** 390 mm  
15.354 in

**Bolt Hole Size N** 44 mm  
1.732 in

**Flange Thickness A1** 42 mm  
1.654 in

**Center of Bearing from Housing End A2** 60 mm  
2.362 in

**Inner Ring Width B** 117 mm  
4.606 in

**Center of Bearing from Bearing End S** 46 mm  
1.811 in

**Dimension A0** 131 mm  
5.156 in

**Bolt Size** M39

## Basic Load Ratings

**Static Load Rating** 180000 N  
40466 lbf

**Dynamic Load Rating** 205000 N  
46086 lbf

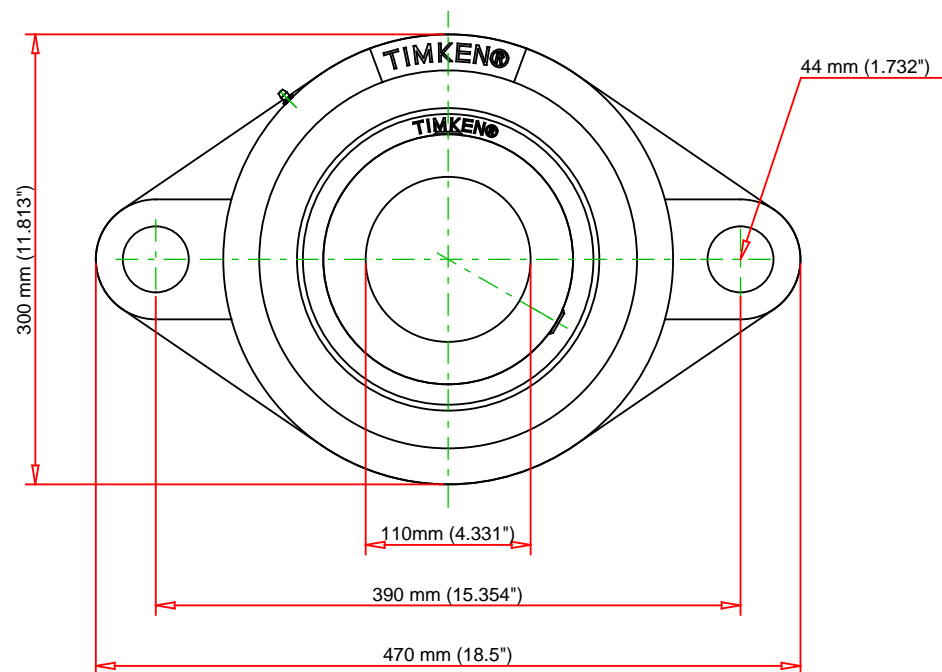
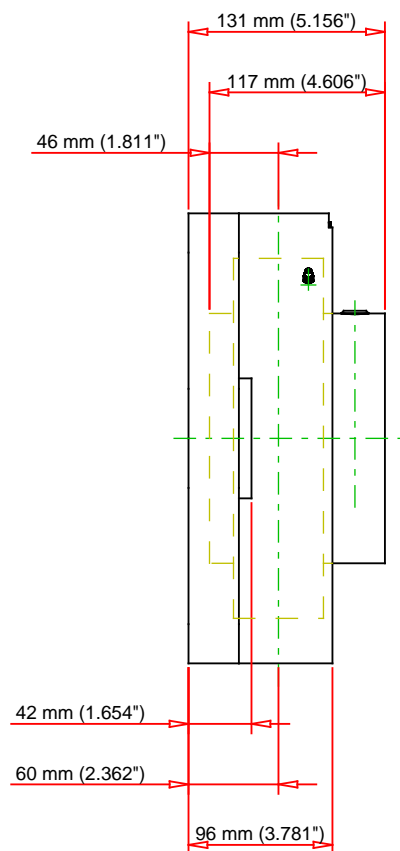

Bearing Number	UC322			
Load Ratings - C <sub>r</sub>	46086	lbf	205000	N
Load Ratings - C <sub>0r</sub>	40466	lbf	180000	N
Weight	79.8	lb	36.2	kg
Bolt Size	M39			

**TIMKEN**

THE TIMKEN COMPANY  
NORTH CANTON, OHIO USA

**UCFL322**

UCFL 300 Two-Bolt Flanged Mounted  
Bearings - Set Screw Locking

Every reasonable effort has been made to ensure the accuracy of the information contained in this writing, but no liability is accepted for errors, omissions or for any other reason.

**FOR DISCUSSION ONLY**