

# Product Data Sheet



Product Code: **EF100TN** esw

Issue No.

**C**

Issue Date:

02/04/2019

Issue by:

T. Tombs

## Description

100A 3 pole switch disconnector fuse with neutral link.  
BS88 part 2 bolt in fuses.

## General Characteristics

Standards.	BSEN 60947-1 and 3.
Current rating.	100A.
Voltage rating.	230 / 400V ac.
Fault current rating. Icc	20kA, 100A maximum backup fuse.
Enclosure.	0.9mm mild steel case. 1.2mm mild steel riveted end plates. Paint finish electrostatically applied.
Handle positions.	ON, OFF and LOCK. Lock position prevents door opening.
IP Rating.	3X
Pollution degree.	3
No. of poles.	3 switched. Bolted neutral link.
Switch terminal capacity (tunnel).	70 mm.sq.
Switch terminal torque.	6 Nm – switch. 4mm allan bolt. 15Nm – neutral. M8 bolt.
Fuse base terminal capacity (tunnel).	35 mm.sq.
Fuse base terminal torque.	4 Nm
Cable entry facility.	Fixed plate with dual knockouts. 1 x 20/25mm, 1 x 25/32mm each end.
Door.	Left hand hinged door. Screw fixed.
No of Outgoing TP ways.	1
Equipment type.	Fixed stationary
Weight.	8.0 kg



## Switchgear Fitted

Device	Rating
Contact block	100A

Fuse base and carrier. BS88 pt 2 100A (IEC 60269-2).

## General Device Specification.

Switching duty.	AC21A, AC22A, AC23A – 100A
Fuse type.	BS88 part 2, type A4C bolt in mounting. Watts loss: 7.5W. Type TCP.

# Product Data Sheet



Product Code: **EF100TN** esw

Issue No.

Issue Date:

Issue by:

**C**

02/04/2019

T. Tombs

## Description

100A 3 pole switch disconnector fuse with neutral link. BS88 part 2 bolt in fuses.

## Key Dimensions

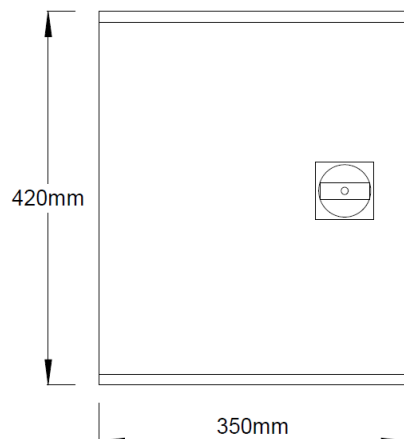

Enclosure depth 145mm + 35mm handle

## Mounting hole positions

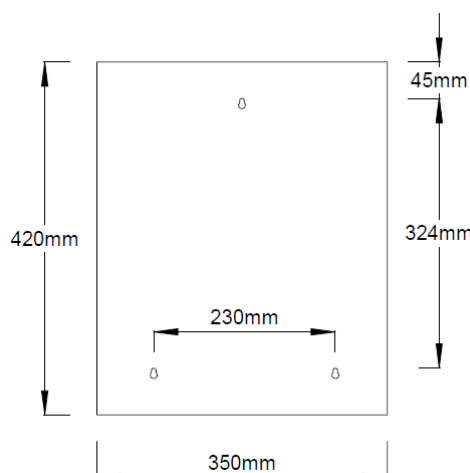

## Fixing foot detail

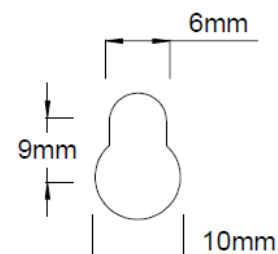

## Additional information.

### Usage

Intended for use by skilled persons or instructed persons.

### Electrical

Earth bolt in case M6 & Neutral M8 bolt.

Rated frequency: 50 / 60 Hz.

Rated operational voltage: 230 / 400V ac.

Rated insulation voltage: 800V.

Impulse voltage (U<sub>imp</sub>): 8 kV.

EMC environment: Environment type A.

### Accessories:

Switched neutral pole – Pt. no. EN100.

Auxiliary contact 1NO, 1NC – Pt. no. M2A11.

### Physical

Ambient operating temperature -5 to 40 °C

(Not exceeding average of 35 °C in any 24 hour period).

Maximum altitude 2000m.

Enclosure: Mild steel, folded construction.

### Installation

Service conditions: Wiring of this product must comply with current IEE regulations. Units are intended for indoor use and dry conditions and **NOT** where high levels of humidity and temperature are experienced.

Note: IP rating of enclosures can be compromised if correct use of glands is not followed when installing unit.

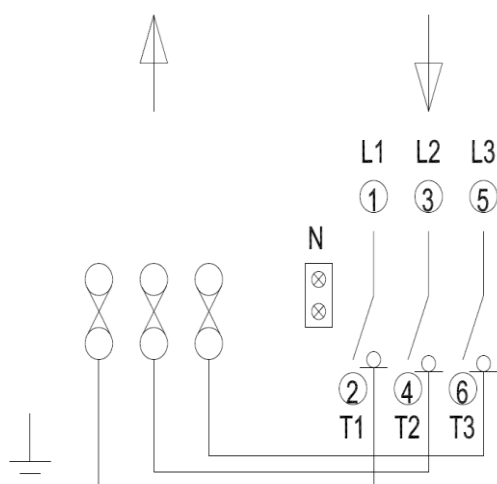

Iss B – N pole was MN. 22/12/17. Iss C – Switch changed

Proteus Switchgear – Industrial Division: Stafford Park 12, Telford, Shropshire, TF3 3BJ

Tel: 01952 292001 Fax: 01952 292837 W: [www.proteusswitchgear.co.uk](http://www.proteusswitchgear.co.uk) E: [ind@proteusswitchgear.co.uk](mailto:ind@proteusswitchgear.co.uk)