



**The Timken Company**

4500 Mt Pleasant St. NW

N. Canton, OH 44720

**Phone:** (234) 262-3000

**E-Mail:** [CustomerCAD@timken.com](mailto:CustomerCAD@timken.com) • **Web site:** [www.timken.com](http://www.timken.com)

## Part Number UCFL320, UCFL 300 Two-Bolt Flanged Mounted Bearings - Set Screw Locking

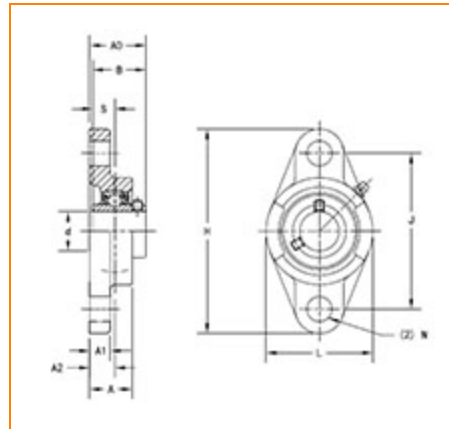

[Specifications](#) | [Dimensions](#) | [Basic Load Ratings](#)

### Specifications

<b>Bearing Number</b>	UC320
<b>Shaft Size d</b>	100 mm
<b>Locking Style</b>	Set Screw Locking
<b>Housing Construction</b>	Two-Bolt Flange

### Dimensions

<b>Total Length H</b>	440 mm 17.313 in
<b>Total Height L</b>	270 mm 10.625 in



<b>Housing Width A</b>	94 mm 3.688 in
<b>Bolt Hole Spacing J</b>	360 mm 14.173 in
<b>Bolt Hole Size N</b>	44 mm 1.732 in
<b>Flange Thickness A1</b>	40 mm 1.575 in
<b>Center of Bearing from Housing End A2</b>	59 mm 2.323 in
<b>Inner Ring Width B</b>	108 mm 4.2520 in
<b>Center of Bearing from Bearing End S</b>	42 mm 1.654 in
<b>Dimension A0</b>	125 mm 4.922 in
<b>Bolt Size</b>	M39

## Basic Load Ratings

<b>Static Load Rating</b>	141000 N 31698 lbf
<b>Dynamic Load Rating</b>	173000 N 38892 lbf

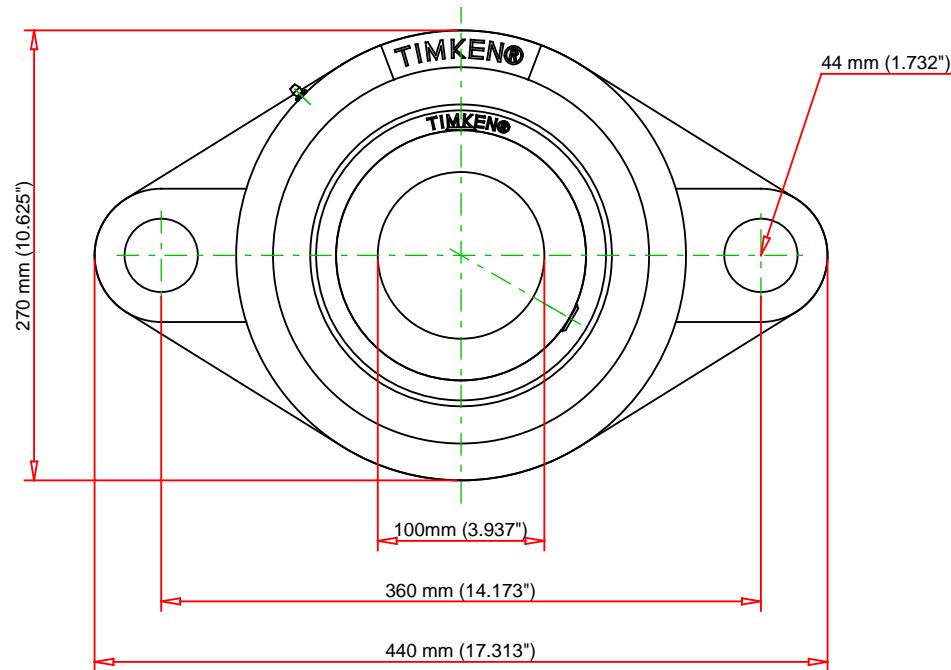
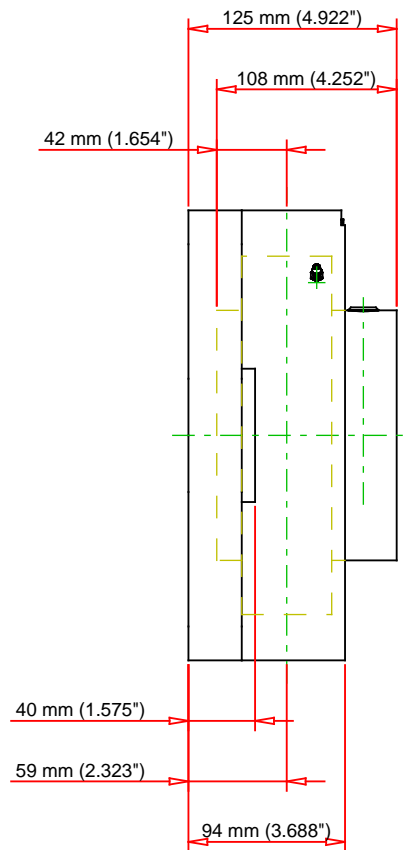

Bearing Number	UC320			
Load Ratings - C <sub>r</sub>	38892	lbf	173000	N
Load Ratings - C <sub>0r</sub>	31698	lbf	141000	N
Weight	64.8	lb	29.4	kg
Bolt Size	M39			

**TIMKEN**

THE TIMKEN COMPANY  
NORTH CANTON, OHIO USA

**UCFL320**  
UCFL 300 Two-Bolt Flanged Mounted  
Bearings - Set Screw Locking

Every reasonable effort has been made to ensure the accuracy of the information contained in this writing, but no liability is accepted for errors, omissions or for any other reason.

**FOR DISCUSSION ONLY**