

Product Data Sheet



Product Code: **E63TN** esw

Issue No.

Issue Date:

Issue by:

C

29/07/2019

T. Tombs

Description

63A 3 pole switch disconnecter with neutral link.

General Characteristics

Standards.	BSEN 60947-1 and 3.
Current rating.	63A maximum.
Voltage rating.	Up to 690V ac (see below)
Fault current rating. Icc	15kA, 63A maximum backup fuse.
Enclosure.	0.9mm mild steel case. 1.2mm mild steel riveted end plates. Paint finish electrostatically applied.
Handle positions.	ON, OFF and LOCK. Lock position prevents door opening.
IP Rating.	3X
Pollution degree.	3
No. of poles.	3 switched. Bolted neutral.
Switch terminal capacity (tunnel).	35 mm.sq.
Switch terminal torque.	3 Nm – switch. Pozi screw. 15 Nm - neutral.
Cable entry facility.	Fixed plate with dual knockouts. 1 x 20/25mm, 1 x 25/32mm each end.
Door.	Left hand hinged door. Screw fixed.
No of Outgoing TP ways.	1
Equipment type.	Fixed stationary
Weight.	3.47 kg
Switchgear Fitted	
Device	Rating
Contact block	63A



General Device Specification.

Switching duty.	400V, 63A - AC21A, AC22A, AC23A. 500V, 63A - AC21A, AC22A, AC23A. 690V, 63A – AC21A, AC22A. 690V, 40A – AC23A.
-----------------	--

Product Data Sheet



Product Code: **E63TN** esw

Issue No.

Issue Date:

Issue by:

C

29/07/2019

T. Tombs

Description

63A 3 pole switch disconnecter with neutral link.

Key Dimensions

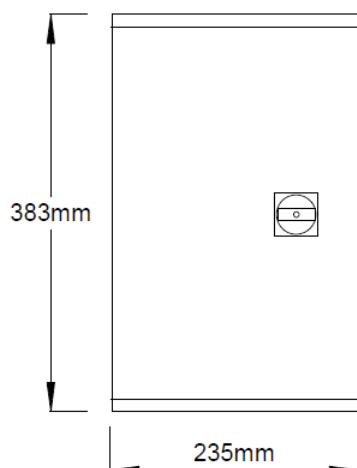

Enclosure depth 125mm + 35mm handle

Mounting hole positions

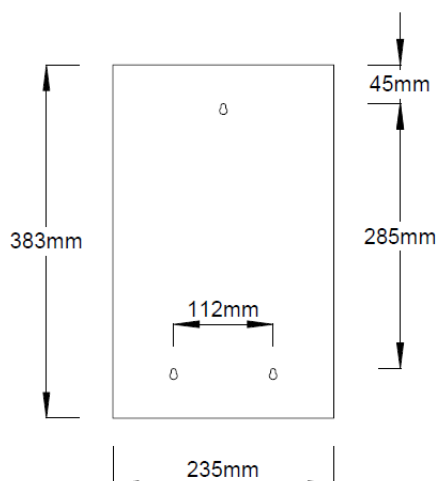

Fixing foot detail

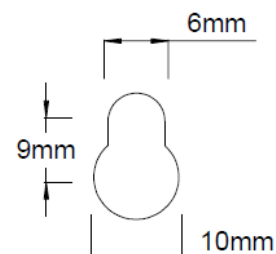

Additional information.

Usage

Intended for use by skilled persons or instructed persons.

Electrical

Earth bolt in case M6 & Neutral link M8.

Rated frequency: 50 / 60 Hz.

Rated operational voltage: Up to 690V ac.

Rated insulation voltage: 800V.

Impulse voltage (U_{imp}): 8 kV.

EMC environment: Environment type A.

Accessories:

Switched neutral pole – Pt. no. EN63

Auxiliary contact 1NO, 1NC – Pt. no. M2A11

Physical

Ambient operating temperature -5 to 40 °C

(Not exceeding average of 35 °C in any 24 hour period).

Maximum altitude 2000m.

Enclosure: Mild steel, folded construction.

Installation

Service conditions: Wiring of this product must comply with current IEE regulations. Units are intended for indoor use and dry conditions and **NOT** where high levels of humidity and temperature are experienced.

Note: IP rating of enclosures can be compromised if correct use of glands is not followed when installing unit.

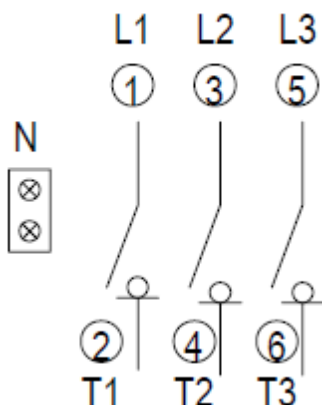

Iss B – N pole was MN. Iss C – Switch changed

Proteus Switchgear – Industrial Division: Stafford Park 12, Telford, Shropshire, TF3 3BJ

Tel: 01952 292001 Fax: 01952 292837 W: www.proteusswitchgear.co.uk E: ind@proteusswitchgear.co.uk