



The Timken Company

4500 Mt Pleasant St. NW

N. Canton, OH 44720

Phone: (234) 262-3000

E-Mail: CustomerCAD@timken.com • **Web site:** www.timken.com

Part Number 740, Tapered Roller Bearings - Single Cones - Imperial

This is the most basic and most widely used type of tapered roller bearing. It consists of two main separable parts: the cone (inner ring) assembly and the cup (outer ring). It is typically mounted in opposing pairs on a shaft.

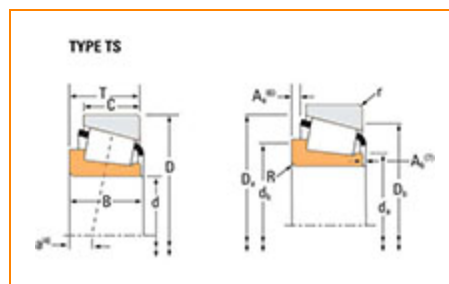

[Specifications](#) | [Dimensions](#) | [Abutment and Fillet Dimensions](#) | [Basic Load Ratings](#) | [Factors](#)

Specifications

Series	745
Cone Part Number	740
Design Units	Imperial
Cage Type	Stamped Steel
C1 - Dynamic Radial Rating (Two-Row, 1 million revolutions)¹	147000 lbf 656000 N
C90(2) - Dynamic Radial Rating (Two-Row, 90 million revolutions)²	38200 lbf 170000 N



Dimensions

d - Cone Bore	3 3/16 in 80.963 mm
----------------------	------------------------

B - Cone Width	1.8375 in 46.673 mm
-----------------------	------------------------

Abutment and Fillet Dimensions

R - Cone Backface "To Clear" Radius³	0.2 in 5.1 mm
--	------------------

da - Cone Frontface Backing Diameter	3.58 in 91 mm
---	------------------

db - Cone Backface Backing Diameter	3.98 in 101 mm
--	-------------------

Ab - Cage-Cone Frontface Clearance	0.08 in 2 mm
---	-----------------

Aa - Cage-Cone Backface Clearance	0.05 in 1.3 mm
--	-------------------

a - Effective Center Location⁴	-0.47 in -11.9 mm
--	----------------------

Basic Load Ratings

C90 - Dynamic Radial Rating (90 million revolutions)⁵	21900 lbf 97600 N
---	----------------------

C1 - Dynamic Radial Rating (1 million revolutions)⁶	84700 lbf 377000 N
---	-----------------------

C0 - Static Radial Rating	93800 lbf 417000 N
----------------------------------	-----------------------

C_{a90} - Dynamic Thrust Rating (90 million revolutions)⁷	12200 lbf 54400 N
---	----------------------

Factors

K - Factor⁸	1.8
G1 - Heat Generation Factor (Roller-Raceway)	159.6
G2 - Heat Generation Factor (Rib-Roller End)	26.3
Cg - Geometry Factor⁹	0.0898

¹ Based on 1×10^6 revolutions L_{10} life, for the ISO life calculation method.

² Based on 90×10^6 revolutions L_{10} life, for The Timken Company life calculation method. C_{90} and C_{a90} are radial and thrust values for a single-row, $C_{90(2)}$ is the two-row radial value.

³ These maximum fillet radii will be cleared by the bearing corners.

⁴ Negative value indicates effective center inside cone backface.

⁵ Based on 90×10^6 revolutions L_{10} life, for The Timken Company life calculation method. C_{90} and C_{a90} are radial and thrust values.

⁶ Based on 1×10^6 revolutions L_{10} life, for the ISO life calculation method.

⁷ Based on 90×10^6 revolutions L_{10} life, for The Timken Company life calculation method. C_{90} and C_{a90} are radial and thrust values for a single-row, $C_{90(2)}$ is the two-row radial value.

⁸ These factors apply for both inch and metric calculations. Consult your Timken representative for instruction on use.

⁹ Geometry constant for Lubrication Life Adjustment Factor a_3 .

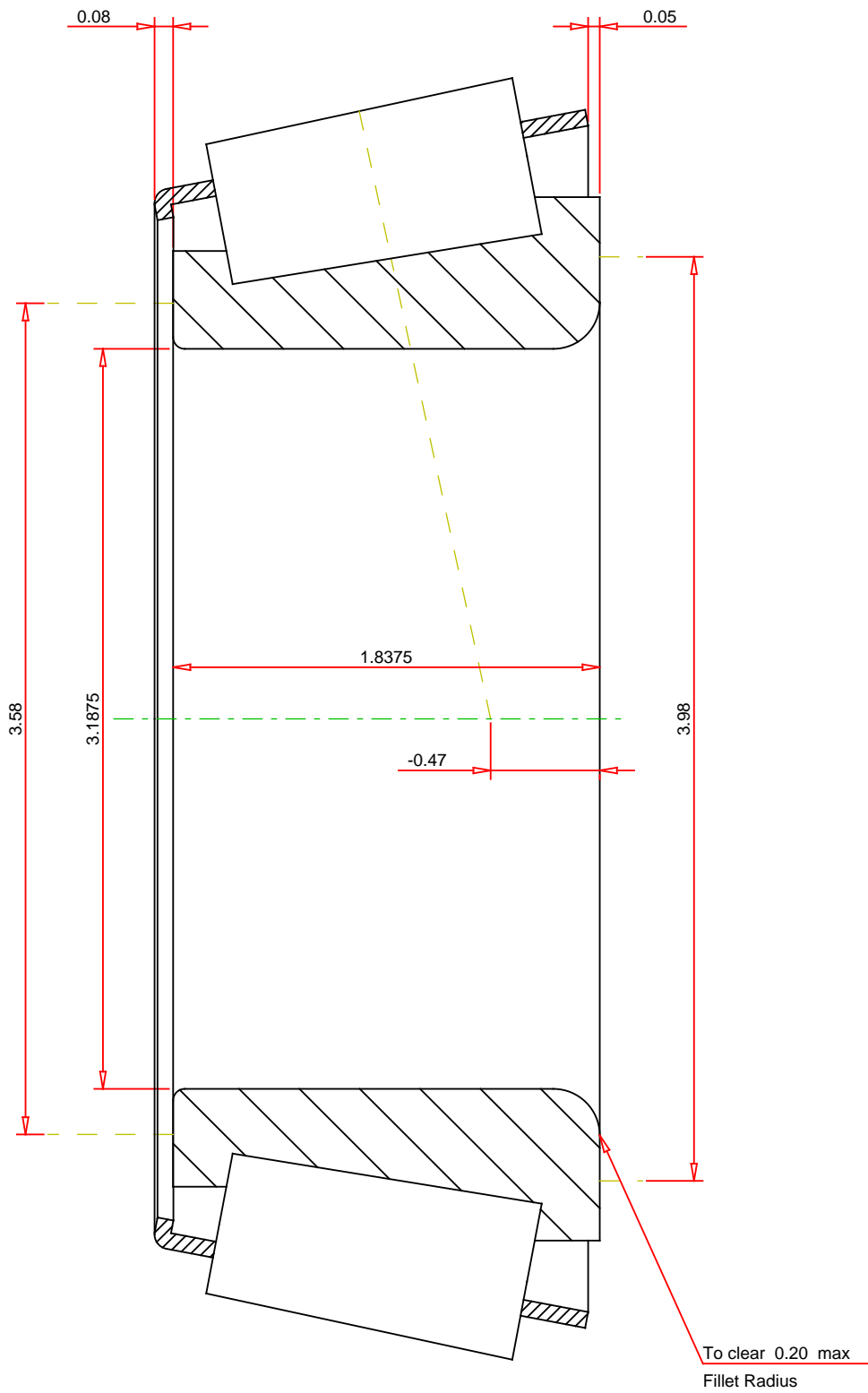

IMPERIAL UNITS

<div>Number of Rollers Per Row18</div>	<div>TIMKEN®</div> <div>THE TIMKEN COMPANY</div> <div>NORTH CANTON, OHIO USA</div>	<div>740</div> <div>Tapered Roller Bearings - Single Cones - Imperial</div> <div><div>K Factor1.8</div><div>Dynamic Radial Rating - C9021900lbf</div><div>Dynamic Thrust Rating - Ca9012200lbf</div><div>Dynamic Radial Rating - C184700lbf</div></div>
<div>Every reasonable effort has been made to ensure the accuracy of the information contained in this writing, but no liability is accepted for errors, omissions or for any other reason.</div>		<div>FOR DISCUSSION ONLY</div>