



**The Timken Company**

4500 Mt Pleasant St. NW

N. Canton, OH 44720

**Phone:** (234) 262-3000

**E-Mail:** [CustomerCAD@timken.com](mailto:CustomerCAD@timken.com) • **Web site:** [www.timken.com](http://www.timken.com)

## Part Number UCFL319, UCFL 300 Two-Bolt Flanged Mounted Bearings - Set Screw Locking

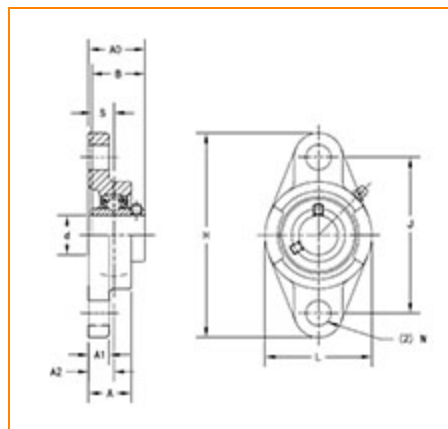

[Specifications](#) | [Dimensions](#) | [Basic Load Ratings](#)

### Specifications

<b>Bearing Number</b>	UC319
<b>Shaft Size d</b>	95 mm
<b>Locking Style</b>	Set Screw Locking
<b>Housing Construction</b>	Two-Bolt Flange

### Dimensions

<b>Total Length H</b>	405 mm 15.938 in
<b>Total Height L</b>	250 mm 9.844 in



<b>Housing Width A</b>	94 mm 3.688 in
<b>Bolt Hole Spacing J</b>	330 mm 12.992 in
<b>Bolt Hole Size N</b>	41 mm 1.614 in
<b>Flange Thickness A1</b>	40 mm 1.575 in
<b>Center of Bearing from Housing End A2</b>	59 mm 2.323 in
<b>Inner Ring Width B</b>	103 mm 4.055 in
<b>Center of Bearing from Bearing End S</b>	41 mm 1.614 in
<b>Dimension A0</b>	121 mm 4.766 in
<b>Bolt Size</b>	M36

## Basic Load Ratings

<b>Static Load Rating</b>	119000 N 26753 lbf
<b>Dynamic Load Rating</b>	153000 N 34396 lbf

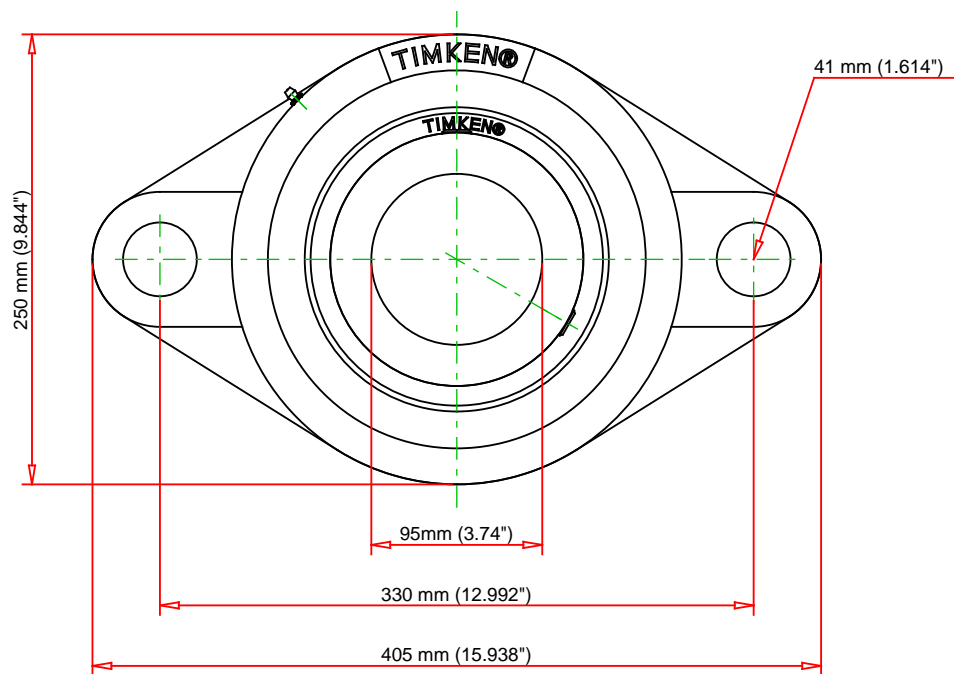
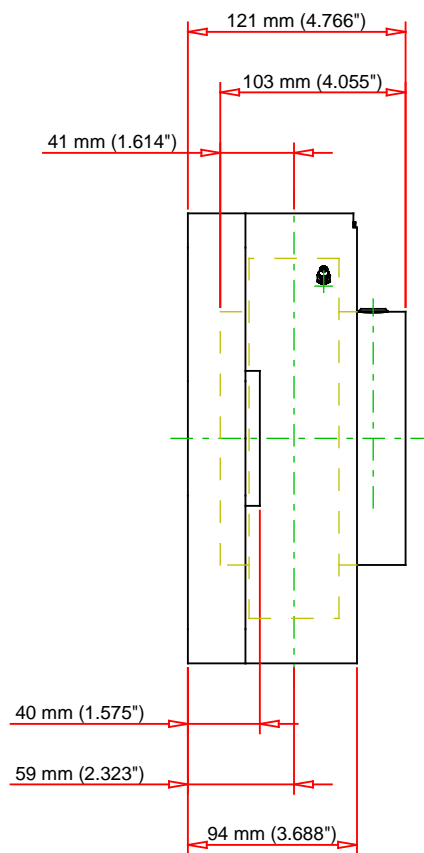

Bearing Number	UC319			
Load Ratings - C <sub>r</sub>	34396	lbf	153000	N
Load Ratings - C <sub>0r</sub>	26753	lbf	119000	N
Weight	54.2	lb	24.6	kg
Bolt Size	M36			

**TIMKEN**

THE TIMKEN COMPANY  
NORTH CANTON, OHIO USA

**UCFL319**  
UCFL 300 Two-Bolt Flanged Mounted  
Bearings - Set Screw Locking

Every reasonable effort has been made to ensure the accuracy of the information contained in this writing, but no liability is accepted for errors, omissions or for any other reason.

**FOR DISCUSSION ONLY**