



LOCKNUT-SOCKET-KM6 [🔗](#)

Locknut socket wrench

for locknuts and precision locknuts

Technical information

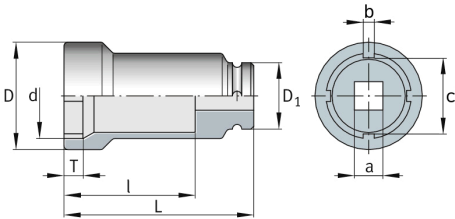

Dimensions

d	45.5 mm	
D	53 mm	
D ₁	30 mm	
L	82 mm	
l	58 mm	
T	9 mm	
a	1/2"	Square (inch)
b	4.7 mm	
c	41.6 mm	
≈m	0.42 kg	Weight

Additional information

KM6	suitable for locknuts
ZMA25/45, ZM30	suitable for precision locknuts
1 pc. socket wrench with locking pin and rubber washer	included in delivery