



The Timken Company

4500 Mt Pleasant St. NW

N. Canton, OH 44720

Phone: (234) 262-3000

E-Mail: CustomerCAD@timken.com • **Web site:** www.timken.com

Part Number W206PP, Fafnir® Deep Groove Ball Bearings (9100K, 200K, 300K)

Radial ball bearings consist of an inner and outer ring with a cage containing a complement of precision balls. The standard Conrad-type bearing has a deep-groove construction capable of handling radial and axial loads from either direction in versatile designs that permit relatively high-speed operation.

In addition to standard single-row deep groove bearings, Timken offers special designs, including a maximum capacity series and an extra large (XLS) radial series bearing.

Size range: 3 mm



[more](#)

[Specifications](#) | [Dimensions](#) | [Basic Load Ratings](#) | [Factors](#) | [Abutment and Fillet Dimensions](#)

Specifications

Design Units	METRIC
Ball Type	STEEL
Bearing Weight	0.283 Kg 0.624 lb
Manufacturing Part Number	W206PP Z17-P FS50000

Dimensions

d - Bore	30.00 mm 1.1811 in
----------	-----------------------

D - Outer Diameter	62.00 mm 2.4409 in
Bearing Width	23.83 mm 0.9382 in
do - Ball Diameter	9.525 mm 3/8 in

Basic Load Ratings

Ce - Dynamic Radial Rating¹	21600 N 4850 lbf
C0 - Static Radial Rating	11300 N 2530 lbf

Factors

Limiting Speed (Grease)	6522 rpm
Limiting Speed (Oil)	7609 rpm

Abutment and Fillet Dimensions

R - Inner Ring "To Clear" Radius²	1.00 mm 0.039 in
r - Outer Ring "To Clear" Radius³	1.00 mm 0.039 in
da - Inner Ring Backing Diameter	34.04 mm 1.3400 in
Da - Outer Ring Backing Diameter	56.13 mm 2.2100 in

¹ Based on 10^6 revolutions of calculated fatigue life.

² Maximum housing fillet radius that bearing corners will clear.

³ Maximum shaft fillet radius that bearing corners will clear.

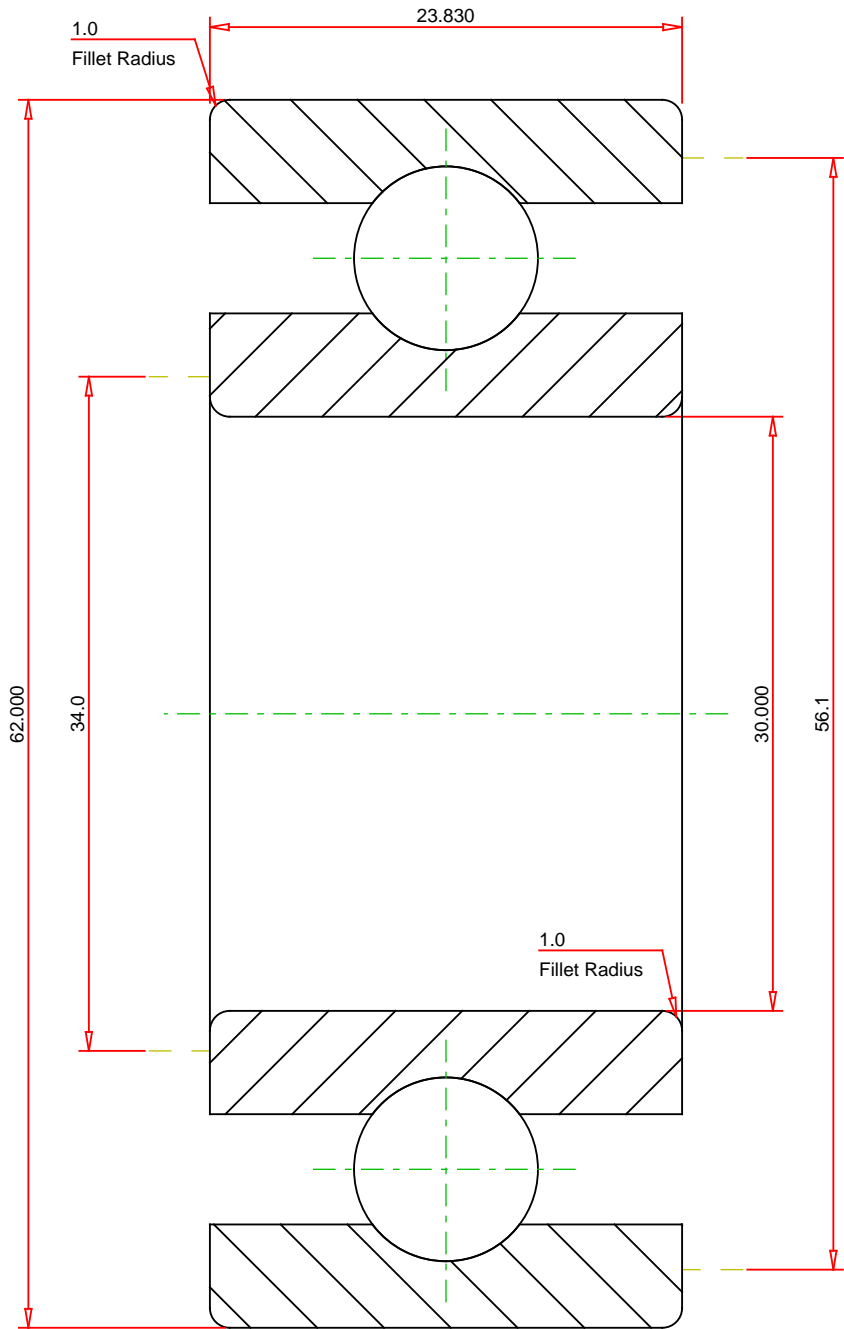

METRIC UNITS

Number of Balls Per Row Bearing Weight	9 0.283 kg	<div>TIMKEN®</div>	W206PP Fafnir® Deep Groove Ball Bearings (9100K, 200K, 300K)		
		<div>THE TIMKEN COMPANY NORTH CANTON, OHIO USA</div>	Dynamic Radial Rating	21600	N
			Static Radial Rating	11300	N