



The Timken Company

4500 Mt Pleasant St. NW

N. Canton, OH 44720

Phone: (234) 262-3000

E-Mail: CustomerCAD@timken.com • **Web site:** www.timken.com

Part Number UCFL318, UCFL 300 Two-Bolt Flanged Mounted Bearings - Set Screw Locking

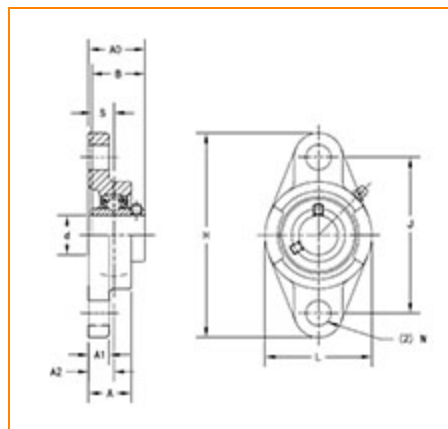

[Specifications](#) | [Dimensions](#) | [Basic Load Ratings](#)

Specifications

Bearing Number	UC318
Shaft Size d	90 mm
Locking Style	Set Screw Locking
Housing Construction	Two-Bolt Flange

Dimensions

Total Length H	385 mm
Total Height L	235 mm
Housing Width A	76 mm
Bolt Hole Spacing J	315 mm
Bolt Hole Size N	38 mm



Flange Thickness A1	36 mm
Center of Bearing from Housing End A2	44 mm
Inner Ring Width B	96 mm
Center of Bearing from Bearing End S	40 mm
Dimension A0	100 mm
Bolt Size	M33

Basic Load Ratings

Static Load Rating	107000 N
Dynamic Load Rating	143000 N

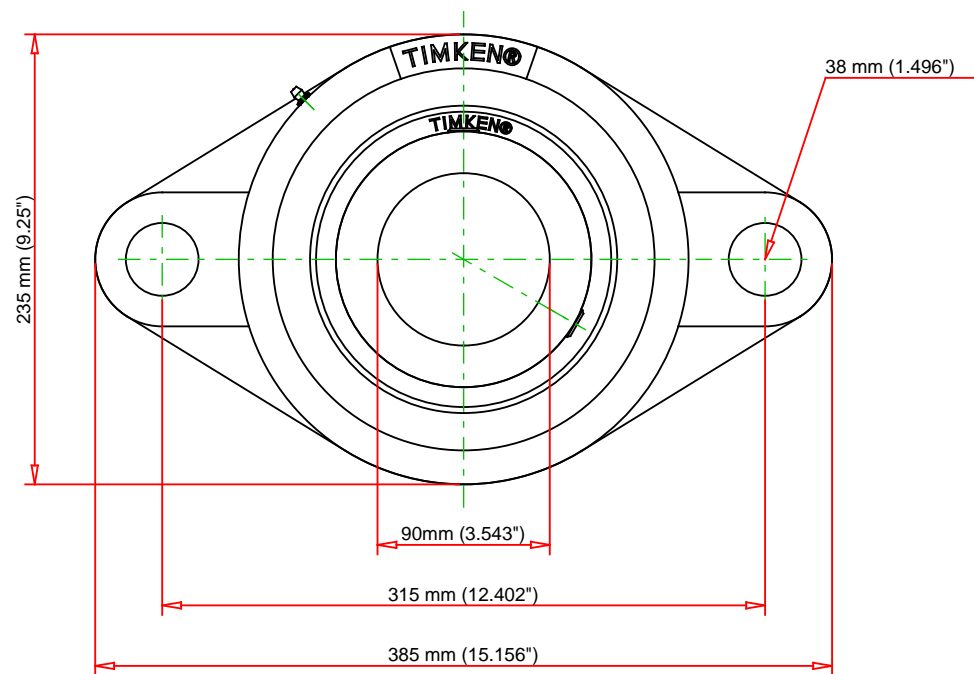
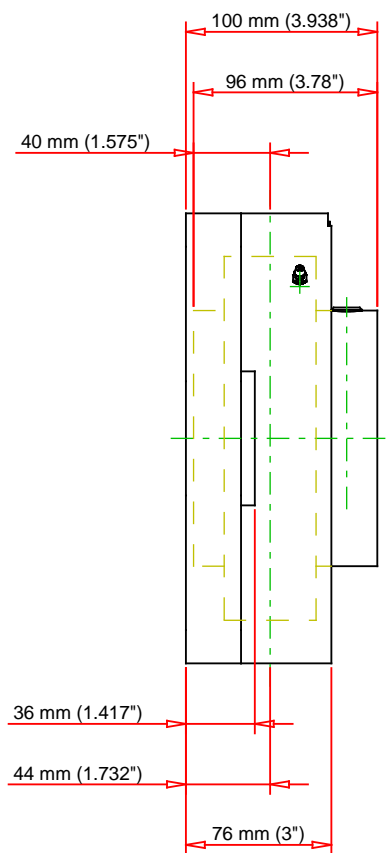

Bearing Number	UC318			
Load Ratings - C _r	32148	lbf	143000	N
Load Ratings - C _{0r}	24055	lbf	107000	N
Weight	41.9	lb	19	kg
Bolt Size	M33			

TIMKEN

THE TIMKEN COMPANY
NORTH CANTON, OHIO USA

UCFL318

UCFL 300 Two-Bolt Flanged Mounted
Bearings - Set Screw Locking

Every reasonable effort has been made to ensure the accuracy of the information contained in this writing, but no liability is accepted for errors, omissions or for any other reason.

FOR DISCUSSION ONLY