



FAG

SES528-L

Plummer block housing

Schaeffler ID:
0860886530000

Split plummer block housing for various bearing designs. The SNV series will be replaced by the new SES series in 2022.

Technical information

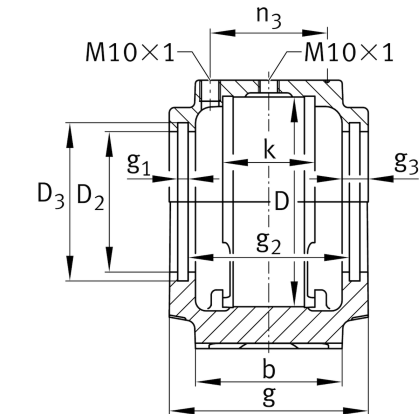
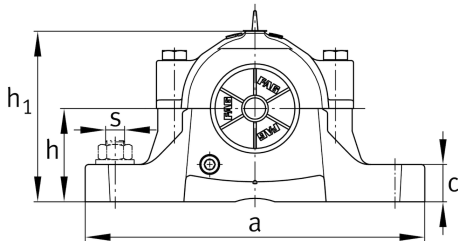
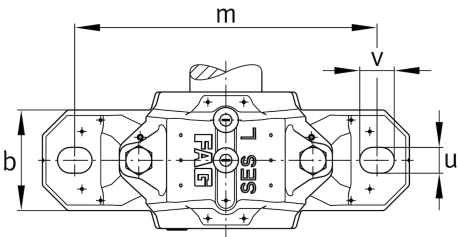

Main Dimensions & Performance Data

D	250 mm	outside diameter bearing
a	500 mm	length base
h ₁	302 mm	height
g	205 mm	width housing body
K	98 mm	Width bearing seat
	40.6 kg	Weight

Dimensions

b	150 mm	width base
c	50 mm	height base
h	150 mm	center height
m	420 mm	distance fixing bore
s	1.25	screw size
s	M30	size of fixing screws
u	35 mm	width slot
v	42 mm	length slot
D ₂	177.5 mm	diameter sealing
D ₃	187.5 mm	diameter sealing groove
D ₅	184.2 mm	Outside diameter sealing labyrinth
g ₁	6 mm	Width sealing groove
g ₂	183 mm	Distance sealing
g ₃	15 mm	Wall thickness
g ₄	40 mm	Distance oil lubrication
m ₁	360 mm	Distance holes aligned pins m1
n ₃	124 mm	Distance lubrication
n ₄	185 mm	Distance lubrication sealing
u ₁	12 mm	bore diameter u1
u ₂	26 mm	bore diameter u2