



Safety coupling with a self-venting system. Self-venting takes place during disconnection – no risk of pressurised hoses being tossed around. When the sleeve is pulled back, the plug is released yet remains locked in. The coupling valve closes and the air is vented from the air line at the same time. Only then, by operating the sleeve again, can uncoupling take place safely. The system fulfils the requirements of ISO 4414 – increased safety standards in the work place. DIN EN 983. Ultra High Flow valve for optimum flow and low pressure drop.

- Available on request:
 - with additional end connections

Safety Note

Reliable functioning can only be guaranteed in conjunction with original Parker Rectus plugs made of steel.

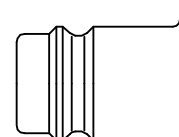

Euro Profile



KE Self-Venting System

Working Pressure*:
up to 12 bar

Material:

- Coupling: Nickel plated brass / steel
- Plug: Nickel plated steel
- Seals: NBR

Working Temperature:

-20°C up to +100°C (NBR)

Flow Rate Air:

3.500 l/min.

inlet pressure 6 bar, pressure drop 0.5 bar

* maximum static working pressure with design factor 4 to 1.



Self-Venting System

1700KEAW Coupler with valve, Male Thread

Nickel-plated brass/steel, NBR

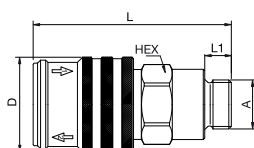

A		HEX	L	L1	D
G3/8	1700KEAW17SPN	24	67	9	32
G1/2	1700KEAW21SPN	24	70	12	32
G3/4	1700KEAW26SPN	30	74	16	32



Self-Venting System

27SFAK Plug without valve, Male Thread

Nickel-plated steel

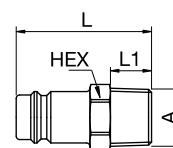

A		HEX	L	L1
R1/4	27SFAK13SXN	17	40	12
R3/8	27SFAK17SXN	17	40	12
R1/2	27SFAK21SXN	22	45	17
R3/4	27SFAK26SXN	27	48	19

1700KEIW Coupler with valve, Female Thread

Nickel-plated brass/steel, NBR

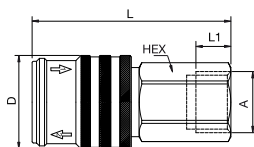

A		HEX	L	L1	D
G3/8	1700KEIW17SPN	24	64.5	12	32
G1/2	1700KEIW21SPN	24	68	12	32
G3/4	1700KEIW26SPN	32	74	16	32

27SFIW Plug without valve, Female Thread

Nickel-plated steel

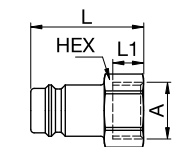

A		HEX	L	L1
G1/4	27SFIW13SXN	17	33	9
G3/8	27SFIW17SXN	9086 27 17	19	33
G1/2	27SFIW21SXN	9086 27 21	24	37
G3/4	27SFIW26SXN	9086 27 27	32	42