



**The Timken Company**

4500 Mt Pleasant St. NW

N. Canton, OH 44720

**Phone:** (234) 262-3000

**E-Mail:** [CustomerCAD@timken.com](mailto:CustomerCAD@timken.com) • **Web site:** [www.timken.com](http://www.timken.com)

## Part Number UCFL316, UCFL 300 Two-Bolt Flanged Mounted Bearings - Set Screw Locking

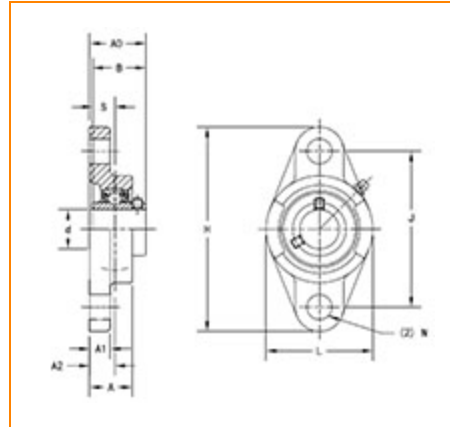

[Specifications](#) | [Dimensions](#) | [Basic Load Ratings](#)

### Specifications

<b>Bearing Number</b>	UC316
<b>Shaft Size d</b>	80 mm
<b>Locking Style</b>	Set Screw Locking
<b>Housing Construction</b>	Two-Bolt Flange

### Dimensions

<b>Total Length H</b>	355 mm 13.969 in
<b>Total Height L</b>	210 mm 8.281 in



<b>Housing Width A</b>	68 mm 2.688 in
<b>Bolt Hole Spacing J</b>	285 mm 11.22 in
<b>Bolt Hole Size N</b>	38 mm 1.496 in
<b>Flange Thickness A1</b>	32 mm 1.26 in
<b>Center of Bearing from Housing End A2</b>	38 mm 1.496 in
<b>Inner Ring Width B</b>	86 mm 3.386 in
<b>Center of Bearing from Bearing End S</b>	34 mm 1.339 in
<b>Dimension A0</b>	90 mm 3.547 in
<b>Bolt Size</b>	M33

## Basic Load Ratings

<b>Static Load Rating</b>	86700 N 19491 lbf
<b>Dynamic Load Rating</b>	123000 N 27652 lbf

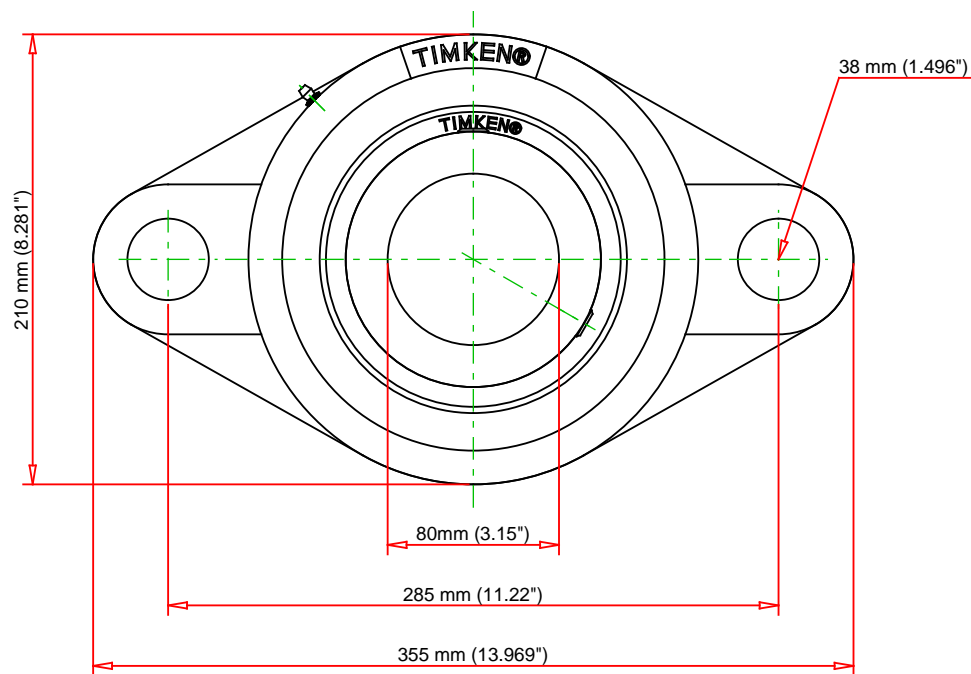
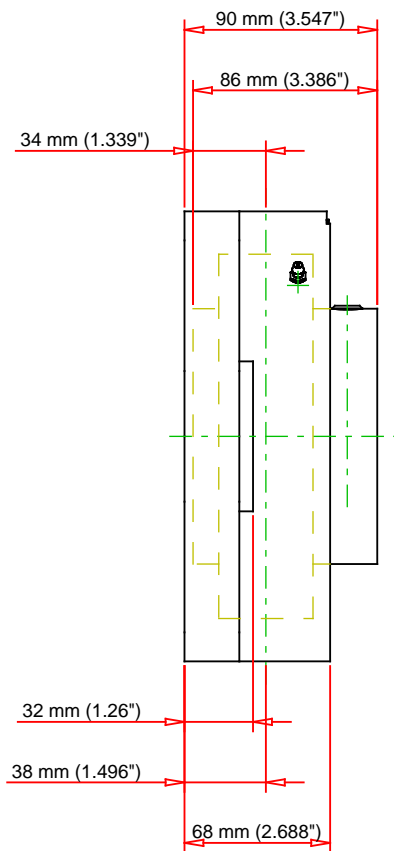

Bearing Number	UC316			
Load Ratings - C <sub>r</sub>	27652	lbf	123000	N
Load Ratings - C <sub>0r</sub>	19491	lbf	86700	N
Weight	31.7	lb	14.4	kg
Bolt Size	M33			

**TIMKEN**

THE TIMKEN COMPANY  
NORTH CANTON, OHIO USA

**UCFL316**  
UCFL 300 Two-Bolt Flanged Mounted  
Bearings - Set Screw Locking

Every reasonable effort has been made to ensure the accuracy of the information contained in this writing, but no liability is accepted for errors, omissions or for any other reason.

**FOR DISCUSSION ONLY**