



**LOCKNUT-SOCKET-KM11** [🔗](#)

Locknut socket wrench

for locknuts and precision locknuts

Technical information

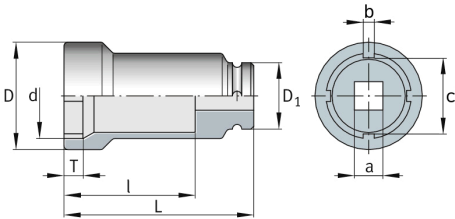

Dimensions

d	75.7 mm	
D	83.5 mm	
D <sub>1</sub>	44 mm	
L	90 mm	
l	60 mm	
T	13.5 mm	
a	3/4"	Square (inch)
b	6.7 mm	
c	69.8 mm	
≈m	0.9 kg	Weight

Additional information

KM11	suitable for locknuts
ZM55	suitable for precision locknuts
1 pc. socket wrench with locking pin and rubber washer	included in delivery