



The Timken Company

4500 Mt Pleasant St. NW

N. Canton, OH 44720

Phone: (234) 262-3000

E-Mail: CustomerCAD@timken.com • **Web site:** www.timken.com

Part Number UC218, UC 200 Wide Inner Ring Ball Bearings - Set Screw Locking

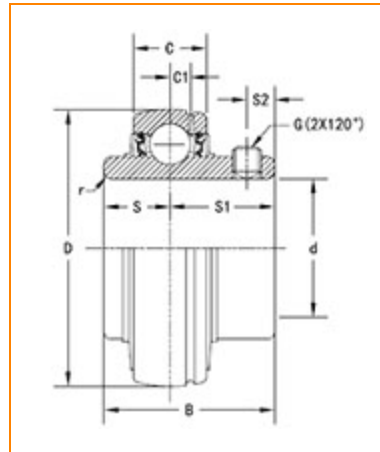

[Specifications](#) | [Dimensions](#) | [Basic Load Ratings](#)

Specifications

Bore Type	Cylindrical bore
Bearing Type	Ball Bearing
Shaft Size d	90 mm
Locking Device	Set Screw Locking

Dimensions

Outside Diameter D	160.000 mm 6.2990 in
Outside Ring Width C	38 mm 1.496 in
Fillet Radius r	2.0 mm 0.079 in





Groove Position C1	11.1 mm 0.437 in
Center of Bearing from End S	39.7 mm 1.563 in
Dimension S1	56.3 mm 2.217 in
Set Screw Distance S2	15 mm 0.591 in
Set Screw Size	M12×1.5
Number of Set Screws	2
Angle between Set Screws	120 °

Basic Load Ratings

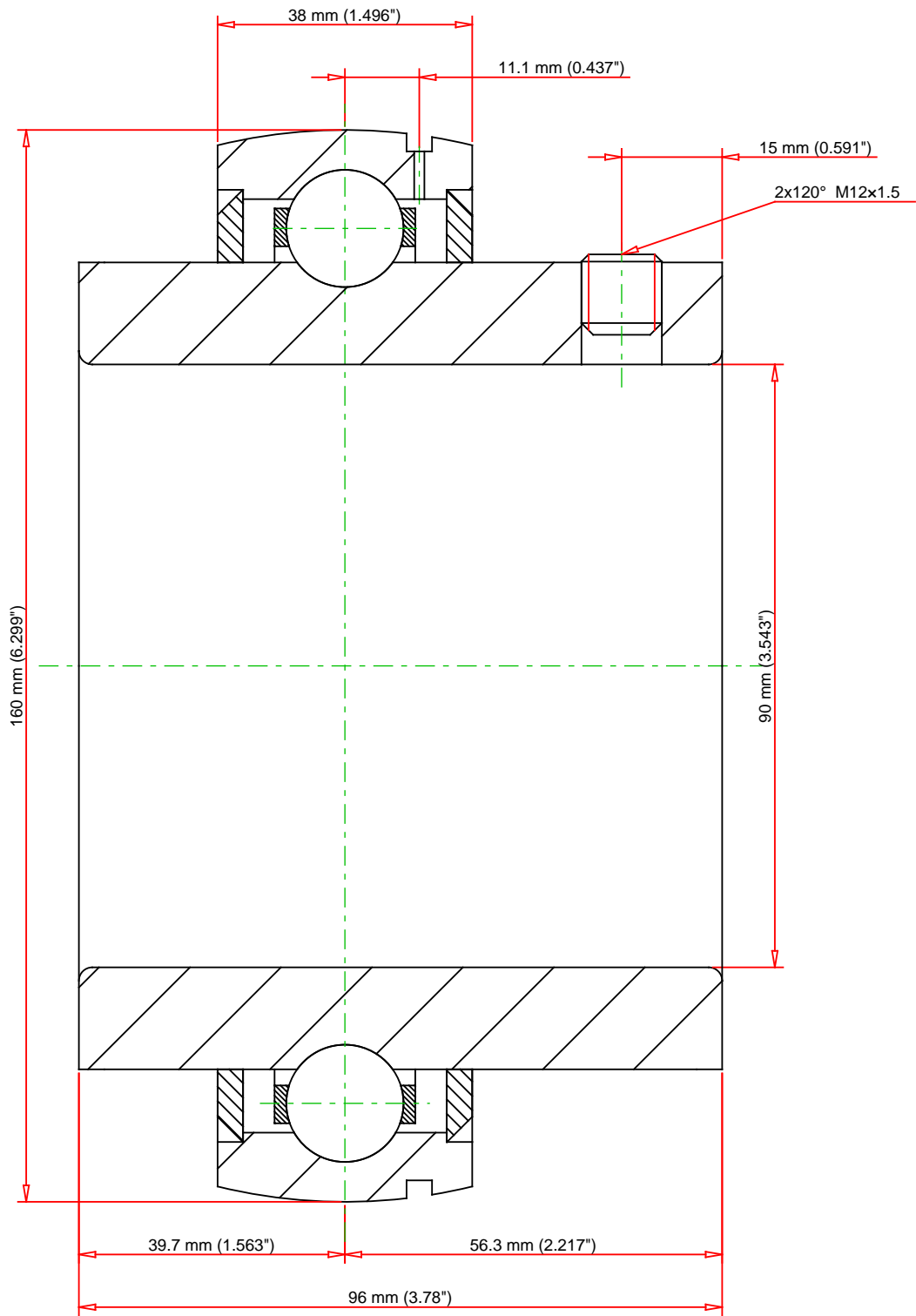
Static Load Rating	71500 N 16074 lbf
Dynamic Load Rating	96100 N 21604 lbf



Weight	9.6 lb	4.4 kg		<div>UC218</div> <div>UC 200 Wide Inner Ring Ball Bearings - Set Screw Locking</div>
				
			<div>Basic Load Ratings - C_r</div> <div>21604 lbf</div> <div>96100 N</div>	
			<div>Load Ratings - C_{0r}</div> <div>16074 lbf</div> <div>71500 N</div>	
Every reasonable effort has been made to ensure the accuracy of the information contained in this writing, but no liability is accepted for errors, omissions or for any other reason.				FOR DISCUSSION ONLY