



The Timken Company

4500 Mt Pleasant St. NW

N. Canton, OH 44720

Phone: (234) 262-3000

E-Mail: CustomerCAD@timken.com • **Web site:** www.timken.com

Part Number UCFL315, UCFL 300 Two-Bolt Flanged Mounted Bearings - Set Screw Locking

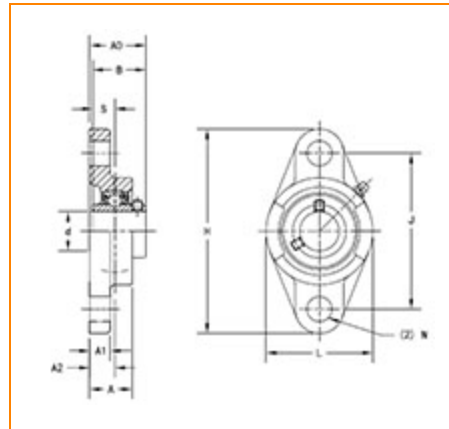

[Specifications](#) | [Dimensions](#) | [Basic Load Ratings](#)

Specifications

Bearing Number	UC315
Shaft Size d	75 mm
Locking Style	Set Screw Locking
Housing Construction	Two-Bolt Flange

Dimensions

Total Length H	320 mm
Total Height L	195 mm
Housing Width A	66 mm
Bolt Hole Spacing J	260 mm
Bolt Hole Size N	35 mm



Flange Thickness A1	30 mm
Center of Bearing from Housing End A2	39 mm
Inner Ring Width B	82 mm
Center of Bearing from Bearing End S	32 mm
Dimension A0	89 mm
Bolt Size	M30

Basic Load Ratings

Static Load Rating	77200 N
Dynamic Load Rating	113000 N

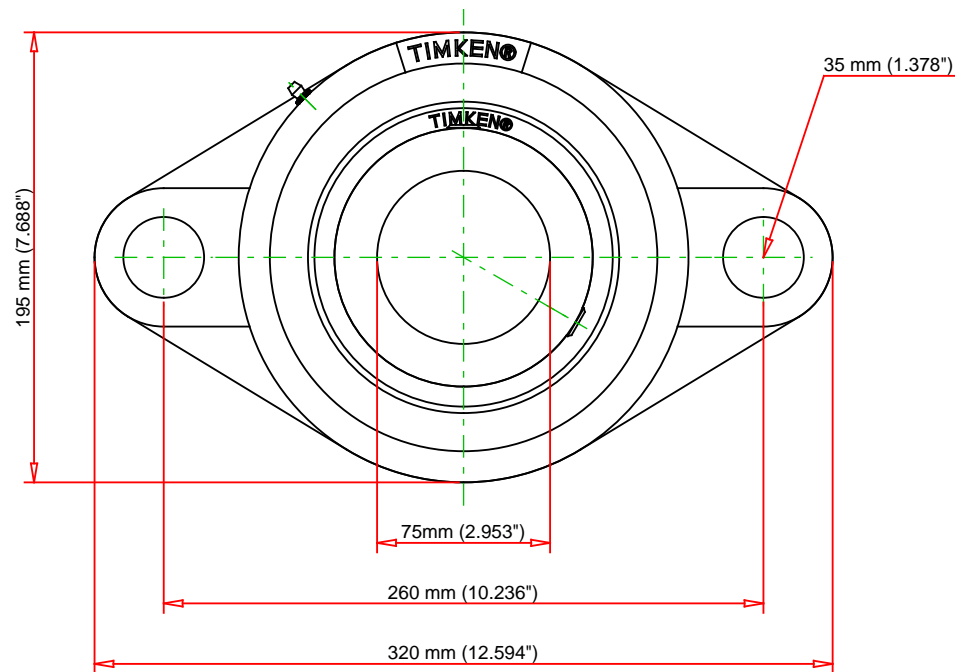
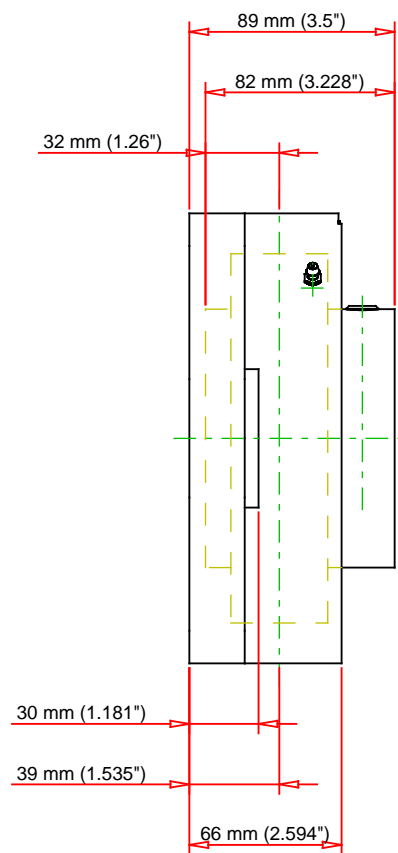

Bearing Number	UC315			
Load Ratings - C _r	25404	lbf	113000	N
Load Ratings - C _{0r}	17355	lbf	77200	N
Weight	24.9	lb	11.3	kg
Bolt Size	M30			

TIMKEN

THE TIMKEN COMPANY
NORTH CANTON, OHIO USA

UCFL315
UCFL 300 Two-Bolt Flanged Mounted
Bearings - Set Screw Locking

Every reasonable effort has been made to ensure the accuracy of the information contained in this writing, but no liability is accepted for errors, omissions or for any other reason.

FOR DISCUSSION ONLY