



The Timken Company

4500 Mt Pleasant St. NW

N. Canton, OH 44720

Phone: (234) 262-3000

E-Mail: CustomerCAD@timken.com • **Web site:** www.timken.com

Housing – Bearing – Seal SNT 520-617 - 22220K - TSNG520, SNT Taper Bore Plummer Block Housed Units

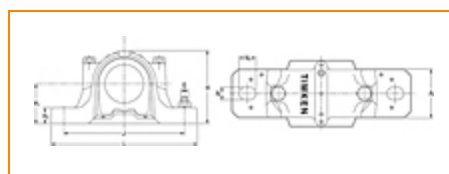

[Types of Components](#) | [Housing](#) | [Bearing](#) | [Dimensions](#) | [Specifications](#)

Types of Components

Housing	SNT 520-617
Bearing	22220K
Locating Rings (width x OD)	SR180X12
Seal Type	Double Lip
Seal	TSNG520
Adapter Sleeve ¹	H320
Locknut	KM20
Lockwasher	MB20
End Cover ²	EC520-617

Housing

Material	Cast Iron
Housing Mass	17.6 Kg
Bolt Qty	2

Bearing

Cage Type	EJ
C1 Dynamic Load Rating	435
C0 Static Load Rating	502
Max Oil Speed	3800
Max Grease Speed	3100

Dimensions

Shaft Diameter d	90 mm
A	160.00 mm
A1	110 mm
G	M24
H	218 mm
H1	112.0 mm
H2	40 mm
J	320.00 mm
Jmax	326 mm
Jmin	314 mm
L	380.00 mm
N	26 mm

N1

32.00 mm

Specifications

UPC Code	999999999
Alternate Part Name	SNT520-617 - 22220K - TSNG520

¹ Purchase the Adapter Sleeve separately

² Two seals are required for a thru shaft application. One end cover can be used if application is not a thru shaft design. In this case, only one seal is required.

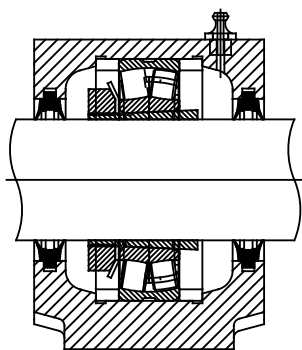
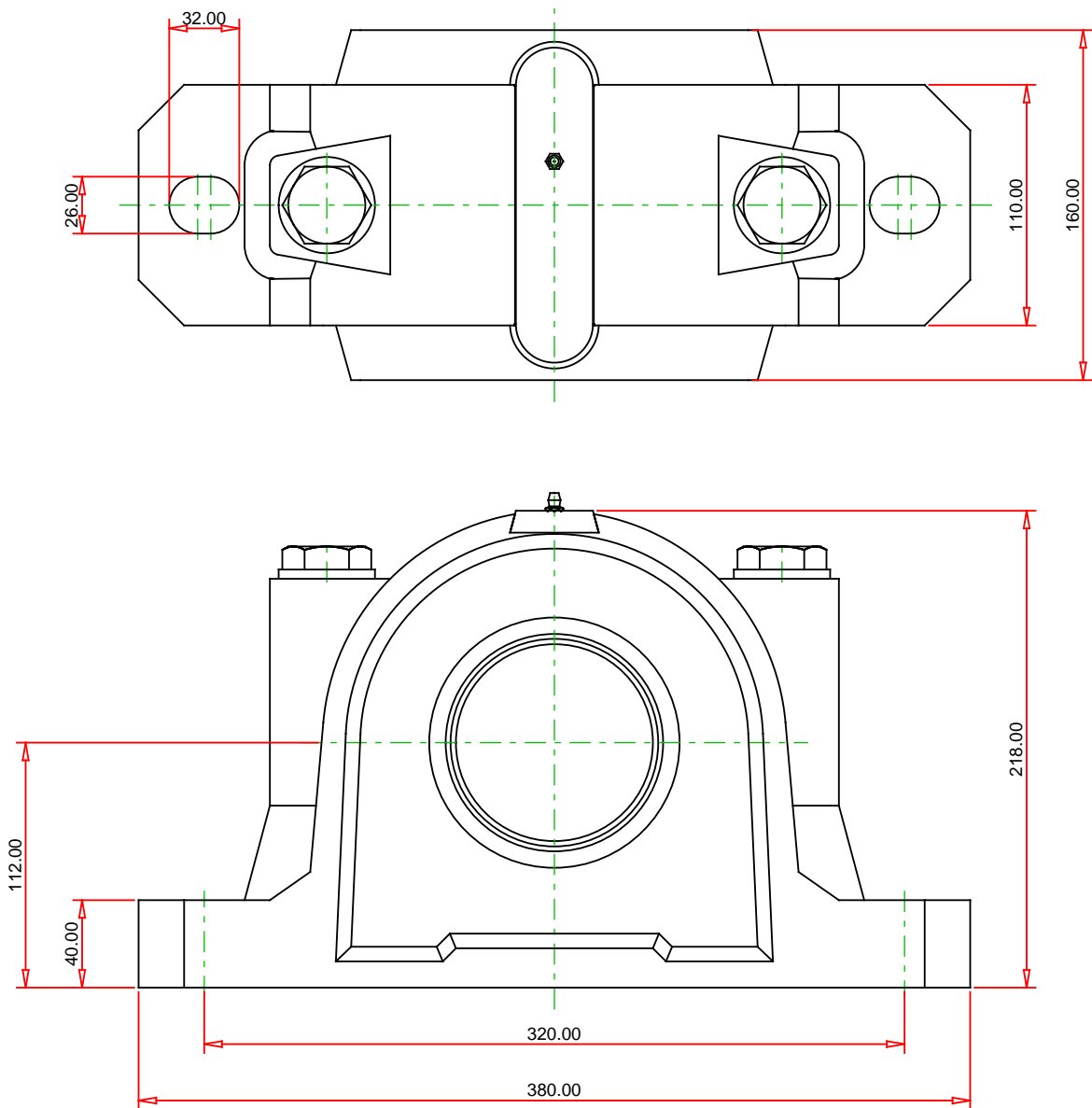

Note: Section View not to Scale

METRIC UNITS

Housing
Bearing
Seal (Quantity 2)
Seal Type
Locating Ring (Quantity 2)
Adapter Sleeve
(includes 1 sleeve, 1 locknut
and 1 lockwasher)

SNT 520-617
22220K
TSNG520
Double Lip
SR180X12
H320

TIMKEN®

THE TIMKEN COMPANY
NORTH CANTON, OHIO USA

SNT 520-617 - 22220K - TSNG520
SNT Taper Bore Plummer Block Housing Units

C1 Dynamic Load Rating (2 rows)	435 kN
C0 Static Load Rating	502 kN
Max Oil Speed	3800 RPM
Max Grease Speed	3100 RPM
Material	Cast Iron

Every reasonable effort has been made to ensure the accuracy of the information contained in this writing, but no liability is accepted for errors, omissions or for any other reason.

FOR DISCUSSION ONLY