



The Timken Company

4500 Mt Pleasant St. NW

N. Canton, OH 44720

Phone: (234) 262-3000

E-Mail: CustomerCAD@timken.com • **Web site:** www.timken.com

Part Number 1329, Tapered Roller Bearings - Single Cups - Imperial

This is the most basic and most widely used type of tapered roller bearing. It consists of two main separable parts: the cone (inner ring) assembly and the cup (outer ring). It is typically mounted in opposing pairs on a shaft.

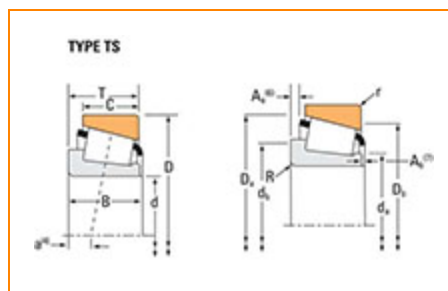

[Specifications](#) | [Dimensions](#) | [Abutment and Fillet Dimensions](#) | [Factors](#)

Specifications

Series	1300
Cup Part Number	1329
Design Units	Imperial

Dimensions

D - Cup Outer Diameter	2.1250 in 53.975 mm
C - Cup Width	0.5625 in 14.288 mm

Abutment and Fillet Dimensions

r - Cup Backface "To Clear" Radius¹	0.06 in 1.52 mm
Da - Cup Frontface Backing Diameter	1.95 in 49.53 mm
Db - Cup Backface Backing Diameter	1.81 in 45.97 mm

Factors

K - Factor²	2
e - ISO Factor³	0.29
Y - ISO Factor⁴	2.05
G1 - Heat Generation Factor (Roller-Raceway)	10.3
G2 - Heat Generation Factor (Rib-Roller End)	5.2
Cg - Geometry Factor⁵	0.0508

¹ These maximum fillet radii will be cleared by the bearing corners.

² These factors apply for both inch and metric calculations. Consult your Timken representative for instruction on use.

³ These factors apply for both inch and metric calculations. Consult your Timken representative for instruction on use.

⁴ These factors apply for both inch and metric calculations. Consult your Timken representative for instruction on use.

⁵ Geometry constant for Lubrication Life Adjustment Factor a3l.

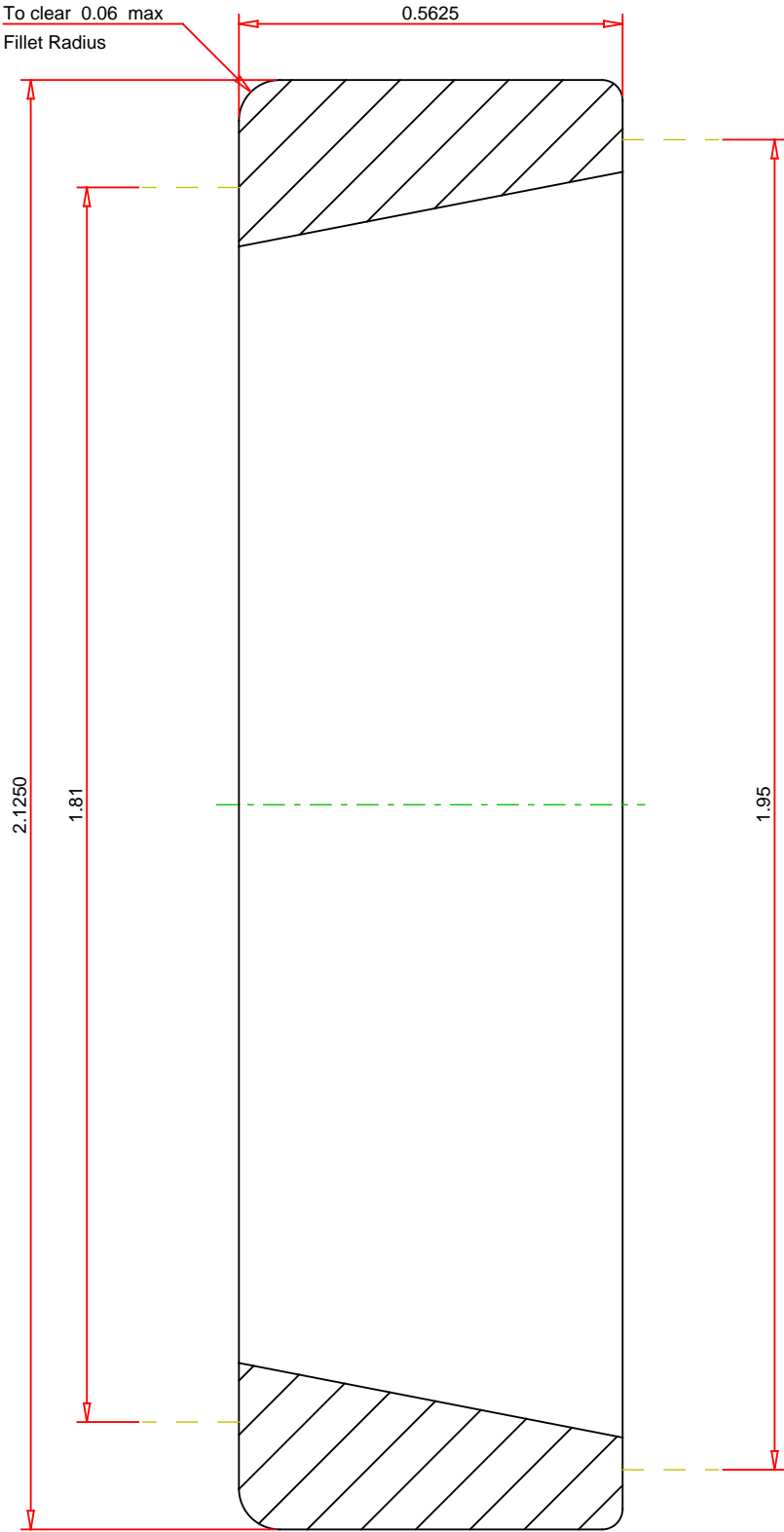

IMPERIAL UNITS

TIMKEN®

THE TIMKEN COMPANY
NORTH CANTON, OHIO USA

1329
SINGLE TAPERED CUP