



**The Timken Company**

4500 Mt Pleasant St. NW

N. Canton, OH 44720

**Phone:** (234) 262-3000

**E-Mail:** [CustomerCAD@timken.com](mailto:CustomerCAD@timken.com) • **Web site:** [www.timken.com](http://www.timken.com)

## Part Number UC217, UC 200 Wide Inner Ring Ball Bearings - Set Screw Locking

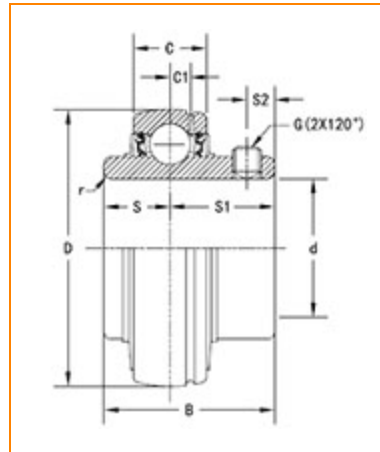

[Specifications](#) | [Dimensions](#) | [Basic Load Ratings](#)

### Specifications

<b>Bore Type</b>	Cylindrical bore
<b>Bearing Type</b>	Ball Bearing
<b>Shaft Size d</b>	85 mm
<b>Locking Device</b>	Set Screw Locking

### Dimensions

<b>Outside Diameter D</b>	150 mm 5.906 in
<b>Outside Ring Width C</b>	35 mm 1.3780 in
<b>Radius r</b>	2.0 mm 0.079 in



<b>Groove Position C1</b>	9.8 mm 0.386 in
<b>Center of Bearing from End S</b>	34.1 mm 1.343 in
<b>Dimension S1</b>	51.6 mm 2.031 in
<b>Set Screw Distance S2</b>	14 mm 0.551 in
<b>Set Screw Size</b>	M12×1.5
<b>Number of Set Screws</b>	2
<b>Angle between Set Screws</b>	120 °

## Basic Load Ratings

<b>Static Load Rating</b>	61900 N 13916 lbf
<b>Dynamic Load Rating</b>	84000 N 18884 lbf

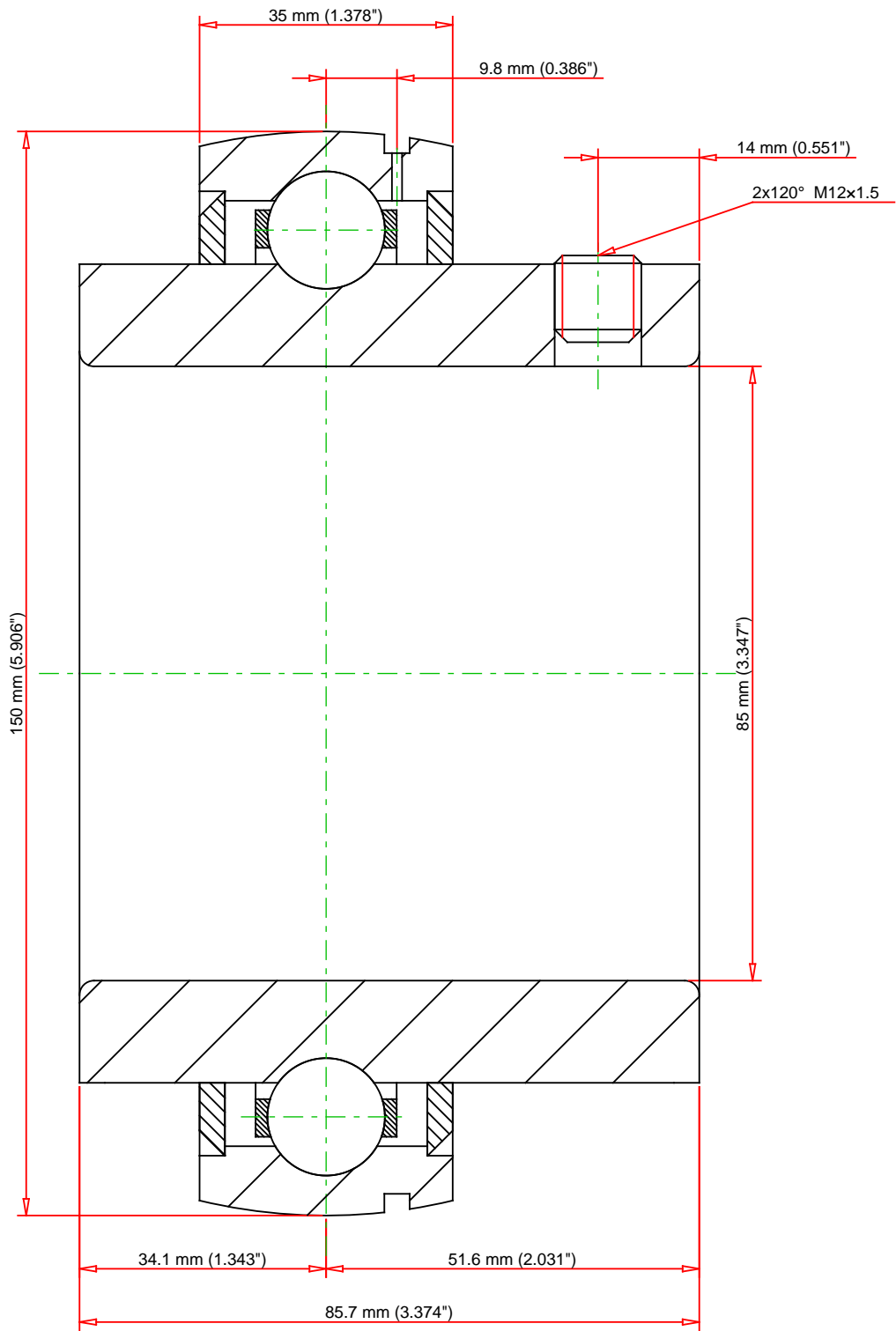

Weight	7.6 lb	3.5 kg	<div>TIMKEN®</div> <div>THE TIMKEN COMPANY</div> <div>NORTH CANTON, OHIO USA</div>	<div>UC217</div> <div>UC 200 Wide Inner Ring Ball Bearings - Set Screw Locking</div>		
				Basic Load Ratings - C <sub>r</sub>	18884 lbf	84000 N
				Load Ratings - C <sub>0r</sub>	13916 lbf	61900 N
Every reasonable effort has been made to ensure the accuracy of the information contained in this writing, but no liability is accepted for errors, omissions or for any other reason.				FOR DISCUSSION ONLY		