



LOCKNUT-SOCKET-KM16 [🔗](#)

Locknut socket wrench

for locknuts and precision locknuts

Technical information

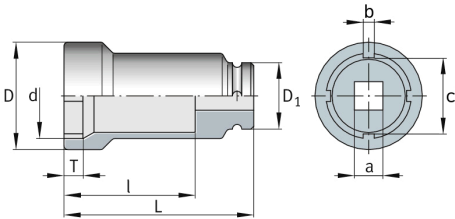

Dimensions

d	105.8 mm	
D	116 mm	
D ₁	62 mm	
L	110 mm	
l	80 mm	
T	15 mm	
a	1"	Square (inch)
b	7.6 mm	
c	98.9 mm	
≈m	2.1 kg	Weight

Additional information

KM16	suitable for locknuts
ZMA65/105, ZM80	suitable for precision locknuts
1 pc. socket wrench	included in delivery
with locking pin and	
rubber washer	