



**The Timken Company**

4500 Mt Pleasant St. NW

N. Canton, OH 44720

**Phone:** (234) 262-3000

**E-Mail:** [CustomerCAD@timken.com](mailto:CustomerCAD@timken.com) • **Web site:** [www.timken.com](http://www.timken.com)

## Housing – Bearing – Seal SNT 519-616 - 22316 - LO316, SNT Cylindrical Bore Plummer Block Housed Units

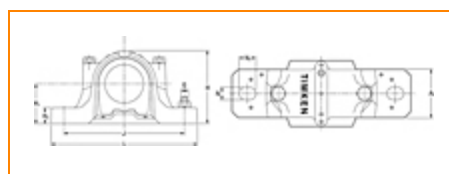

[Types of Components](#) | [Housing](#) | [Bearing](#) | [Dimensions](#) | [Specifications](#)

### Types of Components

Housing	SNT 519-616
Bearing	22316
Locating Rings (width x OD)	SR170X5
Seal Type	Labyrinth
Seal	LO316
End Cover <sup>1</sup>	EC519-616

### Housing

Material	Cast Iron
Bolt Qty	2
Housing Mass	14 Kg

## Bearing



Cage Type	EJ
C1 Dynamic Load Rating	522
C0 Static Load Rating	570
Max Oil Speed	3700
Max Grease Speed	3200

## Dimensions



Shaft Diameter da	80 mm
Shaft Diameter db	90 mm
A	145.00 mm
A1	100 mm
A2	163 mm
G	M20
H	212 mm
H1	112.0 mm
H2	35.0 mm
Jmax	295 mm
Jmin	285 mm
J	290.00 mm
L	345.00 mm
N1	28 mm
N	22 mm

## Specifications

UPC Code	9999999999
Alternate Part Name	SNT519-616 - 22316 - LO316

<sup>1</sup> Two seals are required for a thru shaft application. One end cover can be used if application is not a thru shaft design. In this case, only one seal is required.

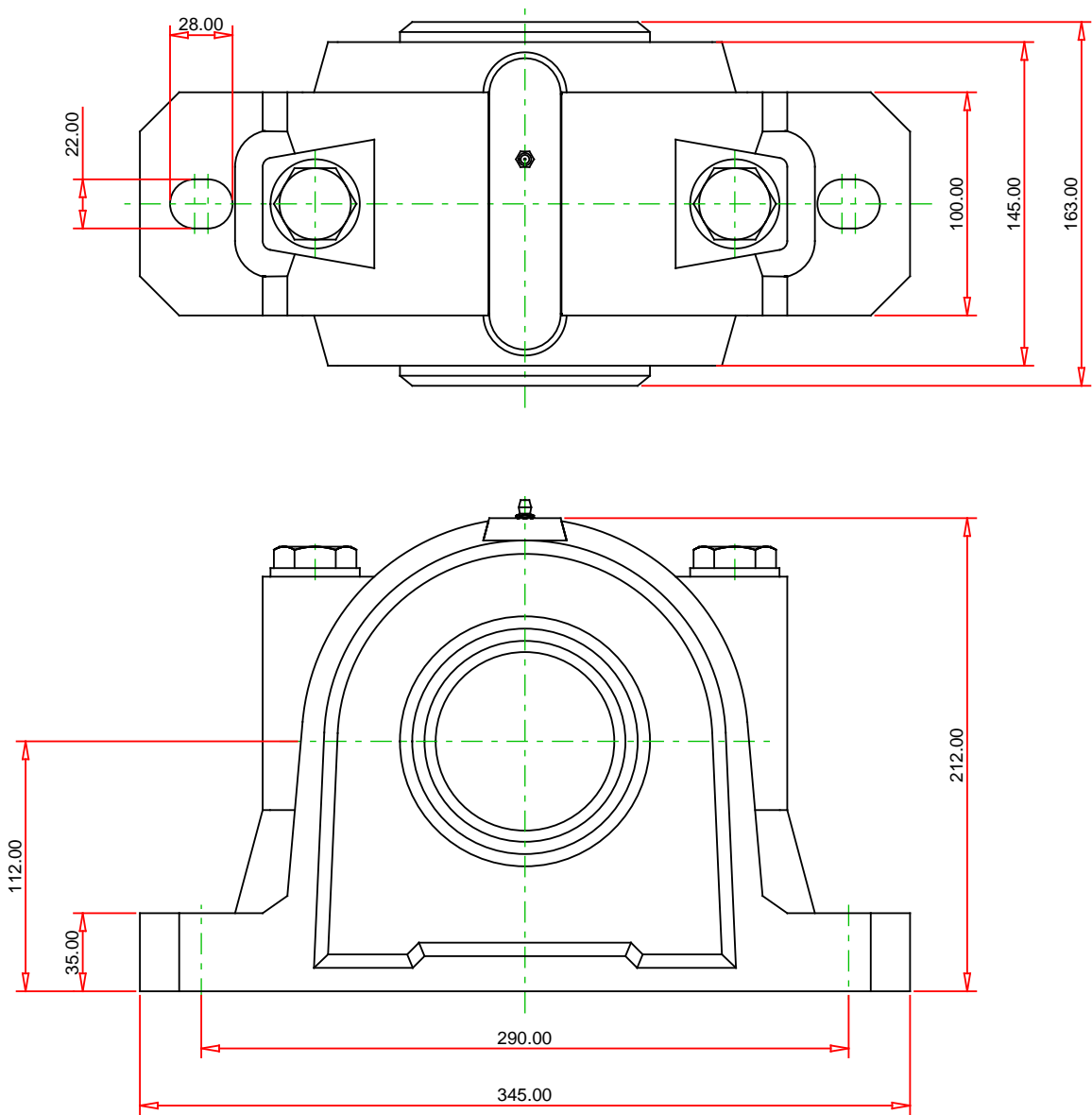

Note: Section View not to Scale

METRIC UNITS

<div><div>HousingSNT 519-616</div><div>Bearing22316</div><div>Seal (Quantity 2)LO316</div><div>Seal TypeLabyrinth</div><div>Locating Ring (Quantity 2)SR170X5</div></div>		<div><div>TIMKEN®</div><div>THE TIMKEN COMPANY</div><div>NORTH CANTON, OHIO USA</div></div>		<div><div>SNT 519-616 - 22316 - LO316</div><div>SNT Cylindrical Bore Plummer Block Housed Units</div></div>	
				C1 Dynamic Load Rating (2 rows)	522 kN
				C0 Static Load Rating	570 kN
				Max Oil Speed	3700 RPM
				Max Grease Speed	3200 RPM
				Material	Cast Iron