



**The Timken Company**

4500 Mt Pleasant St. NW

N. Canton, OH 44720

**Phone:** (234) 262-3000

**E-Mail:** [CustomerCAD@timken.com](mailto:CustomerCAD@timken.com) • **Web site:** [www.timken.com](http://www.timken.com)

## Part Number UC216, UC 200 Wide Inner Ring Ball Bearings - Set Screw Locking

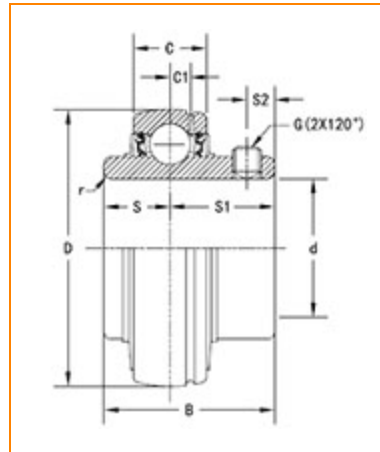

[Specifications](#) | [Dimensions](#) | [Basic Load Ratings](#)

### Specifications

<b>Bore Type</b>	Cylindrical bore
<b>Bearing Type</b>	Ball Bearing
<b>Shaft Size d</b>	80 mm
<b>Locking Device</b>	Set Screw Locking

### Dimensions

<b>Outside Diameter D</b>	140.000 mm 5.512 in
<b>Outside Ring Width C</b>	33 mm 1.299 in
<b>Fillet Radius r</b>	2.0 mm 0.079 in



<b>Groove Position C1</b>	8.9 mm 0.350 in
<b>Center of Bearing from End S</b>	33.3 mm 1.311 in
<b>Dimension S1</b>	49.3 mm 1.941 in
<b>Set Screw Distance S2</b>	14 mm 0.551 in
<b>Set Screw Size</b>	M12×1.5
<b>Number of Set Screws</b>	2
<b>Angle between Set Screws</b>	120 °

## Basic Load Ratings

<b>Static Load Rating</b>	53000 N 11915 lbf
<b>Dynamic Load Rating</b>	72700 N 16344 lbf

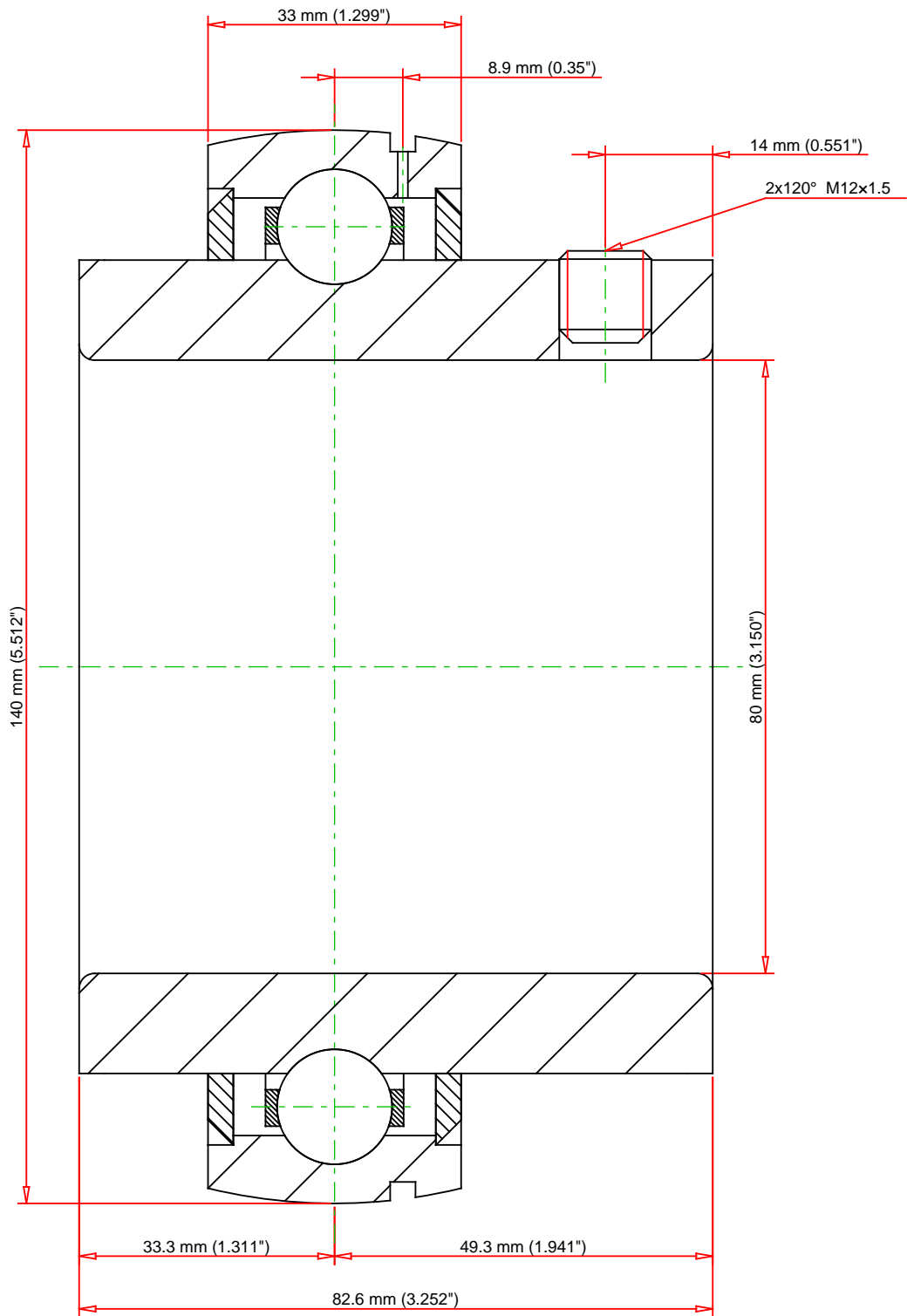

Weight	6.3 lb	2.8 kg	<div>TIMKEN®</div> <div>THE TIMKEN COMPANY</div> <div>NORTH CANTON, OHIO USA</div>			<div>UC216</div> <div>UC 200 Wide Inner Ring Ball Bearings - Set Screw Locking</div>		
						Basic Load Ratings - C <sub>r</sub>		
			Load Ratings - C <sub>0r</sub>			11915 lbf	53000 N	
Every reasonable effort has been made to ensure the accuracy of the information contained in this writing, but no liability is accepted for errors, omissions or for any other reason.						FOR DISCUSSION ONLY		