



The Timken Company

4500 Mt Pleasant St. NW

N. Canton, OH 44720

Phone: (234) 262-3000

E-Mail: CustomerCAD@timken.com • **Web site:** www.timken.com

Part Number UCFL313, UCFL 300 Two-Bolt Flanged Mounted Bearings - Set Screw Locking

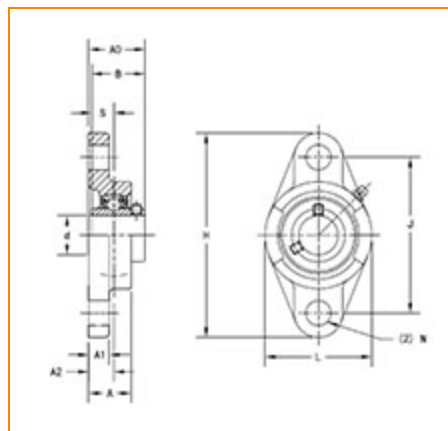

[Specifications](#) | [Dimensions](#) | [Basic Load Ratings](#)

Specifications

Bearing Number	UC313
Shaft Size d	65 mm
Locking Style	Set Screw Locking
Housing Construction	Two-Bolt Flange

Dimensions

Total Length H	295 mm 11.625 in
Total Height L	175 mm 6.875 in



Housing Width A 58 mm
2.281 in

Bolt Hole Spacing J 240 mm
9.449 in

Bolt Hole Size N 31 mm
1.22 in

Flange Thickness A1 25 mm
0.984 in

Center of Bearing from Housing End A2 33 mm
1.299 in

Inner Ring Width B 75 mm
2.953 in

Center of Bearing from Bearing End S 30 mm
1.181 in

Dimension A0 78 mm
3.078 in

Bolt Size M27

Basic Load Ratings

Static Load Rating 59900 N
13466 lbf

Dynamic Load Rating 92700 N
20840 lbf

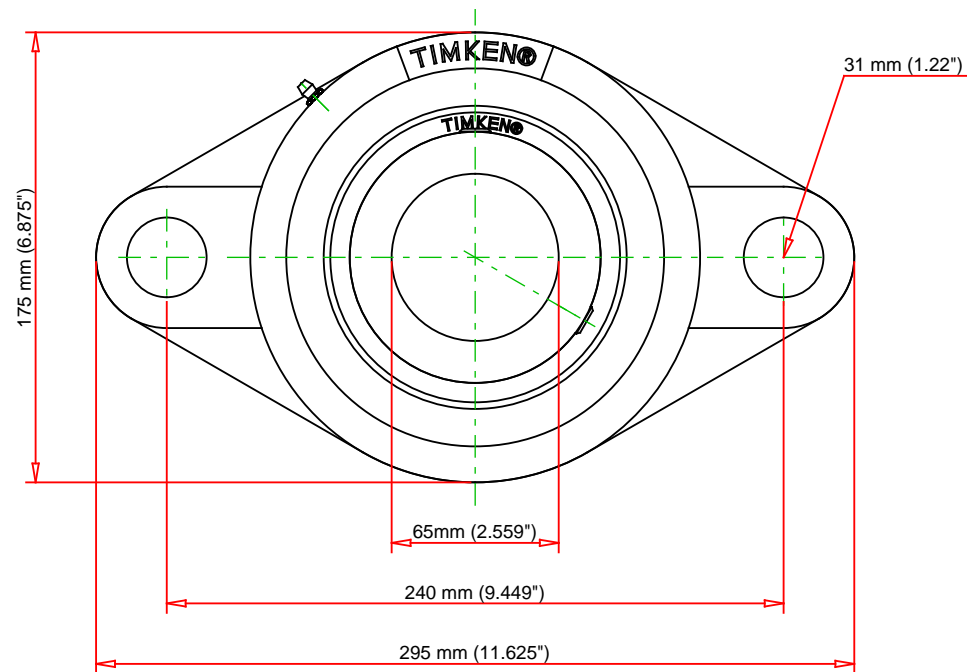
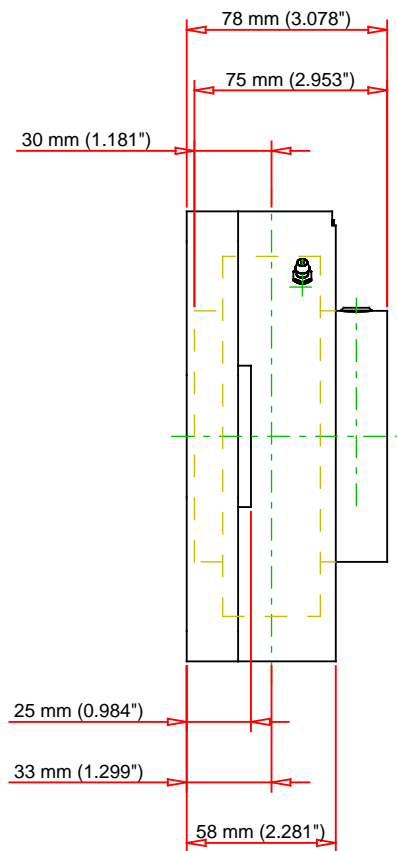

Bearing Number	UC313			
Load Ratings - C _r	20840	lbf	92700	N
Load Ratings - C _{0r}	13466	lbf	59900	N
Weight	18.7	lb	8.5	kg
Bolt Size	M27			

TIMKEN

THE TIMKEN COMPANY
NORTH CANTON, OHIO USA

UCFL313
UCFL 300 Two-Bolt Flanged Mounted
Bearings - Set Screw Locking

Every reasonable effort has been made to ensure the accuracy of the information contained in this writing, but no liability is accepted for errors, omissions or for any other reason.

FOR DISCUSSION ONLY