



**The Timken Company**

4500 Mt Pleasant St. NW

N. Canton, OH 44720

**Phone:** (234) 262-3000

**E-Mail:** [CustomerCAD@timken.com](mailto:CustomerCAD@timken.com) • **Web site:** [www.timken.com](http://www.timken.com)

## Part Number UCFL312, UCFL 300 Two-Bolt Flanged Mounted Bearings - Set Screw Locking

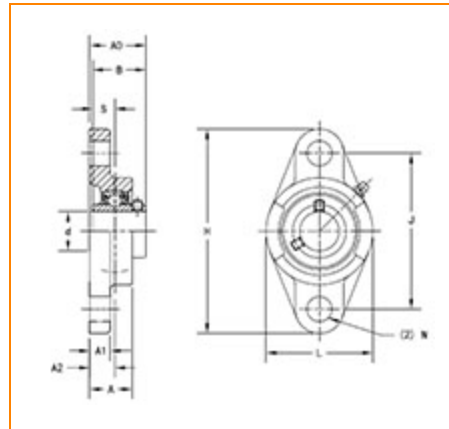

[Specifications](#) | [Dimensions](#) | [Basic Load Ratings](#)

### Specifications

<b>Bearing Number</b>	UC312
<b>Shaft Size d</b>	60 mm
<b>Locking Style</b>	Set Screw Locking
<b>Housing Construction</b>	Two-Bolt Flange

### Dimensions

<b>Total Length H</b>	270 mm
<b>Total Height L</b>	160 mm
<b>Housing Width A</b>	56 mm
<b>Bolt Hole Spacing J</b>	212 mm
<b>Bolt Hole Size N</b>	31 mm



Flange Thickness A1	22 mm
Center of Bearing from Housing End A2	33 mm
Inner Ring Width B	71 mm
Center of Bearing from Bearing End S	26 mm
Dimension A0	78 mm
Bolt Size	M27

## Basic Load Ratings

Static Load Rating	52200 N
Dynamic Load Rating	81900 N

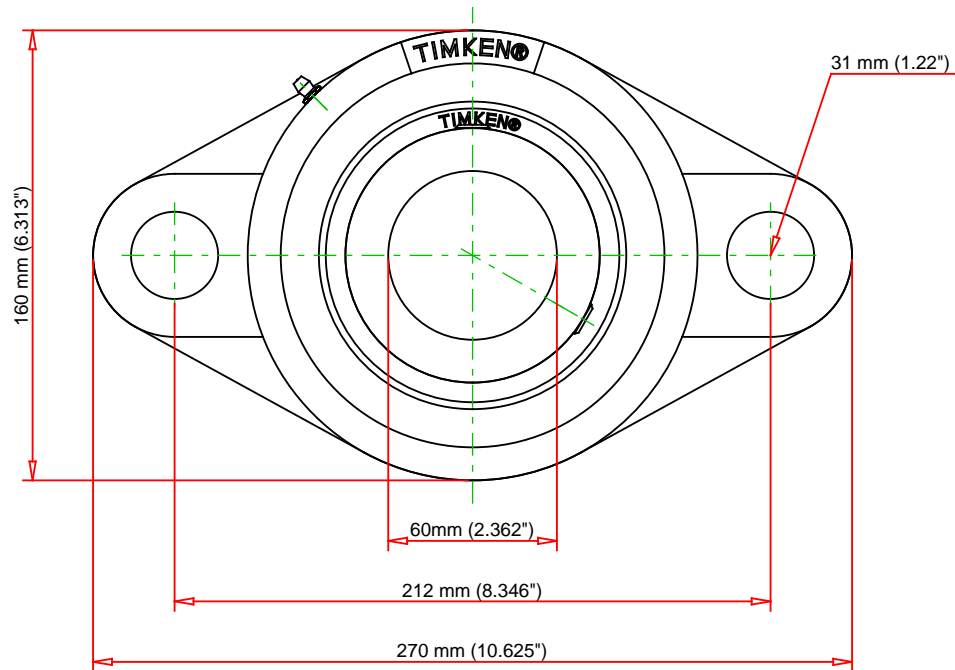
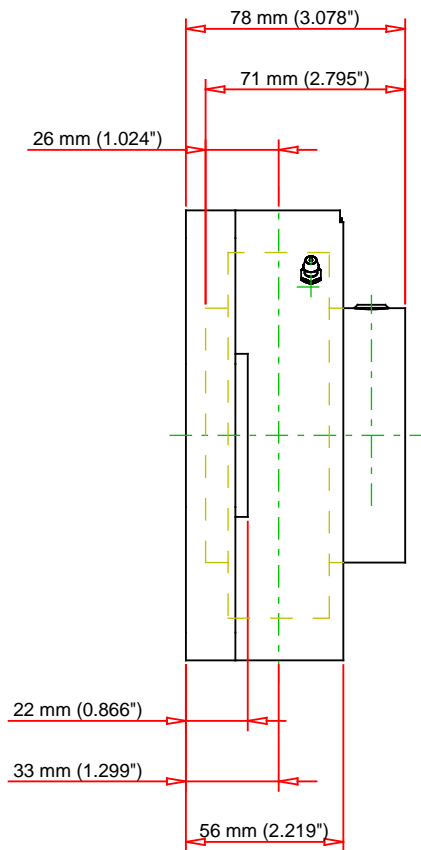

Bearing Number	UC312			
Load Ratings - C <sub>r</sub>	18412	lbf	81900	N
Load Ratings - C <sub>0r</sub>	11735	lbf	52200	N
Weight	14.3	lb	6.5	kg
Bolt Size	M27			

**TIMKEN**

THE TIMKEN COMPANY  
NORTH CANTON, OHIO USA

**UCFL312**  
UCFL 300 Two-Bolt Flanged Mounted  
Bearings - Set Screw Locking

Every reasonable effort has been made to ensure the accuracy of the information contained in this writing, but no liability is accepted for errors, omissions or for any other reason.

**FOR DISCUSSION ONLY**