



The Timken Company

4500 Mt Pleasant St. NW

N. Canton, OH 44720

Phone: (234) 262-3000

E-Mail: CustomerCAD@timken.com • **Web site:** www.timken.com

Housing – Bearing – Seal SNT 512-610 - 22310 - LO310, SNT Cylindrical Bore Plummer Block Housed Units

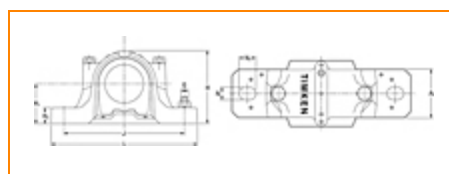

[Types of Components](#) | [Housing](#) | [Bearing](#) | [Dimensions](#) | [Specifications](#)

Types of Components

Housing	SNT 512-610
Bearing	22310
Locating Rings (width x OD)	SR110X4
Seal Type	Labyrinth
Seal	LO310
End Cover ¹	EC512-610

Housing

Material	Cast Iron
Bolt Qty	2
Housing Mass	5.30 Kg

Bearing



Cage Type	EJ
C1 Dynamic Load Rating	238
C0 Static Load Rating	241
Max Oil Speed	5500
Max Grease Speed	4600

Dimensions



Shaft Diameter da	50 mm
Shaft Diameter db	60 mm
A	105.00 mm
A1	70 mm
A2	117 mm
G	M16
H	134 mm
H1	70.0 mm
H2	30 mm
Jmax	215 mm
Jmin	205 mm
J	210.00 mm
L	255 mm
N1	24.00 mm
N	18 mm

Specifications

UPC Code	9999999999
Alternate Part Name	SNT512-610 - 22310 - LO310

¹ Two seals are required for a thru shaft application. One end cover can be used if application is not a thru shaft design. In this case, only one seal is required.

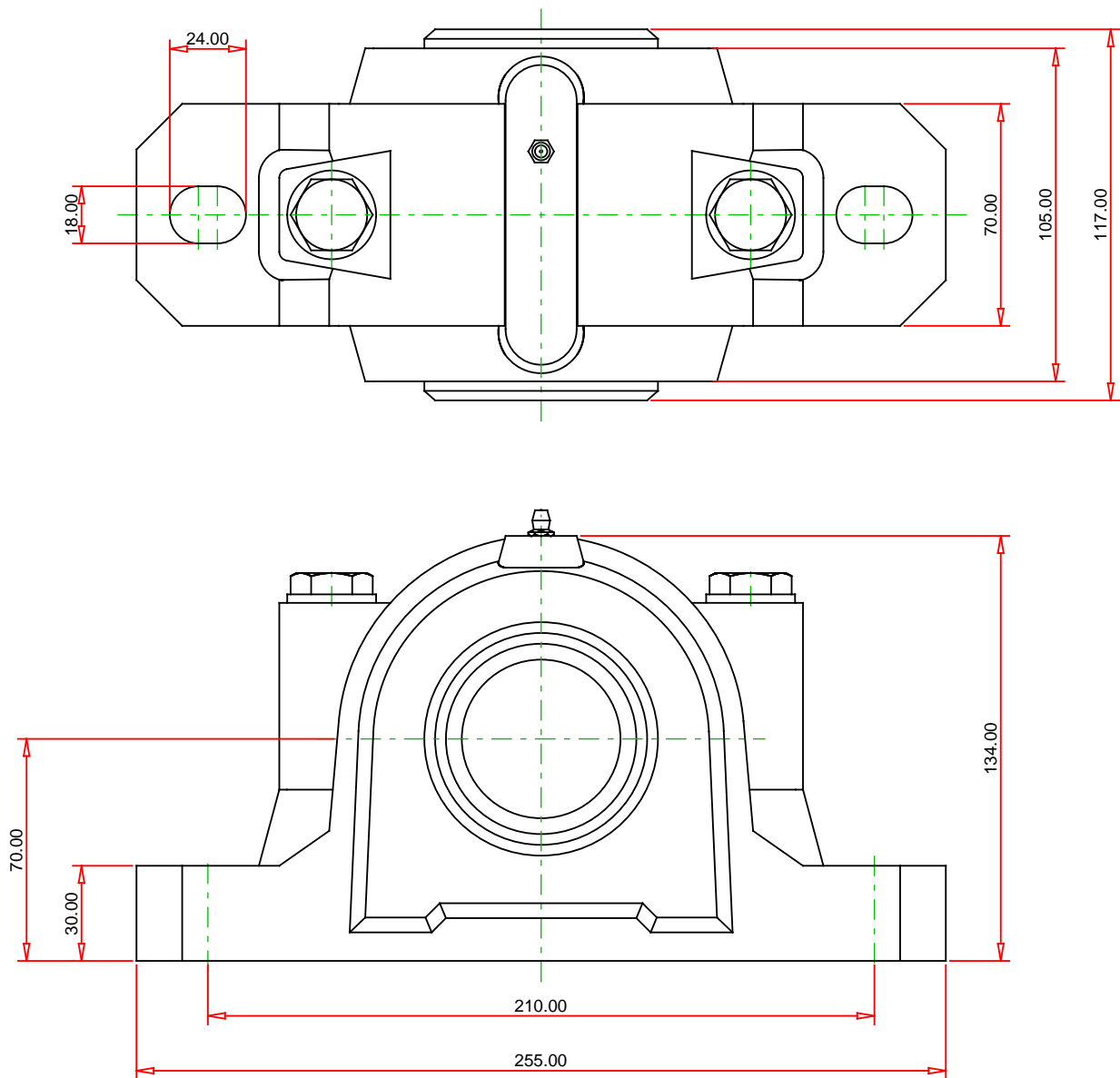

Note: Section View not to Scale

METRIC UNITS

Housing SNT 512-610
Bearing 22310
Seal (Quantity 2) LO310
Seal Type Labyrinth
Locating Ring (Quantity 2) SR110X4

TIMKEN®

THE TIMKEN COMPANY
NORTH CANTON, OHIO USA

SNT 512-610 - 22310 - LO310
SNT Cylindrical Bore Plummer Block Housed Units

C1 Dynamic Load Rating (2 rows)	238 kN
C0 Static Load Rating	241 kN
Max Oil Speed	5500 RPM
Max Grease Speed	4600 RPM
Material	Cast Iron

Every reasonable effort has been made to ensure the accuracy of the information contained in this writing, but no liability is accepted for errors, omissions or for any other reason.

FOR DISCUSSION ONLY