



LOCKNUT-SOCKET-KM8 [🔗](#)

Locknut socket wrench

for locknuts and precision locknuts

Technical information

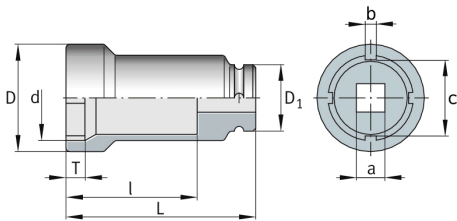

Dimensions

d	58.6 mm	
D	68 mm	
D ₁	30 mm	
L	82 mm	
l	58 mm	
T	9 mm	
a	1/2"	Square (inch)
b	5.7 mm	
c	53.8 mm	
≈m	0.61 kg	Weight

Additional information

KM8	suitable for locknuts
ZMA25/58, ZMA35/58, ZM40	suitable for precision locknuts
1 pc. socket wrench with locking pin and rubber washer	included in delivery