



**The Timken Company**

4500 Mt Pleasant St. NW

N. Canton, OH 44720

**Phone:** (234) 262-3000

**E-Mail:** [CustomerCAD@timken.com](mailto:CustomerCAD@timken.com) • **Web site:** [www.timken.com](http://www.timken.com)

## Part Number UC213, UC 200 Wide Inner Ring Ball Bearings - Set Screw Locking

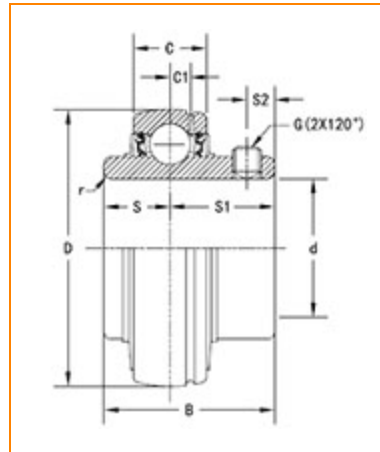

[Specifications](#) | [Dimensions](#) | [Basic Load Ratings](#)

### Specifications

<b>Bore Type</b>	Cylindrical bore
<b>Bearing Type</b>	Ball Bearing
<b>Shaft Size d</b>	65 mm
<b>Locking Device</b>	Set Screw Locking

### Dimensions

<b>Outside Diameter D</b>	120.000 mm 4.724 in
<b>Outside Ring Width C</b>	28.0 mm 1.102 in
<b>Radius r</b>	1.5 mm 0.059 in



<b>Groove Position C1</b>	7.5 mm 0.295 in
<b>Center of Bearing from End S</b>	25.4 mm 1 in
<b>Dimension S1</b>	39.7 mm 1.563 in
<b>Set Screw Distance S2</b>	12 mm 0.472 in
<b>Set Screw Size</b>	M12×1.5
<b>Number of Set Screws</b>	2
<b>Angle between Set Screws</b>	120 °

## Basic Load Ratings

<b>Static Load Rating</b>	40100 N 9015 lbf
<b>Dynamic Load Rating</b>	57200 N 12859 lbf

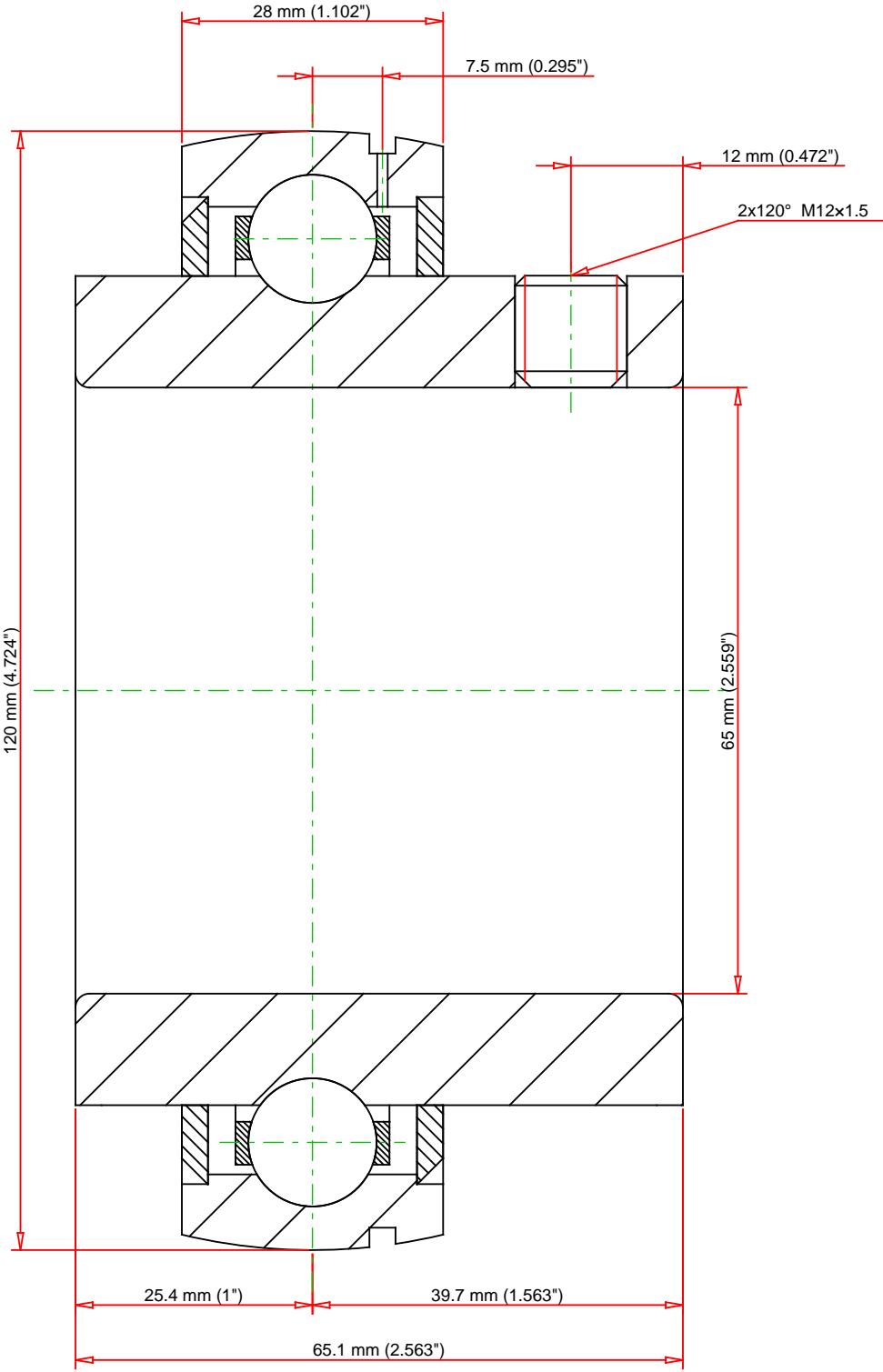

Weight	4.3 lb	1.9 kg	<div>TIMKEN®</div> <div>THE TIMKEN COMPANY</div> <div>NORTH CANTON, OHIO USA</div>			UC213		
						UC 200 Wide Inner Ring Ball Bearings - Set Screw Locking		
			Basic Load Ratings - C <sub>r</sub>		12859 lbf	57200 N		
			Load Ratings - C <sub>0r</sub>		9015 lbf	40100 N		
Every reasonable effort has been made to ensure the accuracy of the information contained in this writing, but no liability is accepted for errors, omissions or for any other reason.						FOR DISCUSSION ONLY		