

## How to Order

### Analog Input/Output Unit

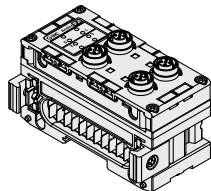

## EX600-AM B

Analog input/output

Number of input/output channels and connector

Symbol	Number of input channels	Number of output channels	Connector
<b>B</b>	2 channels	2 channels	M12 connector (5 pins) 4 pcs.

### IO-Link Unit

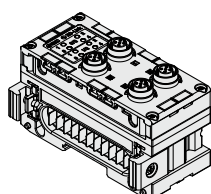

## EX600-L A B 1

Port specification

Symbol	Description
<b>A</b>	Port class A
<b>B</b>	Port class B

Number of ports and connector

Symbol	Number of ports	Connector
<b>B</b>	4 ports	M12 connector (5 pins) 4 pcs.

### Caution

The compatible SI unit models are as shown below. (Refer to the **Web Catalog**.)  
 EtherNet/IP™: EX600-SEN7/8  
 PROFINET: EX600-SPN3/4/31  
 EtherCAT: EX600-SEC3/4

### Terminal Unit (IO-Link device)

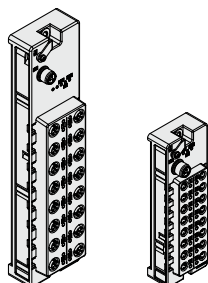

## EX600-T DX 1

Terminal unit  
(IO-Link device)

Digital input

Individual specifications (Number of inputs, connectors, etc.)

Symbol	Number of inputs	Connector
<b>1</b>	32 inputs	M12 connector (4 pins) 16 pcs.
<b>2</b>	16 inputs	M8 connector (3 pins) 16 pcs.

### End Plate (D side)

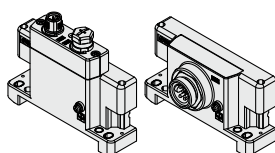

For M12 For 7/8 inch

## EX600-ED 2-2

End plate

End plate mounting position: D side

Power supply connector

Symbol	Power supply connector	Specifications
<b>2</b>	M12 (5 pins) B-coded	IN
<b>3</b>	7/8 inch (5 pins)	IN
<b>4</b>	M12 (4/5 pins) A-coded*1	IN/OUT
<b>5</b>	M12 (4/5 pins) A-coded*1	IN/OUT

\*1 The pin layout for the "4" and "5" pin connectors is different.  
 Refer to the dimensions on page 27.

Mounting method

Symbol	Description	Note
<b>Nil</b>	Without DIN rail mounting bracket	—
<b>2</b>	With DIN rail mounting bracket	For SV, S0700, and VQC series
<b>3</b>	With DIN rail mounting bracket	For SY, JSY, and ZK2□A series

\* When the end plate (U side) is used, the symbol for the mounting method must be the same as the D side.

EX600-ED4/5 are not yet UL-compliant.

### Handheld Terminal

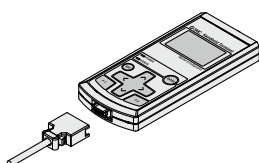

## EX600-HT1A-3

Version

Cable length

Symbol	Description
<b>Nil</b>	No cable
<b>1</b>	1 m
<b>3</b>	3 m

Handheld terminals are not yet UL-compliant.

# EX600 Series

## Specifications

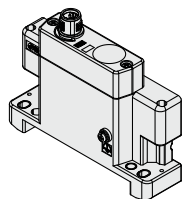

EX600-ED2-□

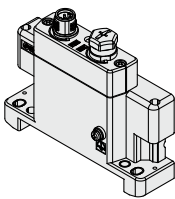

EX600-ED4/5-□

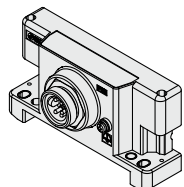

EX600-ED3-□

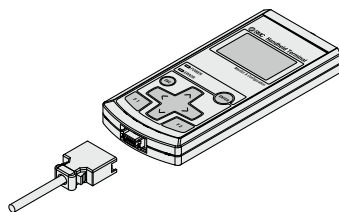

EX600-HT1A-□

### End Plate

Model			EX600-ED2-□	EX600-ED3-□	EX600-ED4/5-□
Power specifications	Power supply connector	PWR IN	M12 (5-pin) plug	7/8 inch (5-pin) plug	M12 (4-pin) plug
		PWR OUT	—	—	M12 (5-pin) socket
	Rated voltage	Power supply for control/input	24 VDC ±10%		
		Power supply for output	24 VDC +10/−5%		
	Rated current	Power supply for control/input	Max. 2 A	Max. 8 A	Max. 4 A
		Power supply for output			
Enclosure			IP67 (Manifold assembly)		
Standards*1			CE/UKCA marking, UL (CSA)		
Weight			170 g	175 g	170 g

\*1 The EX600-ED4/5-□ is not compliant with UL (CSA) standards.

### Handheld Terminal

Model	EX600-HT1A-□
Power supply	Power supplied from SI unit connector (24 VDC)
Current consumption	50 mA or less
Display	LCD with backlight
Connection cable	Handheld terminal cable (1 m ... EX600-AC010-1, 3 m ... EX600-AC030-1)
Enclosure	IP20
Standards*1	CE/UKCA marking
Weight	160 g

\*1 The handheld terminal is not compliant with UL (CSA) standards.

\* Cannot be used with the EX600-SEN7/8, EX600-SPN3/4/31, EX600-SEC3/4, and EX600-L□B1