



The Timken Company

4500 Mt Pleasant St. NW

N. Canton, OH 44720

Phone: (234) 262-3000

E-Mail: CustomerCAD@timken.com • **Web site:** www.timken.com

Part Number UC201, UC 200 Wide Inner Ring Ball Bearings - Set Screw Locking

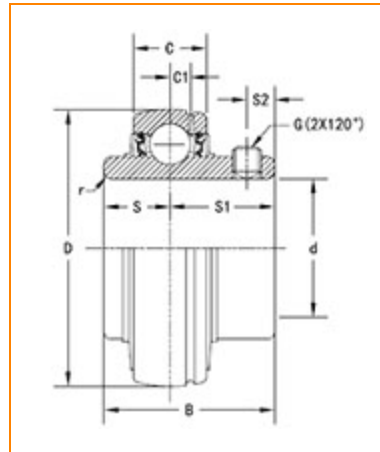

[Specifications](#) | [Dimensions](#) | [Basic Load Ratings](#)

Specifications

Bore Type	Cylindrical bore
Bearing Type	Ball Bearing
Shaft Size d	12 mm
Locking Device	Set Screw Locking

Dimensions

Outside Diameter D	47.000 mm 1.850 in
Outside Ring Width C	16 mm 0.630 in
Radius r	0.6 mm 0.024 in



Groove Position C1	3.9 mm 0.153 in
Center of Bearing from End S	12.7 mm 0.5 in
Dimension S1	18.3 mm 0.720 in
Set Screw Distance S2	5 mm 0.197 in
Set Screw Size	M6×0.75
Number of Set Screws	2
Angle between Set Screws	120 °

Basic Load Ratings

Static Load Rating	6650 N 1495 lbf
Dynamic Load Rating	12800 N 2878 lbf

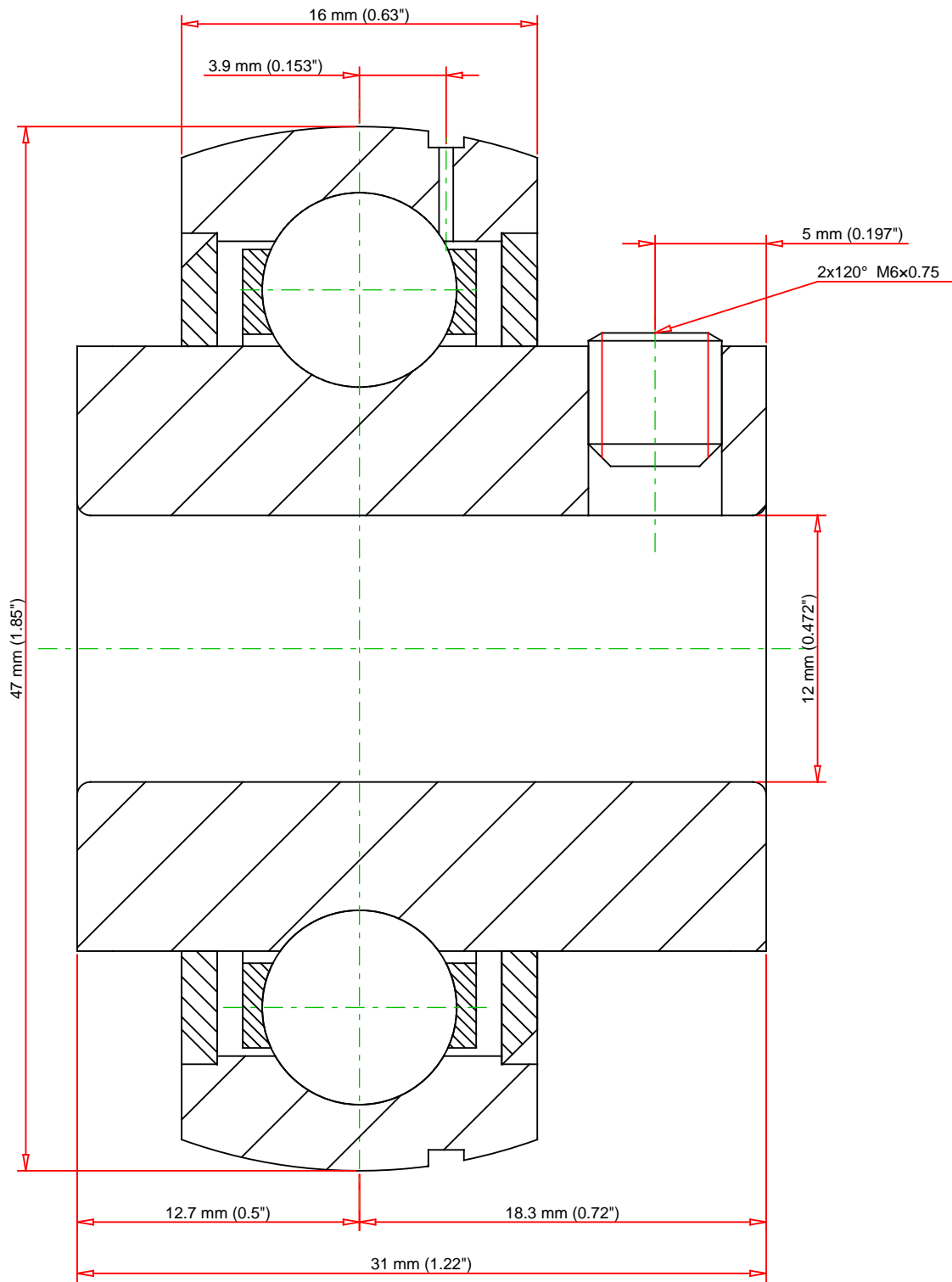

Weight	0.5 lb	0.2 kg	<div>TIMKEN®</div> <div>THE TIMKEN COMPANY</div> <div>NORTH CANTON, OHIO USA</div>	UC201		
				UC 200 Wide Inner Ring Ball Bearings - Set Screw Locking		
			Basic Load Ratings - C _r		2878 lbf	12800 N
			Load Ratings - C _{0r}		1495 lbf	6650 N
Every reasonable effort has been made to ensure the accuracy of the information contained in this writing, but no liability is accepted for errors, omissions or for any other reason.				FOR DISCUSSION ONLY		