



The Timken Company

4500 Mt Pleasant St. NW

N. Canton, OH 44720

Phone: (234) 262-3000

E-Mail: CustomerCAD@timken.com • **Web site:** www.timken.com

Bearing Unit - Adapter Sleeve UKP218 - H2318, UKP 200 Pillow Block Mounted Bearings - Adapter Sleeve Locking

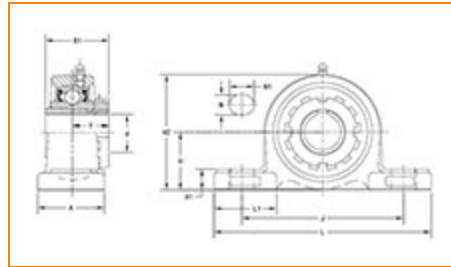

[Specifications](#) | [Dimensions](#) | [Basic Load Ratings](#)

Specifications

Bearing Unit - Adapter Sleeve	UK218 - H2318
Shaft Size d	80 mm
Adapter Sleeve Number¹	H2318
Locking Style	Adapter Sleeve Locking
Housing Construction	Two-Bolt Pillow Block

Dimensions

Base to Center Height H	101.6 mm 4 in
Total Length L	327 mm 12.874 in
 Housing Width A	88 mm 3.465 in

Bolt Hole Spacing J	262 mm 10.315 in
Bolt Hole Size N	27 mm 1.063 in
Bolt Hole Length N1	45 mm 1.772 in
Foot Height H1	33 mm
Total Height H2	198 mm 7.795 in
Dimension L1	94 mm 3.688 in
Center of Bearing from End Y	49.5 mm 1.949 in
Dimension B1	86 mm 3.386 in

Basic Load Ratings

Static Load Rating	71500 N 16074 lbf
Dynamic Load Rating	96100 N 21604 lbf

¹ Purchase the Adapter Sleeve separately

