



**The Timken Company**

4500 Mt Pleasant St. NW

N. Canton, OH 44720

**Phone:** (234) 262-3000

**E-Mail:** [CustomerCAD@timken.com](mailto:CustomerCAD@timken.com) • **Web site:** [www.timken.com](http://www.timken.com)

## Part Number UCFL308, UCFL 300 Two-Bolt Flanged Mounted Bearings - Set Screw Locking

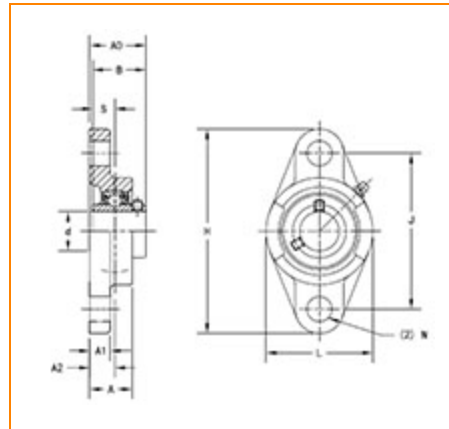

[Specifications](#) | [Dimensions](#) | [Basic Load Ratings](#)

### Specifications

<b>Bearing Number</b>	UC308
<b>Shaft Size d</b>	40 mm
<b>Locking Style</b>	Set Screw Locking
<b>Housing Construction</b>	Two-Bolt Flange

### Dimensions

<b>Total Length H</b>	200 mm 7.875 in
<b>Total Height L</b>	112 mm 4.406 in



**Housing Width A** 40 mm  
1.563 in

**Bolt Hole Spacing J** 158 mm  
6.22 in

**Bolt Hole Size N** 23 mm  
0.906 in

**Flange Thickness A1** 17 mm  
0.669 in

**Center of Bearing from Housing End A2** 23 mm  
0.906 in

**Inner Ring Width B** 52 mm  
2.047 in

**Center of Bearing from Bearing End S** 19 mm  
0.748 in

**Dimension A0** 56 mm  
2.203 in

**Bolt Size** M20

## Basic Load Ratings

**Static Load Rating** 24000 N  
5395 lbf

**Dynamic Load Rating** 40700 N  
9150 lbf

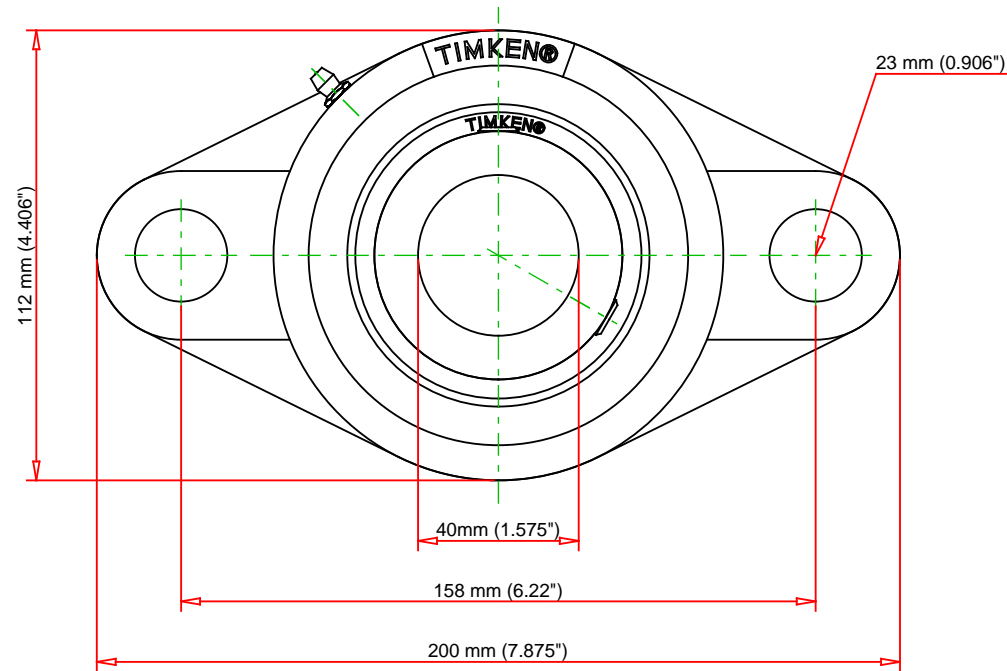
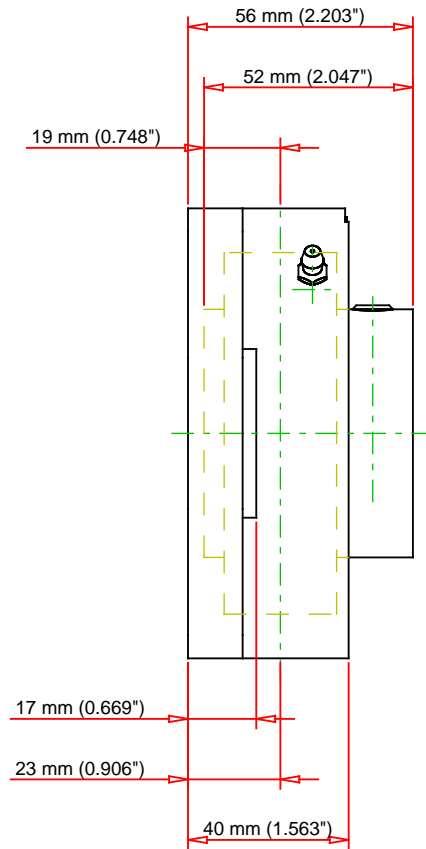

Bearing Number	UC308			
Load Ratings - C <sub>r</sub>	9150	lbf	40700	N
Load Ratings - C <sub>0r</sub>	5395	lbf	24000	N
Weight	5.5	lb	2.5	kg
Bolt Size	M20			

**TIMKEN**

THE TIMKEN COMPANY  
NORTH CANTON, OHIO USA

**UCFL308**  
UCFL 300 Two-Bolt Flanged Mounted  
Bearings - Set Screw Locking

Every reasonable effort has been made to ensure the accuracy of the information contained in this writing, but no liability is accepted for errors, omissions or for any other reason.

**FOR DISCUSSION ONLY**