

KWVE25-B-SL

Recirculating ball bearing carriage

Carriages KWVE...-B-SL, narrow, long carriage, four-row

Technical information

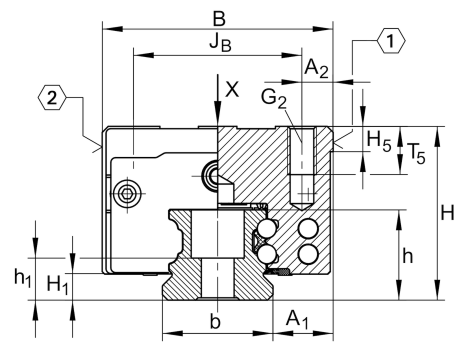

Main Dimensions & Performance Data

| | | |
|-----------------|----------|-----------------------------------|
| H | 36 mm | height system |
| B | 48 mm | width carriage |
| L | 109.1 mm | overall length carriage |
| C | 23,400 N | dynamic load rating |
| C ₀ | 54,000 N | static load rating |
| M _{0x} | 745 Nm | static moment rating about X axis |
| M _{0y} | 825 Nm | static moment rating about Y axis |
| M _{0z} | 825 Nm | static moment rating about Z axis |
| ≈m | 1 kg | Weight |

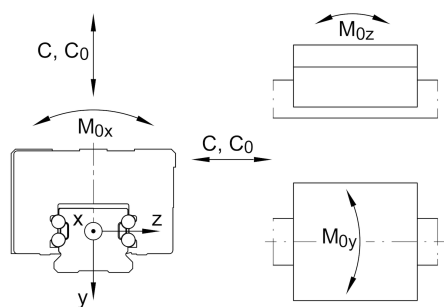
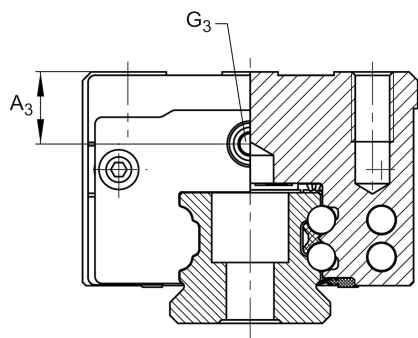
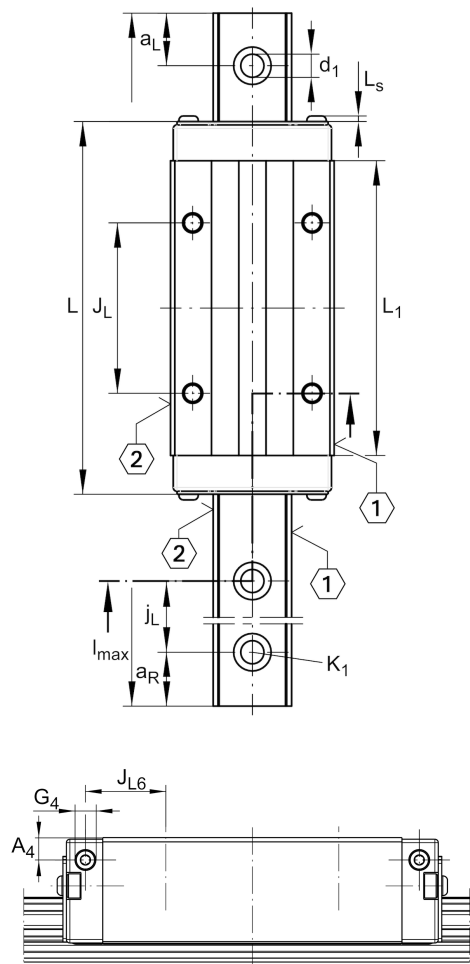

Mounting dimensions

| | | |
|-------------------|---------|---|
| A ₁ | 12.5 mm | |
| J _B | 35 mm | |
| b | 23 mm | width rail |
| A ₂ | 6.5 mm | |
| L ₁ | 86.5 mm | |
| L _S | 1.65 mm | |
| J _L | 50 mm | |
| H ₁ | 5.1 mm | |
| H ₅ | 5.25 mm | |
| T ₅ | 10 mm | |
| G ₂ | M6 | fixing screws above (DIN ISO 4762-12.9) |
| G2 M _A | 17 Nm | maximum tightening torque |
| A ₃ | 11 mm | position lubrication connector |
| G ₃ | M6 | lubrication connector |
| t G ₃ | 7 mm | maximum permissible screw depth for lubrication connectors |
| A ₄ | 6.5 mm | position lubrication connector |
| G ₄ | M6 mm | lubrication connector |
| t G ₄ | 7 mm | maximum permissible screw depth for lubrication connectors |
| J _{L6} | 23.3 mm | position lubrication connector |

Additional information

| | | |
|----------|------|---------------|
| VMKB 065 | KWVE | Material name |
|----------|------|---------------|

The datasheet is only an overview of dimensions and basic load ratings of the selected product. Please always observe all further information and guidelines for this product. For further information you can use the contact form on our website.

