



FAG

SES516-613-L

Plummer block housing

Schaeffler ID:  
0860885560000

Split plummer block housing for various bearing designs. The SNV series will be replaced by the new SES series in 2022.

Technical information

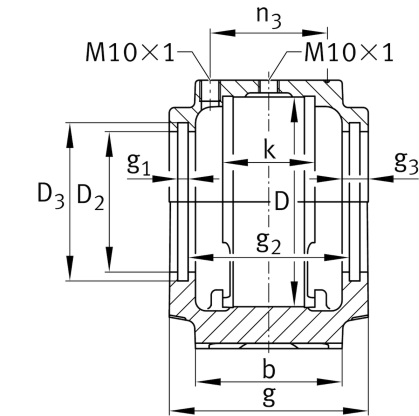
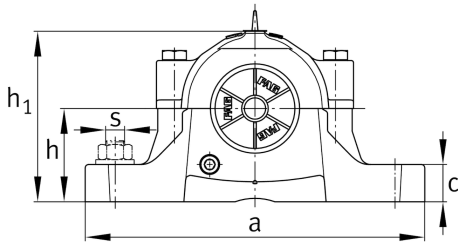
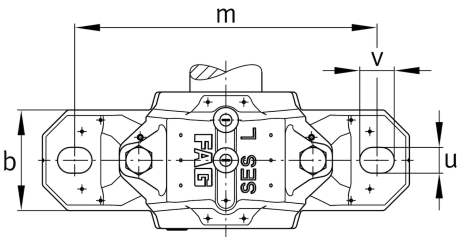

Main Dimensions & Performance Data

D	140 mm	outside diameter bearing
a	315 mm	length base
h <sub>1</sub>	177 mm	height
g	120 mm	width housing body
K	58 mm	Width bearing seat
	9.3 kg	Weight

Dimensions

b	90 mm	width base
c	32 mm	height base
h	95 mm	center height
m	260 mm	distance fixing bore
s	0.75	screw size
s	M20	size of fixing screws
u	22 mm	width slot
v	28 mm	length slot
D <sub>2</sub>	92.5 mm	diameter sealing
D <sub>3</sub>	101 mm	diameter sealing groove
D <sub>5</sub>	98.7 mm	Outside diameter sealing labyrinth
g <sub>1</sub>	5 mm	Width sealing groove
g <sub>2</sub>	102 mm	Distance sealing
g <sub>3</sub>	13 mm	Wall thickness
g <sub>4</sub>	36 mm	Distance oil lubrication
m <sub>1</sub>	218 mm	Distance holes aligned pins m1
n <sub>3</sub>	77 mm	Distance lubrication
n <sub>4</sub>	106 mm	Distance lubrication sealing
u <sub>1</sub>	8 mm	bore diameter u1
u <sub>2</sub>	18 mm	bore diameter u2