



**The Timken Company**  
 4500 Mt Pleasant St. NW  
 N. Canton, OH 44720  
**Phone:** (234) 262-3000  
**E-Mail:** [CustomerCAD@timken.com](mailto:CustomerCAD@timken.com) • **Web site:** [www.timken.com](http://www.timken.com)

## Part Number QF175 Assembly W/VSP&White, Standard Coupling with High-Speed Split Cover

### Standard Coupling with High-Speed Split Cover



### [Specifications](#) | [Dimensions](#)

#### Specifications

<b>Pilot-Bore Diameter</b>	1
<b>Maximum Bore Size - Standard Keyway</b>	95 mm 3 7/8 in
<b>Max. RPM</b>	4200 rpm
<b>Insert Color</b>	White
<b>Continuous Torque</b>	6656 N·m 58903 in·lb
<b>Weight</b>	29.5 Kg 65.00 lb

#### Dimensions

107.0 mm

<b>A</b>	177.8 mm 7.78 in
<b>C</b>	96.2 mm 3.78 in
<b>D1</b>	250.2 mm 9.85 in
<b>D2</b>	139.7 mm 5.50 in
<b>D3</b>	171.5 mm 6.75 in
<b>F</b>	67.8 mm 2.67 in
<b>G Min</b>	6.43 mm 0.253 in
<b>G Max</b>	7.98 mm 0.314 in
<b>H</b>	95.3 mm 3.75 in
<b>L1</b>	50.8 mm 2.00 in
<b>P</b>	114.3 mm 4.50 in
<b>X</b>	62.2 mm 2.45 in

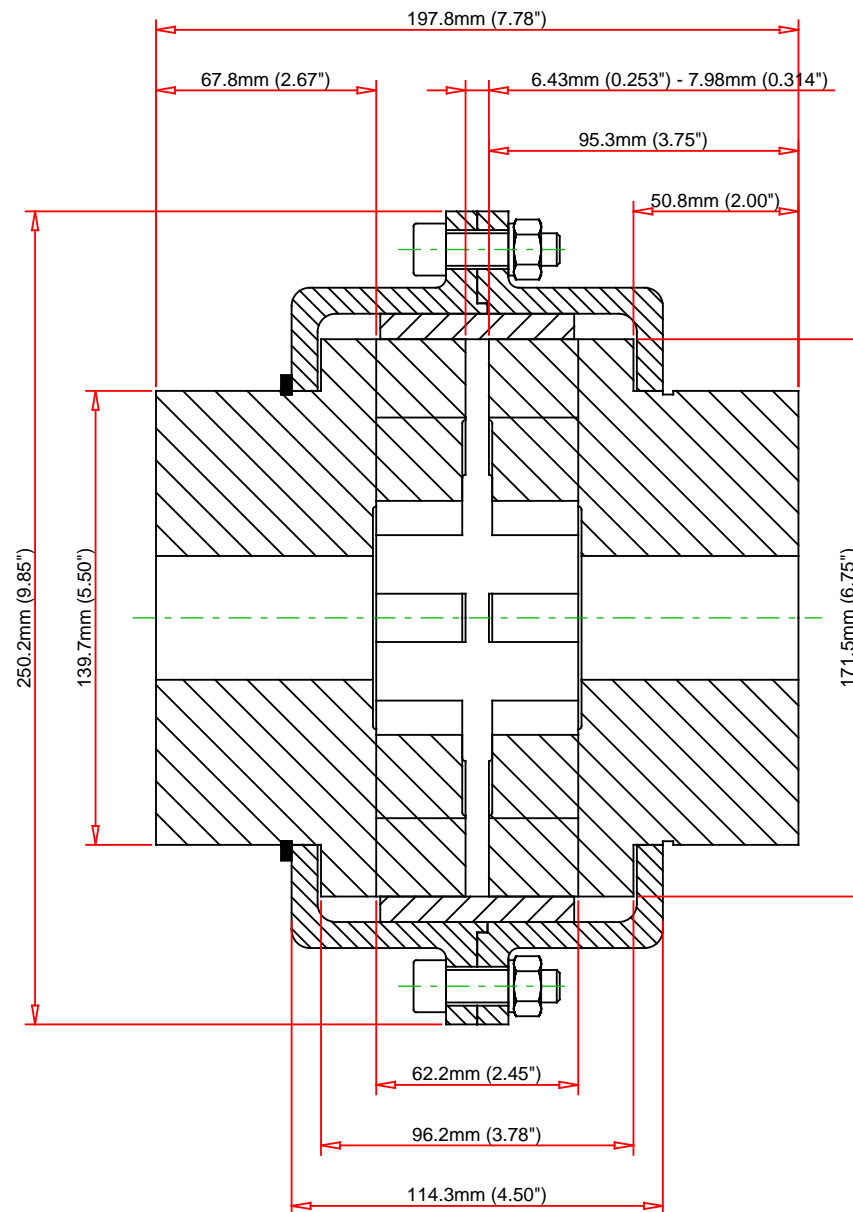

Note: Stated weight includes complete coupling with pilot bores

	Max. RPM	4200			<div>TIMKEN</div>	<div>QF175 Assembly</div> <div>Standard Coupling with High-Speed Split Cover</div>
	Continuous Torque	6656	Nm	58903		
	Weight	29.5	kg	65		
					<div>THE TIMKEN COMPANY</div> <div>NORTH CANTON, OHIO USA</div>	
Every reasonable effort has been made to ensure the accuracy of the information contained in this writing, but no liability is accepted for errors, omissions or for any other reason.						<div>FOR DISCUSSION ONLY</div>