



NTN BEARING CORPORATION OF AMERICA

Head Office

1600 E. Bishop Court, P.O. Box 7604

Mount Prospect, IL 60056-7604, U.S.A.

Phone: 847-298-7500

Fax: 847-699-9744

Toll Free: 800-323-2358

Email: mkt@ntnamerica.com

Website: www.ntnamericas.com

Item # UELP210D1, Pillow Block Unit, Cast Housing, Eccentric Locking Collar, UELP/UELPL Type

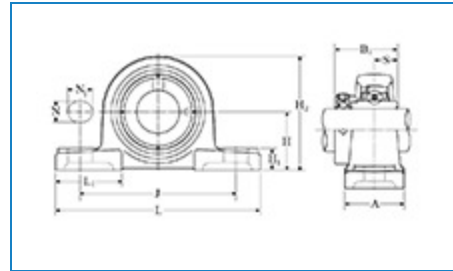

[Order Now](#) | [Technical Specifications](#) | [Dimensional Specifications](#)

Order Now

Ordering Options

[Order Online through NTN DOL](#)
[Contact NTN Customer Relations](#)
[Search for a Licensed Distributor](#)

Technical Specifications

Type	Pillow Block Unit
Bearing Type	Ball Bearing
Locking Device	Eccentric Locking Collar
Seal Type	Contact
Seal Material	Nitrile Rubber

Bearing Number	UEL210D1
Housing Number	P210D1
Housing Material	Cast Iron
Housing Construction	1 Piece
End Type	Open
Performance	Light Duty
Dynamic Load Rating	7850 lbf 35000 N 35.00 kN
Static Load Rating	5200 lbf 23200 N 23.20 kN
Rotational Speed [Max]	3100 RPM
Weight	6.415 lb 2.910 kg
Operating Temperature Range	-40 to 250 °F -40 to 120 °C
Lubrication	Relubricatable

Dimensional Specifications

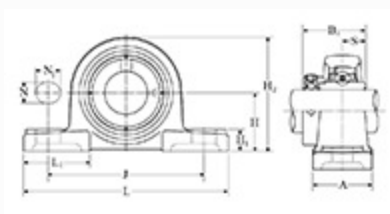

Pillow Block Unit, Cast Housing, Eccentric Locking Collar, UELP/UELPL Type - Dimensions

d	1.9685 in 50.000 mm
J	6.2500 in 159.0 mm

L	8.1250 in 206.0 mm
A	2.3750 in 60.0 mm
H	2.2500 in 57.2 mm
H1	0.8125 in 21.0 mm
H2	4.5000 in 114.0 mm
L1	2.5625 in 65.0 mm
N	0.7812 in 20.0 mm
N1	0.9062 in 23.0 mm
B1	2.4685 in 62.700 mm
S	0.9685 in 24.600 mm
F	0.2323 in 5.900 mm